



PROGRAMMING MANUAL

For Technical Service, contact Bunn-O-Matic Corporation at 1-800-286-6070.

Bunn-O-Matic Corporation
Post Office Box 3227, Springfield, Illinois 62708-3227
Phone (217) 529-6601 | Fax (217) 529-6644

BUNN-O-MATIC COMMERCIAL PRODUCT WARRANTY

Bunn-O-Matic Corporation ("BUNN") warrants the BUNN Sure Immersion system, further described below for ***a warranty period of 1 year parts and labor.***

These warranty periods run from the date of installation. BUNN warrants that the equipment manufactured by it will be commercially free of defects in material and workmanship existing at the time of manufacture and appearing within the applicable warranty period. This warranty does not apply to any equipment, component or part that was not manufactured by BUNN or that, in BUNN's judgment, has been affected by misuse, neglect, alteration, improper installation or operation, improper maintenance or repair, damage or casualty. This warranty is conditioned on the Buyer 1) giving BUNN prompt notice of any claim to be made under this warranty by telephone at (217) 529-6601 or by writing to Post Office Box 3227, Springfield, Illinois 62708-3227; 2) if requested by BUNN, shipping the defective equipment prepaid to an authorized BUNN service location; and 3) receiving prior authorization from BUNN that the defective equipment is under warranty. Additionally the following is excluded from the warranty period.

Warranty Exclusions:

Parts such as, but not limited to, hoppers and lids, drip trays, and plastic parts damaged due to improper handling or cleaning agents.

Replacement of wear items such as, but not limited to, O-rings, gaskets, tubes, brew box seal, hoses, and valve seats.

Repairs made necessary due to poor water quality, such as dispense valves, coils, water inlet valves, scaling in hot water boilers.

Improper voltage, (See equipment operations manual for voltage specifications)

Touch screen due to improper use or damage.

Failure to perform cleaning procedures constitutes improper maintenance.

Failure to have required preventive maintenance performed by a BUNN technician or an authorized BUNN service agent.

Parts replaced under the terms of this warranty carry the remainder of the machine's parts warranty term, or 60 days, whichever is greater.

THE FOREGOING WARRANTY IS EXCLUSIVE AND IS IN LIEU OF ANY OTHER WARRANTY, WRITTEN OR ORAL, EXPRESS OR IMPLIED, INCLUDING, BUT NOT LIMITED TO, ANY IMPLIED WARRANTY OF EITHER MERCHANTABILITY OR FITNESS FOR A PARTICULAR PURPOSE. The agents, dealers or employees of BUNN are not authorized to make modifications to this warranty or to make additional warranties that are binding on BUNN. Accordingly, statements by such individuals, whether oral or written, do not constitute warranties and should not be relied upon.

If BUNN determines in its sole discretion that the equipment does not conform to the warranty, BUNN, at its exclusive option while the equipment is under warranty, shall either 1) provide at no charge replacement parts and/or labor (during the applicable parts and labor warranty periods specified above) to repair the defective components, provided that this repair is done by a BUNN Authorized Service Representative; or 2) shall replace the equipment or refund the purchase price for the equipment.

THE BUYER'S REMEDY AGAINST BUNN FOR THE BREACH OF ANY OBLIGATION ARISING OUT OF THE SALE OF THIS EQUIPMENT, WHETHER DERIVED FROM WARRANTY OR OTHERWISE, SHALL BE LIMITED, AT BUNN'S SOLE OPTION AS SPECIFIED HEREIN, TO REPAIR, REPLACEMENT OR REFUND.

In no event shall BUNN be liable for any other damage or loss, including, but not limited to, lost profits, lost sales, loss of use of equipment, claims of Buyer's customers, cost of capital, cost of down time, cost of substitute equipment, facilities or services, or any other special, incidental or consequential damages.

CONTENTS

Warranty	2
Filling Coffee Bean Hoppers	4
Product and Recipe Setup	
Product Setup	5
Grinder Calibration	7
Recipe Setup	12
- Editing Coffee Recipes by Size	14
Enabling Products.....	16
Hopper Setup.....	17
Operating Interface	
User Interface	19
ADA Interface.....	21
Machine Settings	
Temperature	23
Bean Hopper	25
Grounds Bin	26
Hot and Ambient Water	26
BUNNlink	27
Energy Saver	27
Scheduler	27
Service Information	28
Factory Reset	28
Exporting Data Using USB	
Setup of Multiple Machines	29
Copying Settings from Machine to Machine	31
Importing Data Using USB	
Adding To Your Brand	33
Accessing Imported Images & Videos	37
TABS	
- Home Screen.....	38
- Size Selection Screen	41
- Ending Sequence	42
- Screen Saver	44
- Brew Video	45
- Add	46
- Import.....	46
- Export	48
- Reset	48
Reminders	
Cleaning	50
Preventive Maintenance.....	51
Water Filter.....	52

For additional information, refer to Installation and Operating Guide.



FILLING BEAN HOPPERS

If bean hoppers are already locked in place, go to Step 3.

1. Place an empty hopper in opening on top of machine.



2. When placed, push gate handle back.

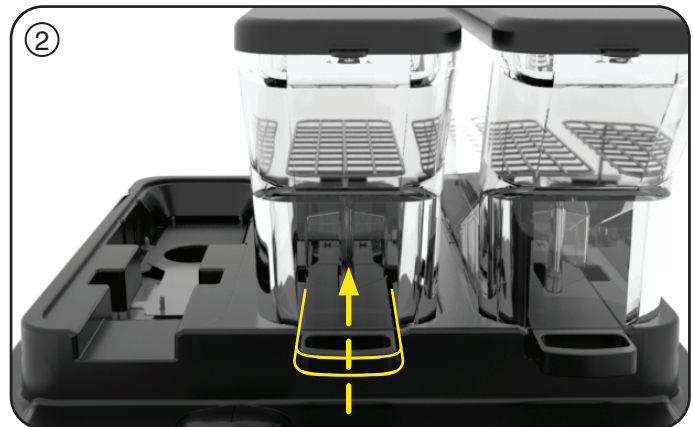

3. Remove lid(s).

4. Pour whole coffee beans in hopper(s).

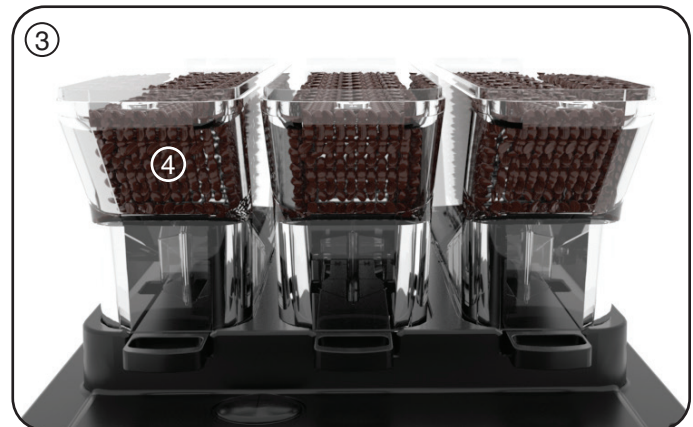

5. Once full, place lid back on top of hopper(s).



PRODUCT AND RECIPE SETUP

1. Touch and hold the **BUNN** logo for a few seconds until **SERVICE ACCESS** appears on the display.

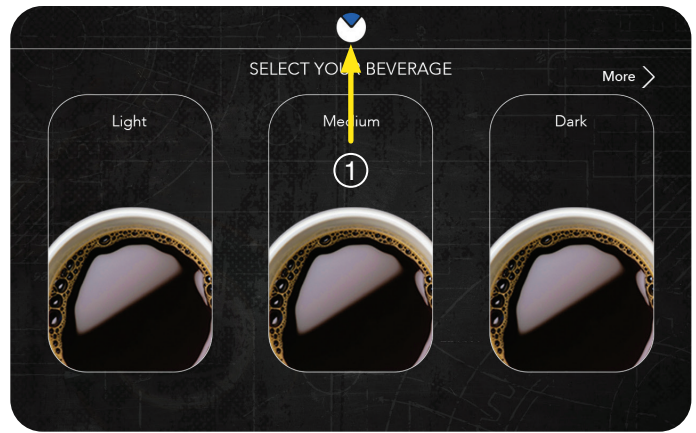

2. Select the **ADVANCED** icon.

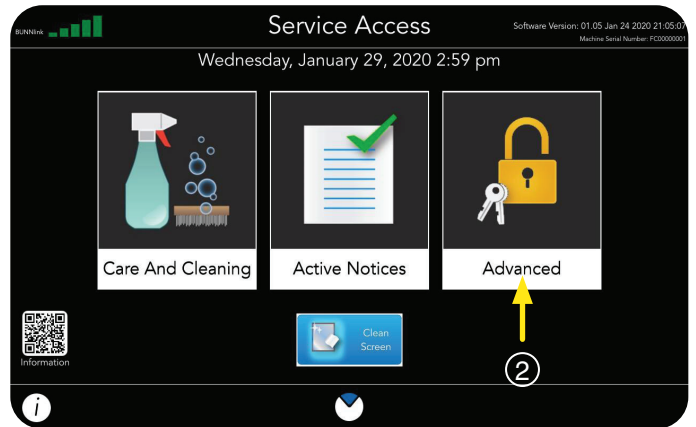

3. Next, enter the passcode **6601**.

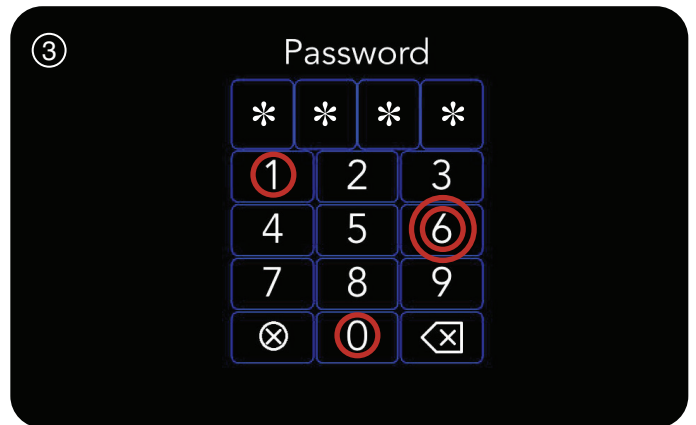

Product Setup

First we will setup a coffee **Product**.

1. Touch the **RECIPES** icon.

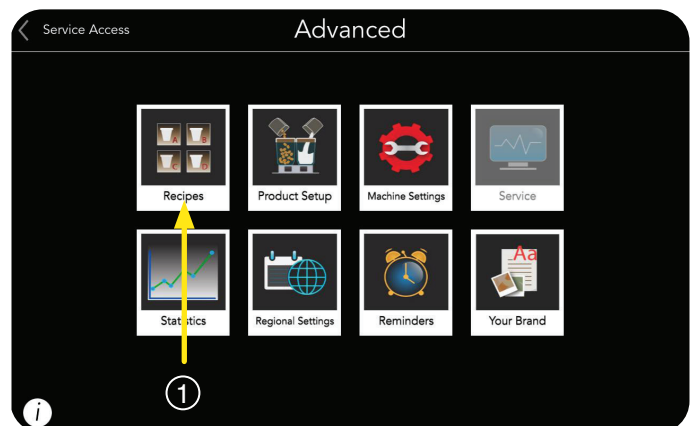

PRODUCT AND RECIPE SETUP

Product Setup (continued)

- Next, touch the **PRODUCTS** tab.
- Choose a product to edit.
- Or, create a **New** Product.

We will use the “Light Roast” as an example.

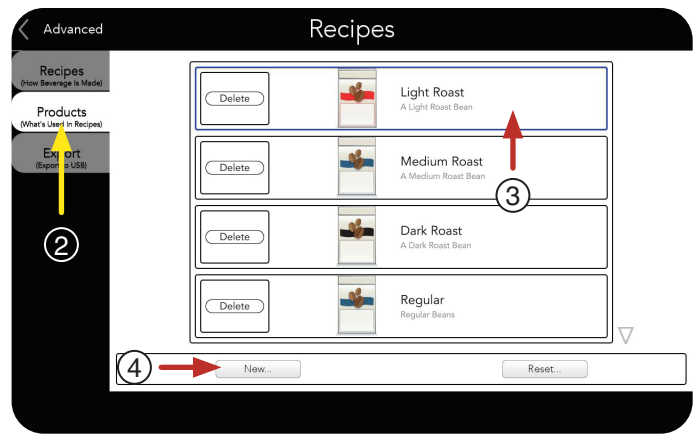

- Next, choose the **Product Name Line 1** field.

NOTE: There is a second field if you need more space to name your product.

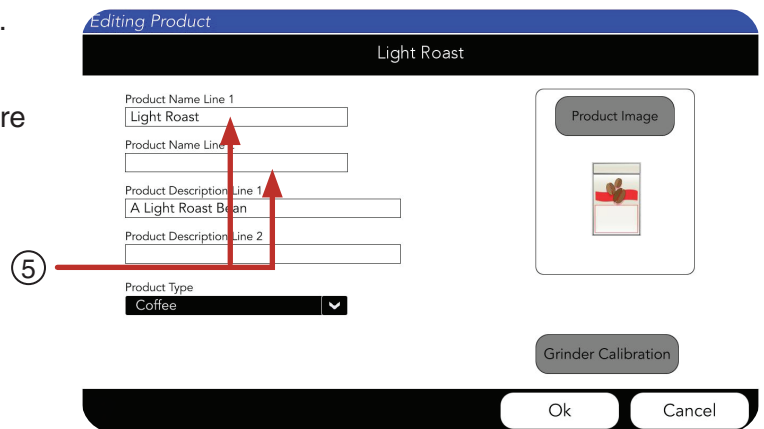

- Type the name of your coffee, for example “Regular”
- Press **Return**.

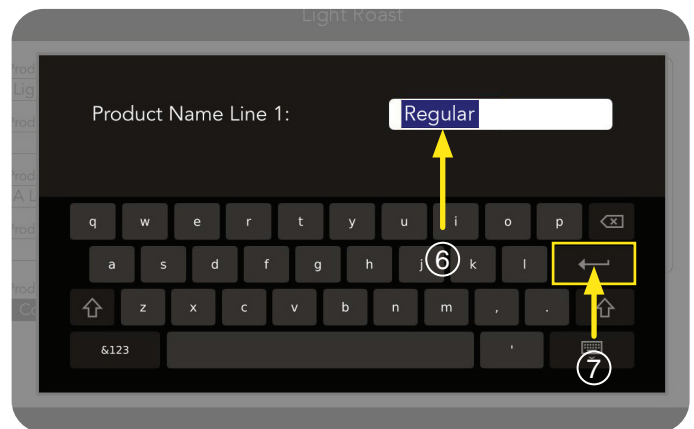

NOTE: The **Product Name Line 1** and **Product Description Line 1** have been updated for this example.

- Now, choose a **Product Image**, or use the existing badge.

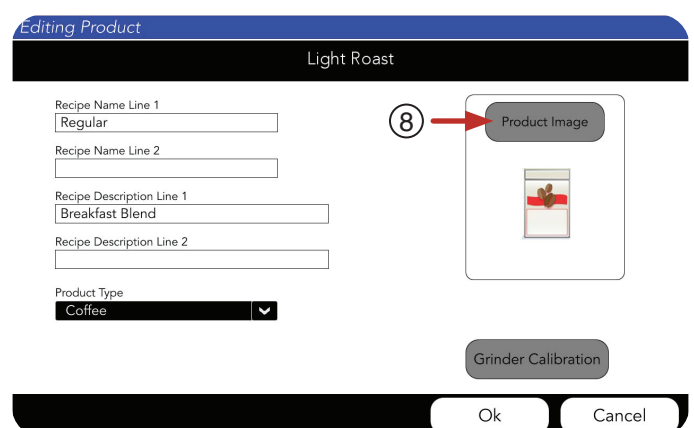

PRODUCT AND RECIPE SETUP

- Next, scroll **side-to-side** to see the available images.

Press the chosen **Product Image**.

- If a new image is chosen, press **OK**.

- Press **OK** to complete this **Product** creation.

- You can choose to edit or create new **Products**, or move on to creating or editing a coffee **Recipe** by pressing the **RECIPE** tab.

Grinder Calibration

- Select the **Grinder Calibration** button.

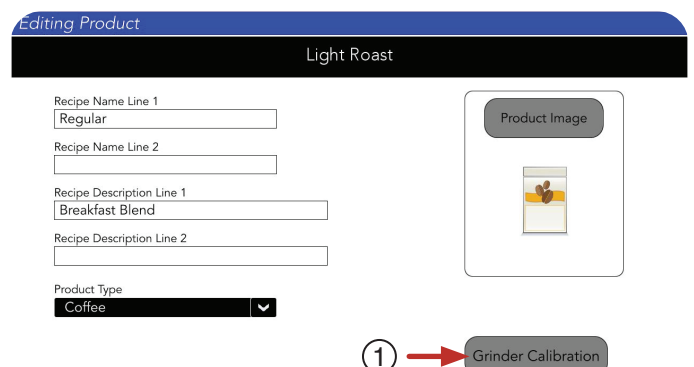
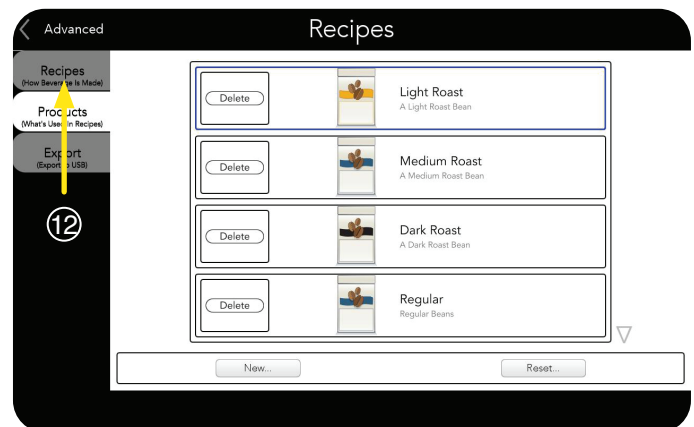
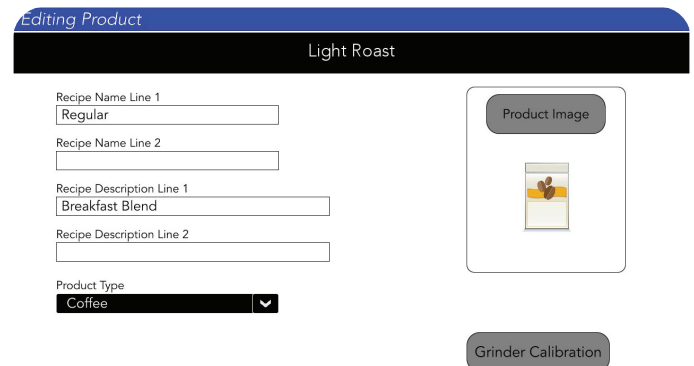
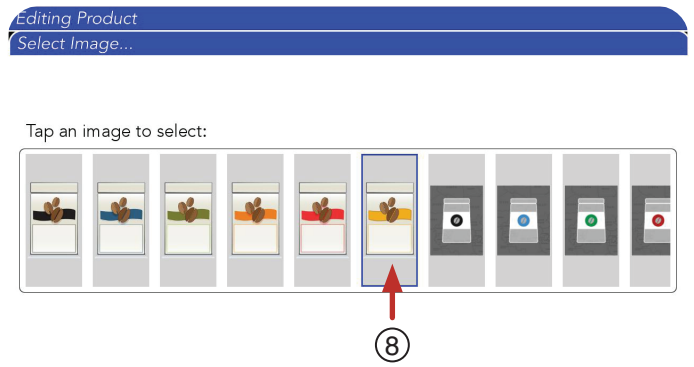

PRODUCT AND RECIPE SETUP

Grinder Calibration (continued)

2. Choose a **hopper** from the **tabs**.
The default is the left hopper.

NOTE: Choosing the hopper during calibration is simply telling the machine which grinder to turn on.

WARNING: All three hoppers must be locked in position before starting.

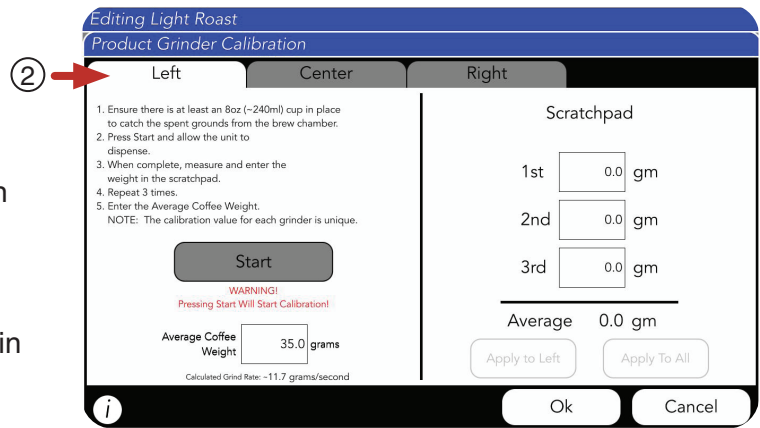

3. Next, press the **Start** button to prime the grinder with beans.

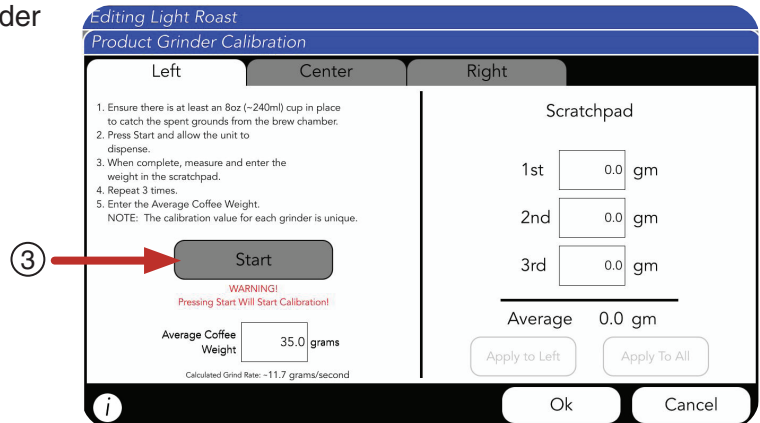

4. Follow on-screen prompts.



5. **Tare** (zero) receiving container (**Grounds Bin**) or cup on digital weigh scale.
 - a. Select Tare
 - b. Select grams.



PRODUCT AND RECIPE SETUP

It's time to **Calibrate** the grinder.

1. First, open the machine door.
2. Place a container, like the **Grounds Bin**, under the **Coffee Chute**.
3. Close door and return to **Calibration** screen.



Option 2

- a. Pull the **Service Switch** button so the door does not need to be closed completely.
- b. Hold an empty cup under the **Coffee Chute**.
- c. Return to **Calibration** screen.

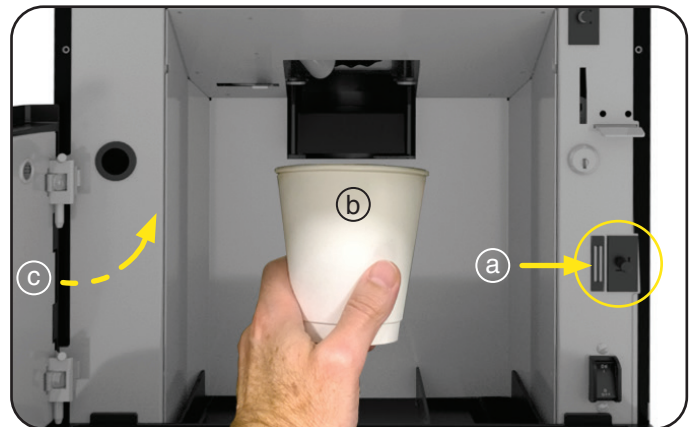

4. Press **Start** button.

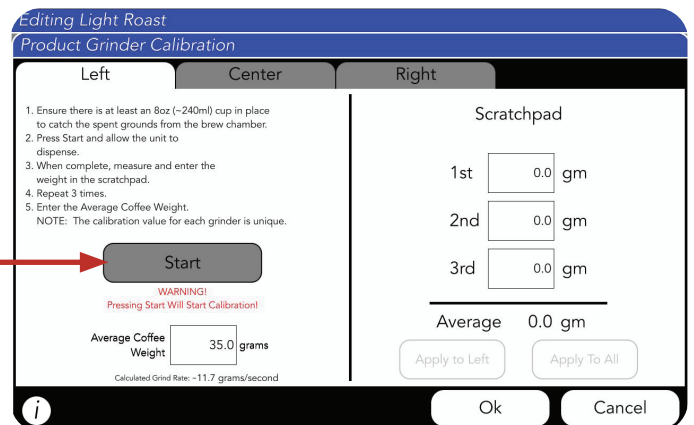

5. The **Calibration** screen will appear again when finished.

6. Take the cup or container out.



PRODUCT AND RECIPE SETUP

Grinder Calibration (continued)

7. Weigh cup.



8. Then, press the **1st Field** to log the weight of the coffee in the cup.

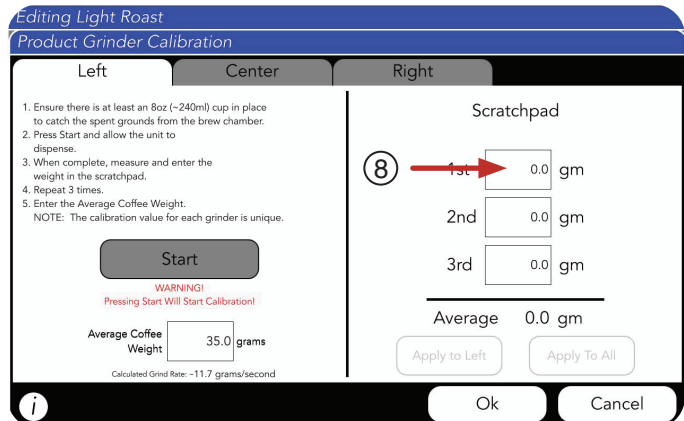

After pressing the 1st Field to log the weight of the coffee in the cup, the **Input Screen** will appear for you to input in these numbers.

9. Type the weight of the cup

10. Press **Enter**.

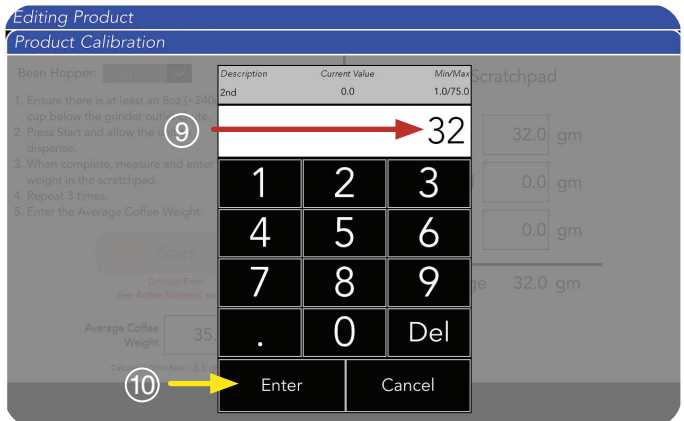

Empty the cup, then **repeat steps 1 - 10 two more times to fill in all 3 weight fields.**

1. Note the **Average Weight** of the three tests.

For this example it's 32.7 grams.

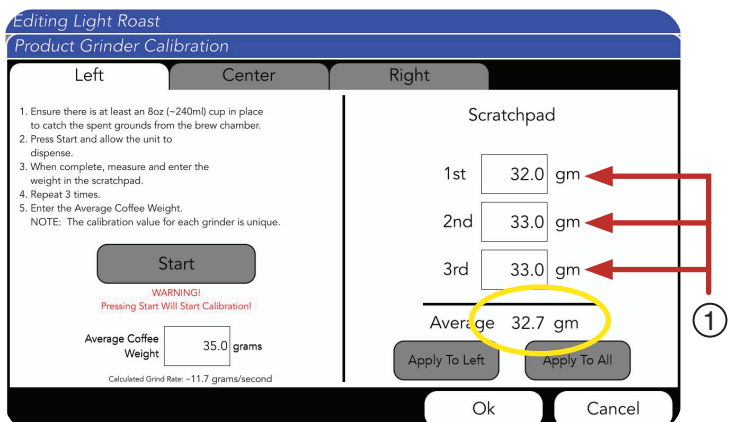

PRODUCT AND RECIPE SETUP

- Press on the **Average Coffee Weight** field to fill in this amount.

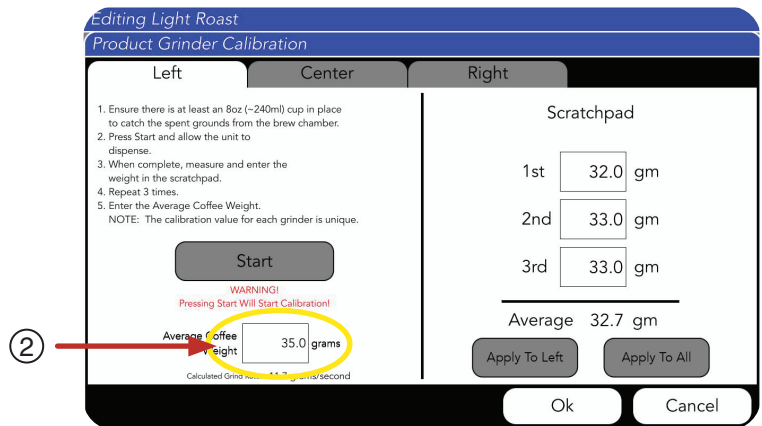

- The **input screen** will appear to type these numbers.

- Press **Enter**.

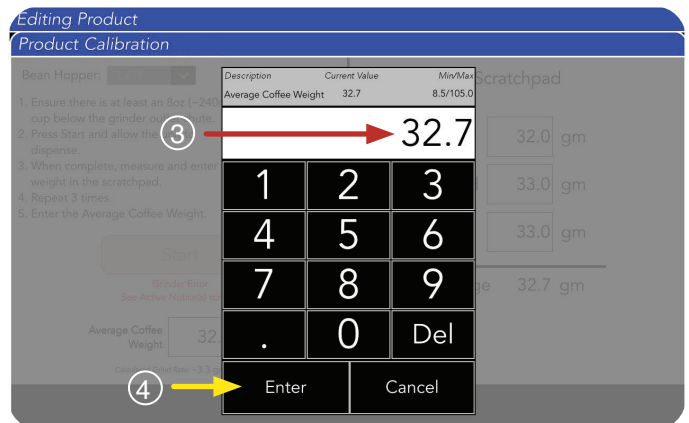

IMPORTANT: A grinder calibration for a specific product can be applied to the grinder selected (The **Left** grinder is the default), or applied to **All**.

If this step is completed and the **Apply to Left Center, or Right** button is selected, the recipe will need to be recalibrated if it's moved from the specified grinder to either of the other two grinders. Or, it can be applied to **All**.

- Choose to **Apply To Left** or **Apply To All**.
- Press **Save** to complete **Grinder Calibration**.

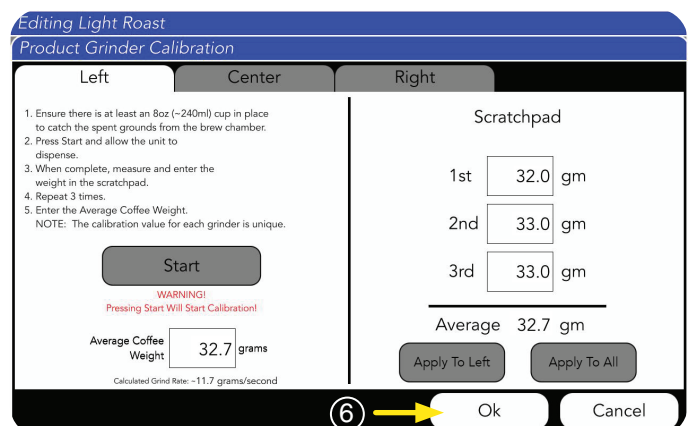
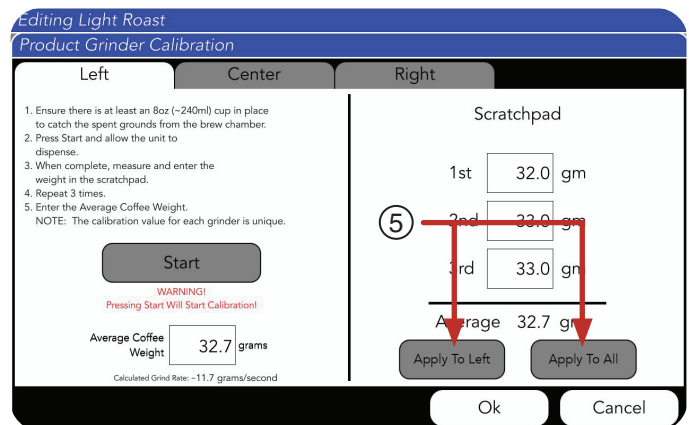

PRODUCT AND RECIPE SETUP

Grinder Calibration (continued)

7. Press **OK** to complete this **Product** creation.

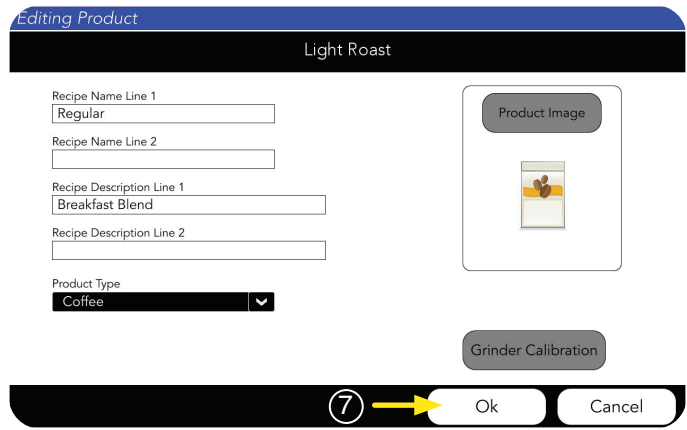

8. You can choose to edit or create new **Products**, or move on to creating or editing a coffee **Recipe** by pressing the **RECIPE** tab.

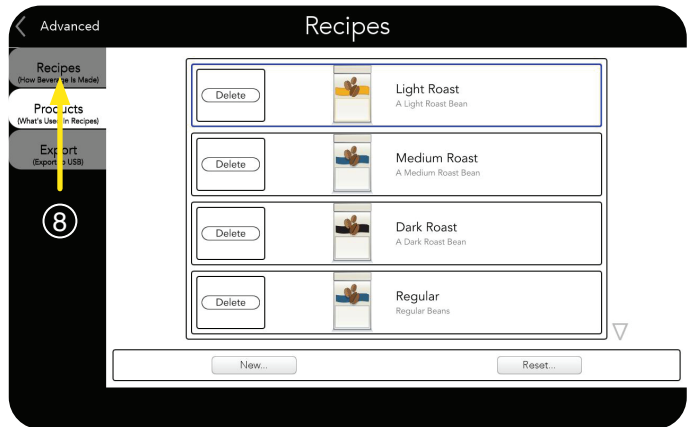

Recipe Setup

1. Press the **New** button.

2. Or, edit an existing **Recipe**.

For this example, we will select **Coffee 1** to edit.

NOTE: Definitions for sliders at top of screen.

Bold - increases the coffee throw weight by the percentage shown.

Leave Room - decreases the cup volume by the percentage shown. They **MUST** be enabled per recipe if desired.

3. Now choose the **GENERAL** tab to edit the recipe for **Coffee 1**.

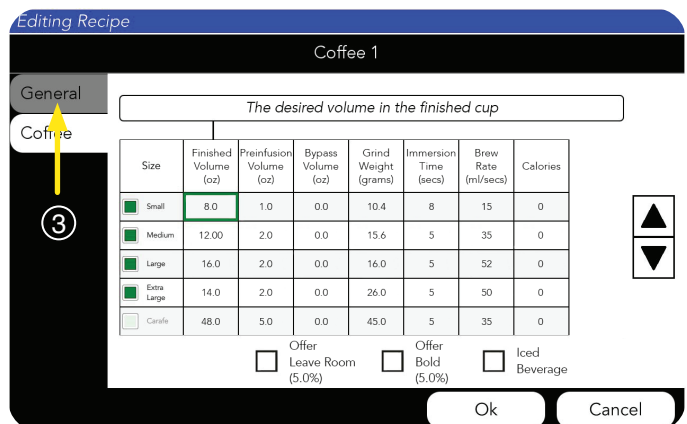
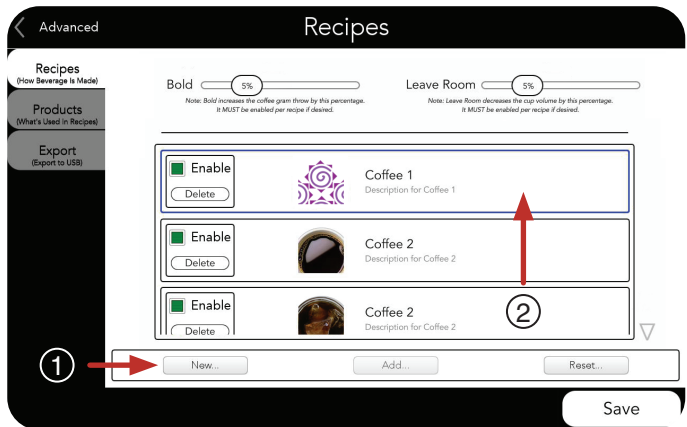

PRODUCT AND RECIPE SETUP

- Use the **drop down** menu to select the preferred coffee **Product**.
- We will use the **Product** called “Regular“ for this example.

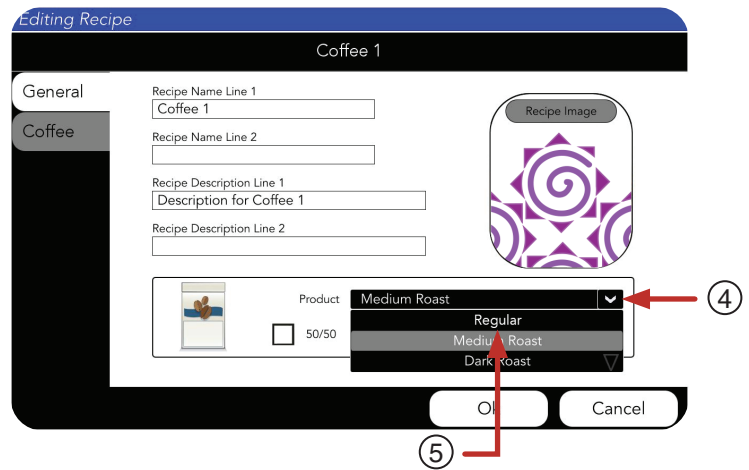

- Edit the **Recipe Name Line 1** and **Recipe Description Line 1** by pressing on the text field.

There are two extra fields for each if more space is needed.

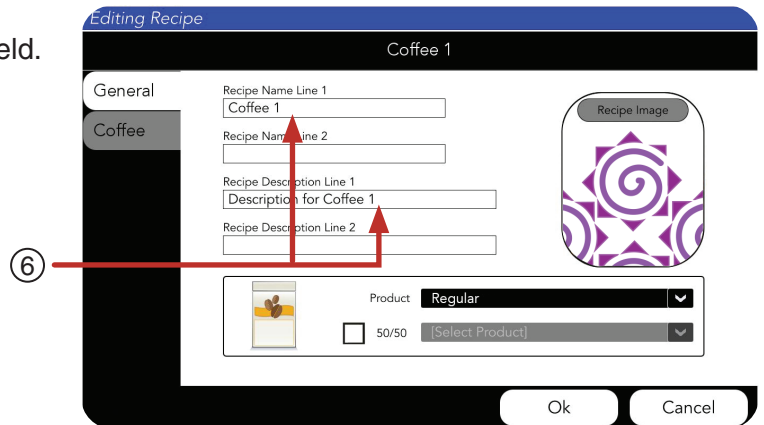

By pressing the **Recipe Name Line 1** and **Recipe Description Line 1** text fields, an input screen will appear.

- Type the description.
- Press the **Return** key to complete.

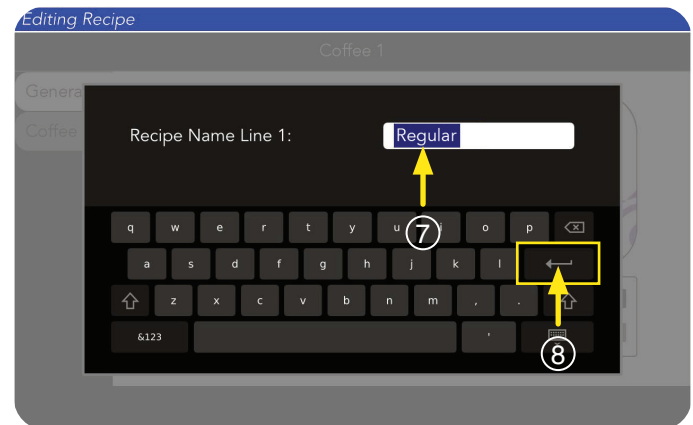

- Next, the **Recipe Image** can be changed, if preferred.

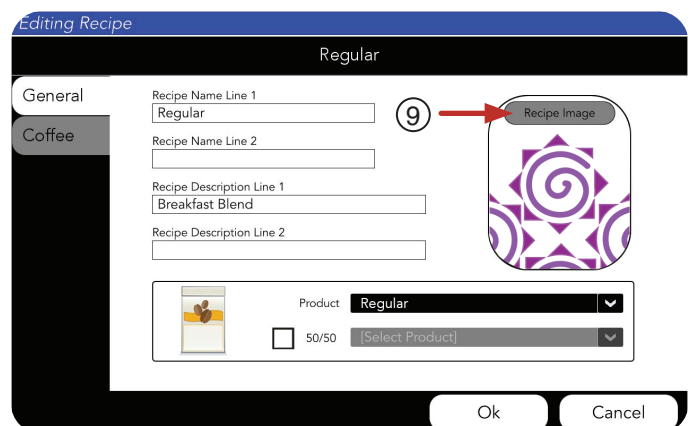

PRODUCT AND RECIPE SETUP

Recipe Setup (continued)

10. By swiping **side-to-side**, you can see the icon library.

11. Select the image, and press **OK**.

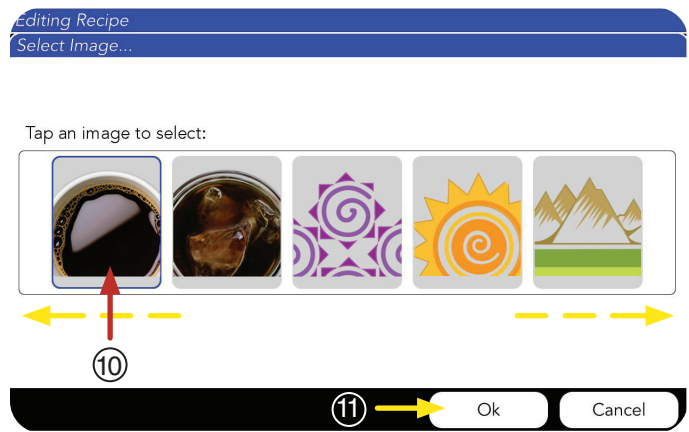

Editing Coffee Recipes By Size

You can make changes to **Recipes** for the sizes enabled.

1. Press the **COFFEE** tab to start.

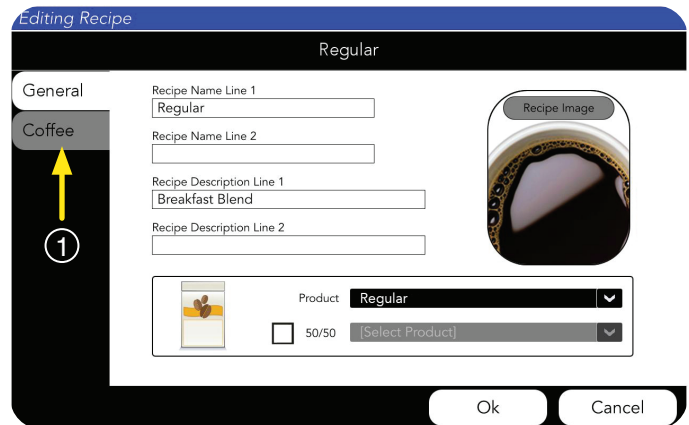

Example: Each size with a green box is enabled.

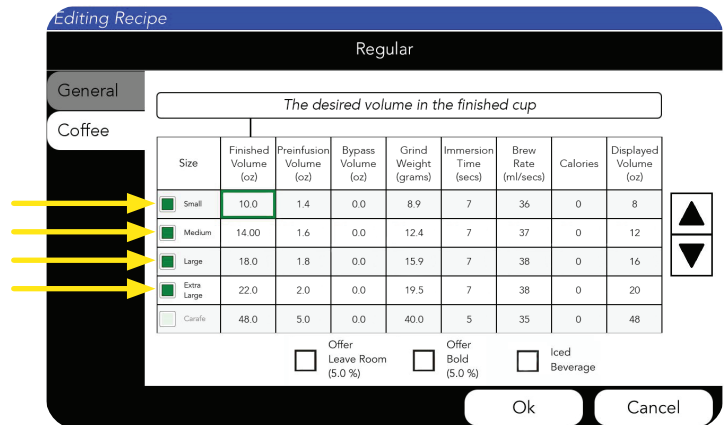

Coffee **Recipes** can be edited from this screen by clicking any of the numbers in the table cells.

1. For this example the **Small Volume** is being revised as shown by the green border.

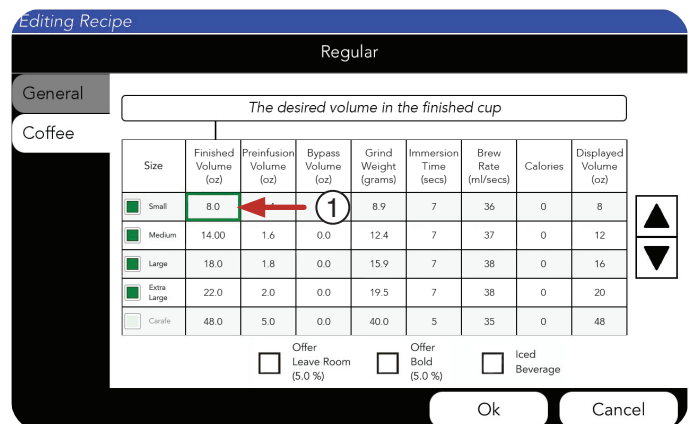

PRODUCT AND RECIPE SETUP

- The arrows on the right side of the screen can increase or decrease the selected number by decimal points. *Example: 8.0 to 8.1, 8.2, 8.3, etc.*

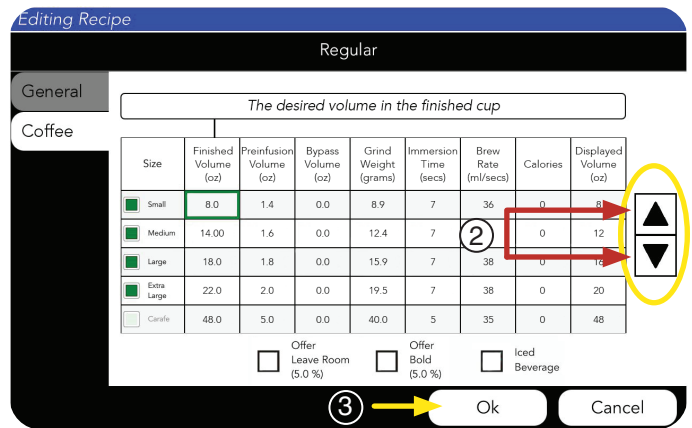

- Press **OK** if changes are made.

The option to make a **Bold** beverage, or to **Leave Room**, can be enabled from this screen.

- Press the square for either (as shown).
 - Leaving Room** in a beverage means using 5% less total water volume, starting with the bypass.
 - A **Bold** beverage uses 5% more ground coffee above the normal grind weight.

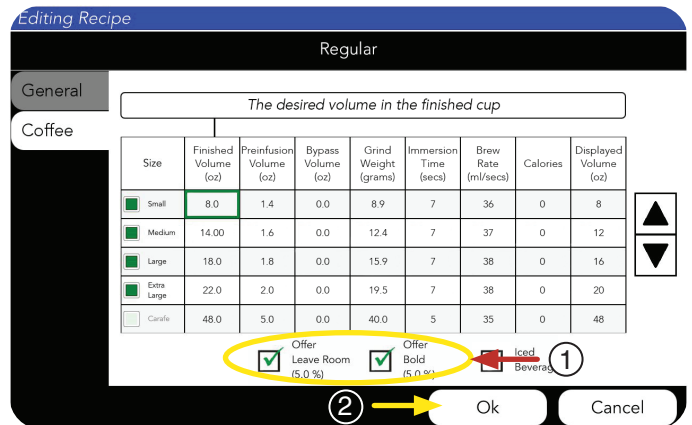

- Press **OK** if changes are made.

An **Iced Beverage** can be enabled from this screen.

- Press the square labeled **Iced Beverage**.

NOTE: This programs the machine to send the finished drink through the chiller before dispensing.

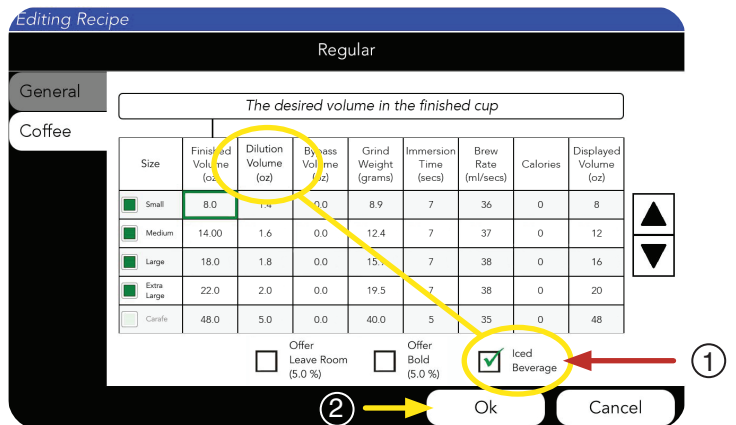

- Press **OK** if changes are made.

- When you have all your **Products** and **Recipes** saved, press the **ADVANCED** link to return to the **ADVANCED** menu.

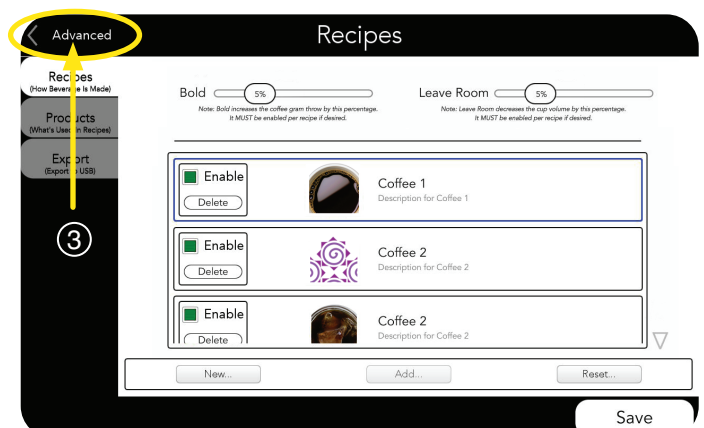

PRODUCT AND RECIPE SETUP

Enabling Products

1. Next, select the **PRODUCT SETUP** button to enable and setup the hoppers.

NOTE: The **Graphic User Interface** will be set up through the **Product Setup** button.

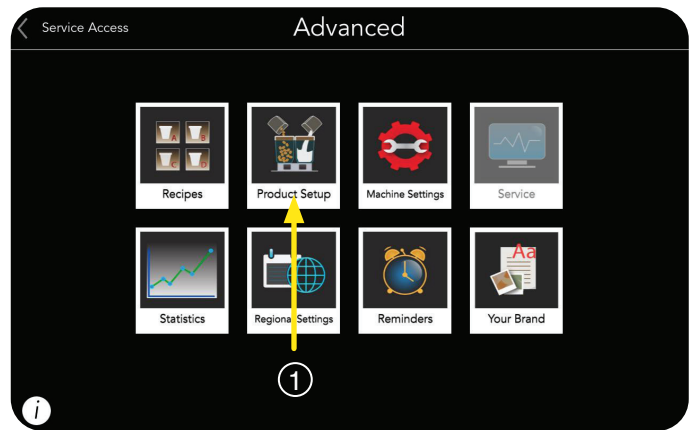

2. Next, select the **BEVERAGES OFFERED** tab.



3. Choose the **Enable** boxes for the beverages you want available to brew.

4. Also, choose the **size(s)** you want available for each beverage.

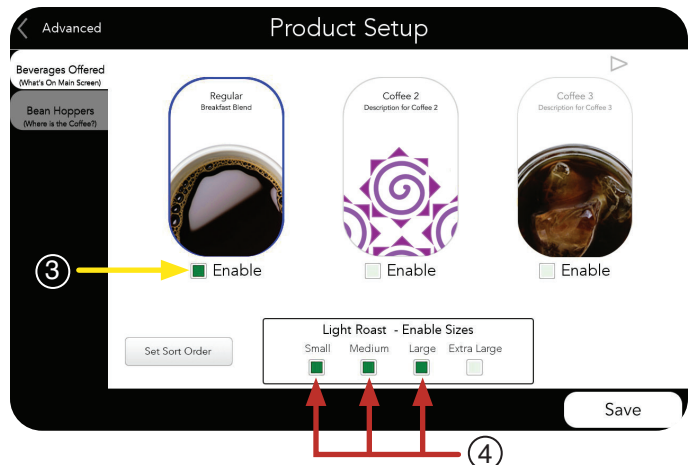

5. Press **SAVE** if changes are made.

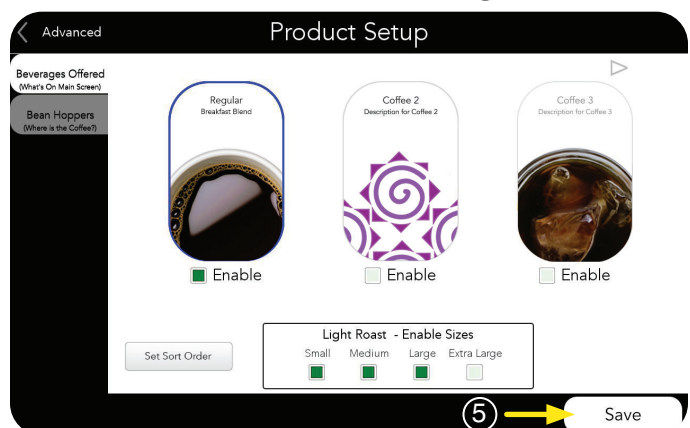

PRODUCT AND RECIPE SETUP

- You can organize the way the customer will view the coffees offered by pressing the **Set Sort Order** button.

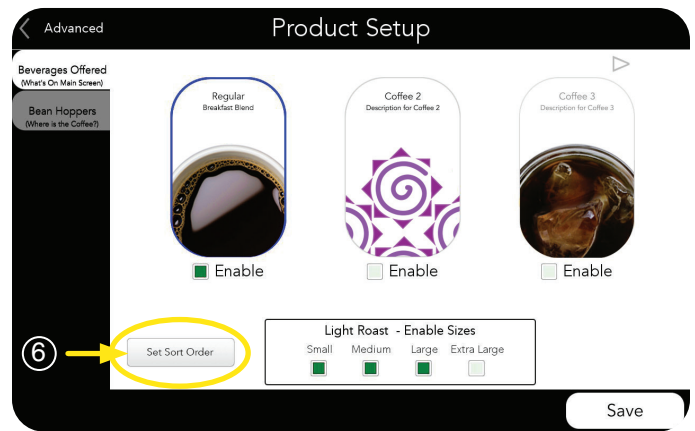

- By **pressing and sliding**, you can move through the entire icon library. Then, drag the icon chosen to the preferred position.

- Or, to scroll **side-to-side**, press the arrow in the lower corner.

NOTE: Beverages will be shown in the order displayed on this screen.

- Press **OK** when finished.

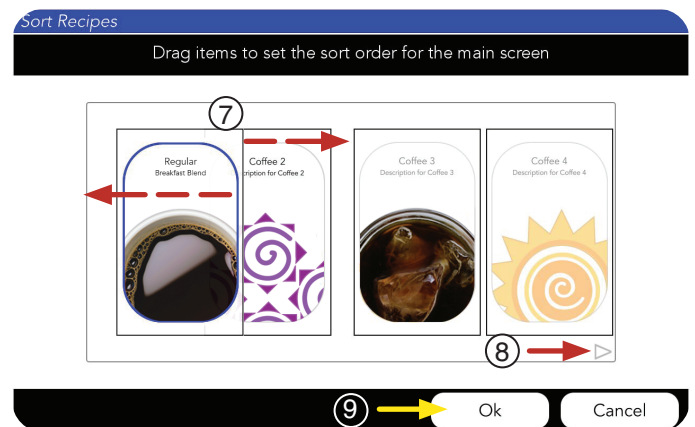

Bean Hoppers Setup

- Select the **BEAN HOPPERS** tab to assign which **Product** goes in which hopper.

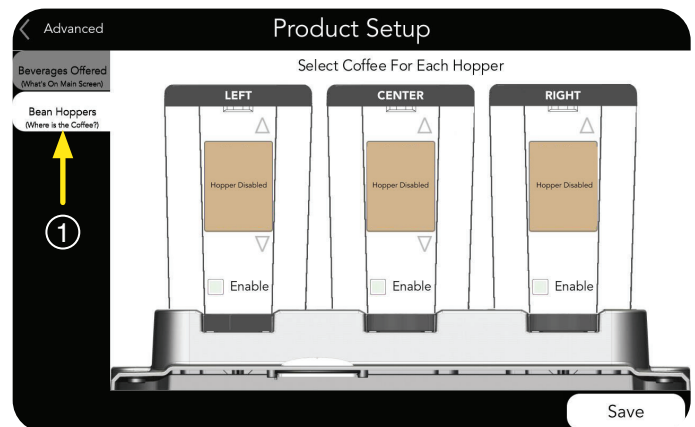

- Press the **Enable** box to select which hopper to use.
- After Enabling a hopper, you can use the **up and down arrows** to select an icon for the **Product** in that hopper.
- Press **Save** when finished.

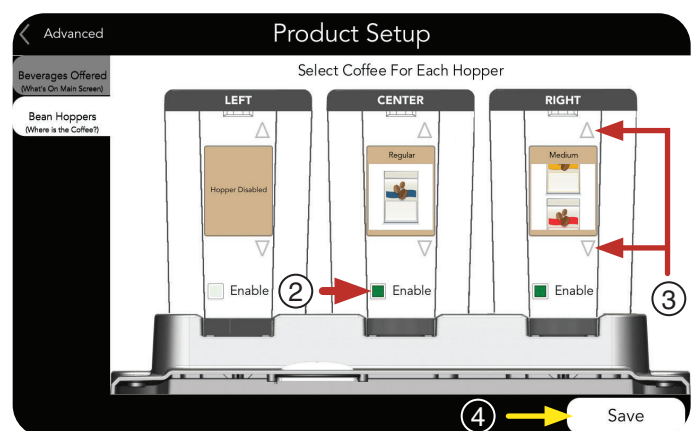

PRODUCT AND RECIPE SETUP

Bean Hoppers Setup (continued)

5. Select **SERVICE ACCESS** to return to **HOME** screen.

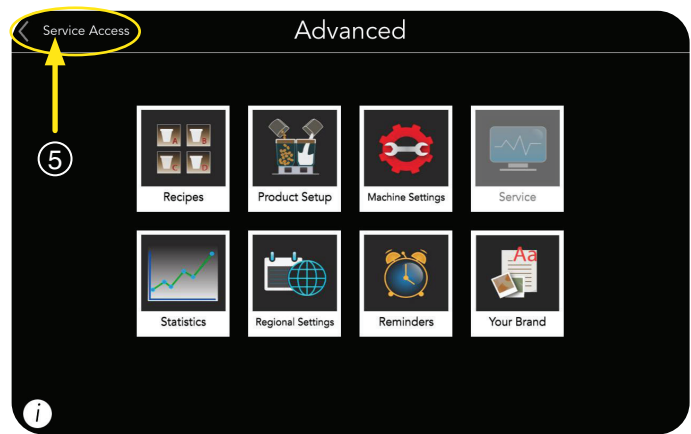

After the machine updates, the **HOME** screen should appear, and the **Products** and variables you just created should be available.

You are ready to serve.

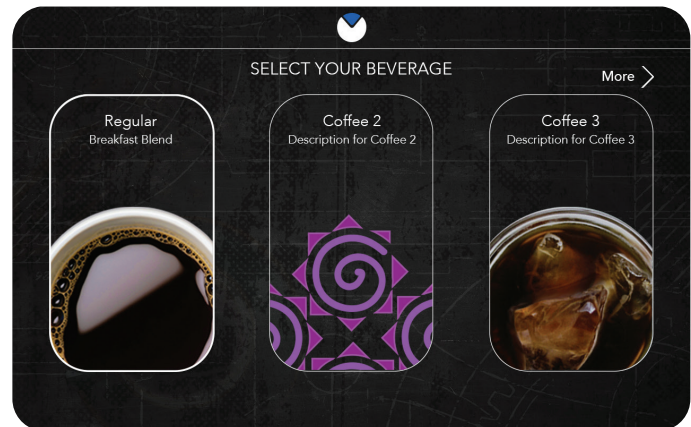

OPERATING INTERFACE

User Interface

The first screen to appear is the **User Interface** screen, also known as the beverage **Carousel**.

1. Available drinks are accessed by **swiping left or right** across the screen, or by **touching the arrow** located at the top right of the screen.

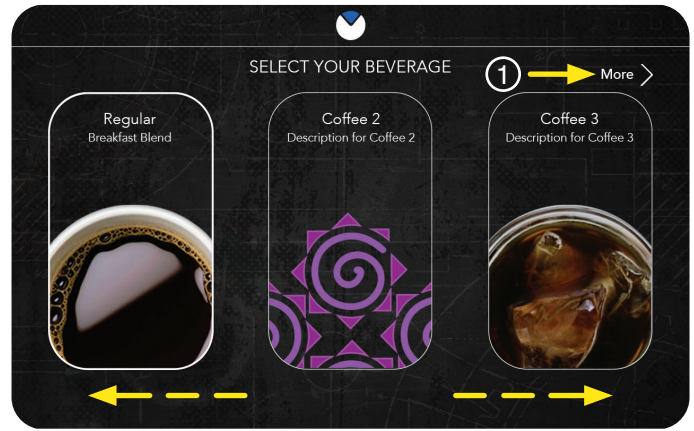

2. Next, press the desired drink icon. The border will change when selected.

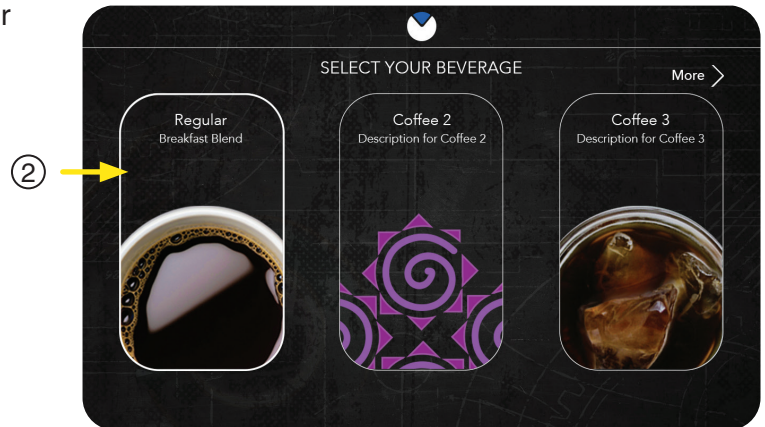

3. The user is prompted to select a desired beverage **size**.

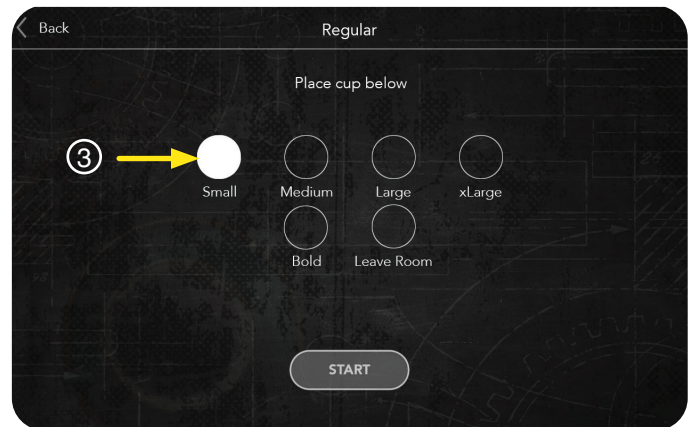

4. Next, place the beverage container (cup) on tray below.



OPERATING INTERFACE

User Interface (continued)

5. Next, press the **START** button to begin.

NOTE: If the beverage selected is an iced beverage, the screen will prompt the user to fill the cup with ice prior to placing the beverage container (cup) on the tray.

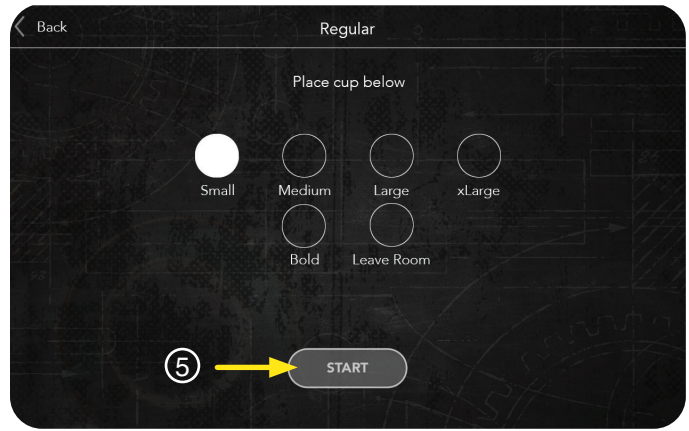

6. Next, the chosen beverage preparation is shown in step-by-step visuals... Grinding... Immersion... Brewing... and dispensing.

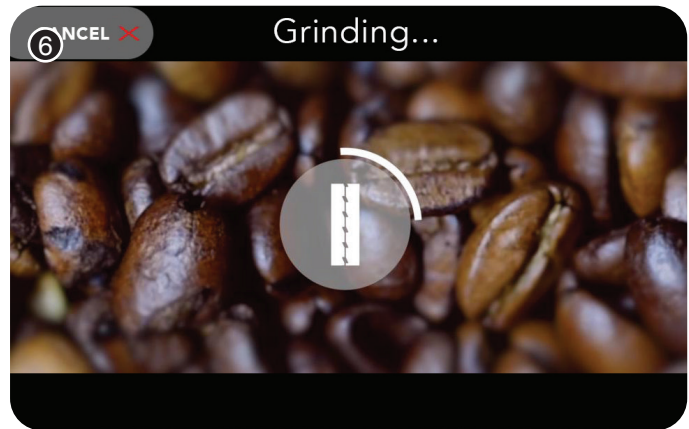

7. The user will then be returned to the original selection screen to choose again.

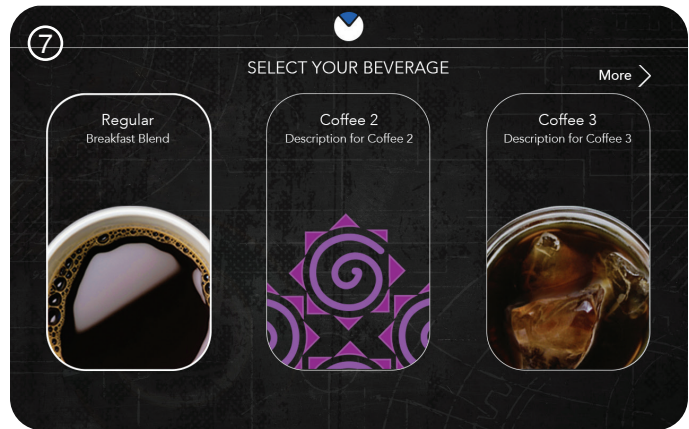

Cancelling Beverage Preparation

The user can stop a beverage preparation during processing.

1. Press **CANCEL** button.

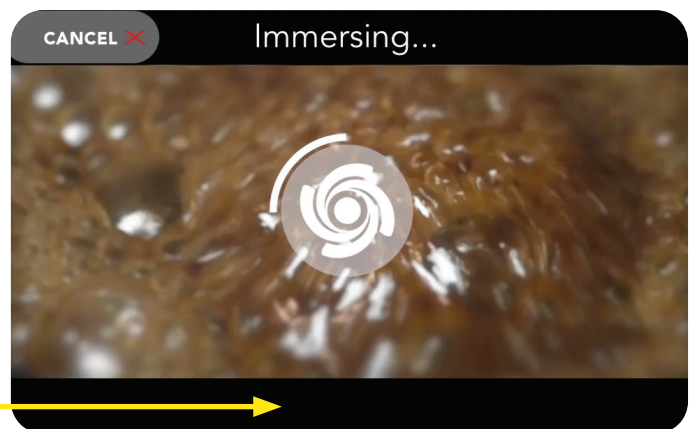

OPERATING INTERFACE

- The user will be presented with a new **Customer Care Alert** indicating that the machine is **Resetting**.

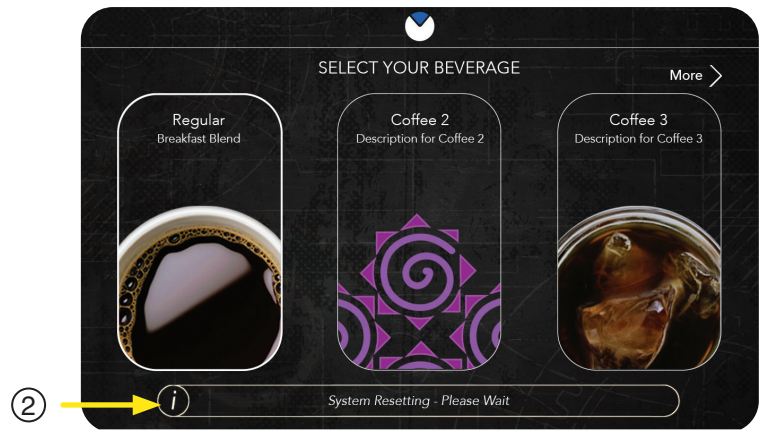

- The user will then be returned to the original selection screen to choose again.

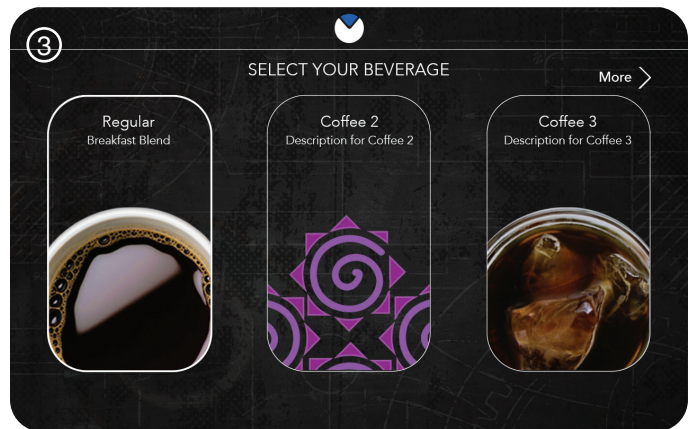

ADA Interface

- To activate the ADA screen interface, the user must press the **Accessibility** symbol (wheelchair icon).



- When activated, the screen will have a blue banner across the top, and a blue highlight around the item being selected.

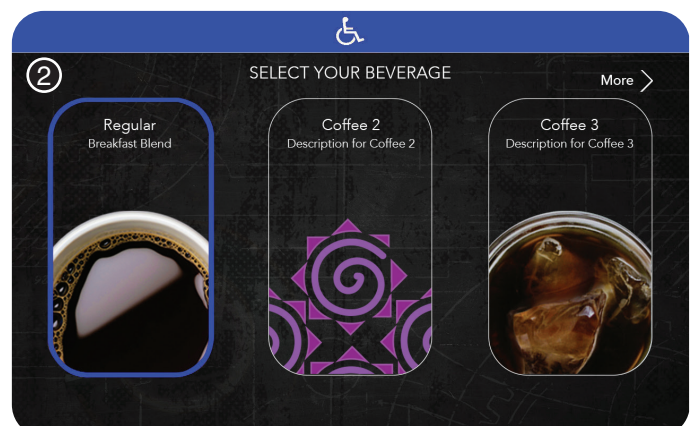

OPERATING INTERFACE

ADA Interface (continued)

3. Navigate around the screens using the **Left** and **Right** arrows on the ADA interface.

- a. Select a beverage.
- b. Press the **OK** button to confirm.
- c. Pressing the **X** cancels the selection.

NOTE: If the beverage selected is an **Iced Beverage**, the screen will prompt the user to fill the cup with ice prior to placing the beverage container (cup) on the tray.

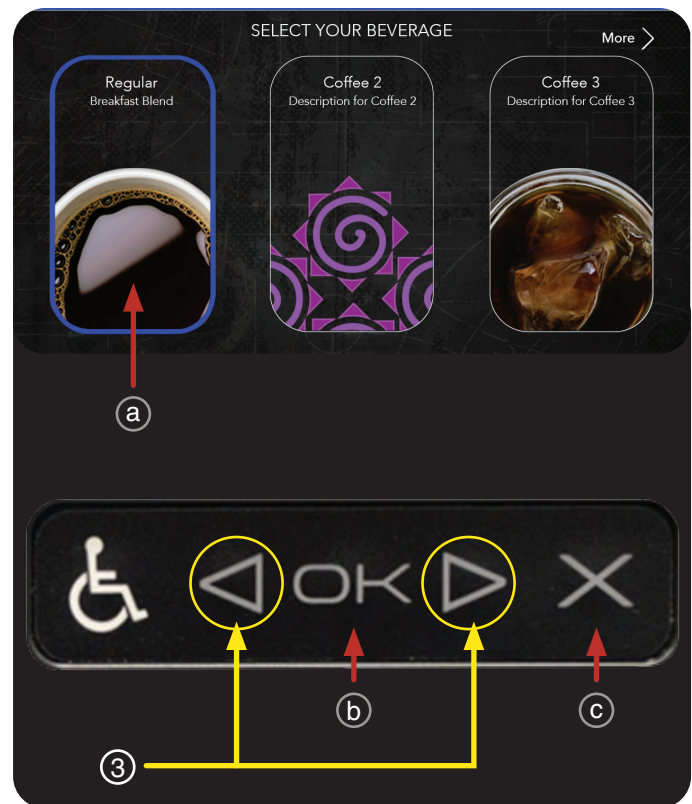

4. Selections available through the ADA interface on this screen; **Previous**, **Small**, **Medium**, **Large**, **Extra Large**, **Bold**, **Leave Room** and **Start**.

- a. Next, using the ADA arrows, choose a beverage size.
- b. Press **OK** to enter selection.



OPERATING INTERFACE

c. Navigate to the **START** button using the ADA arrows.

d. Press **OK** to complete selection.

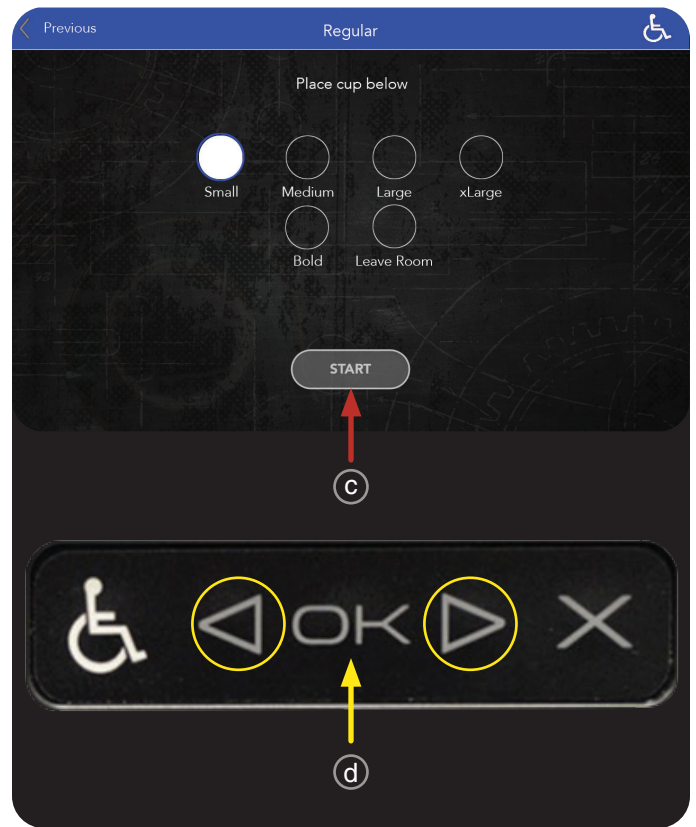

MACHINE SETTINGS

1. Touch and hold the **BUNN** logo for a few seconds until the **SERVICE ACCESS** screen appears.

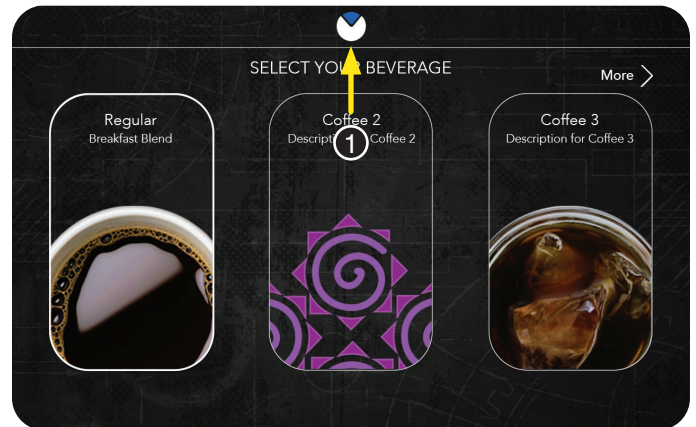

2. Select the **ADVANCED** icon.

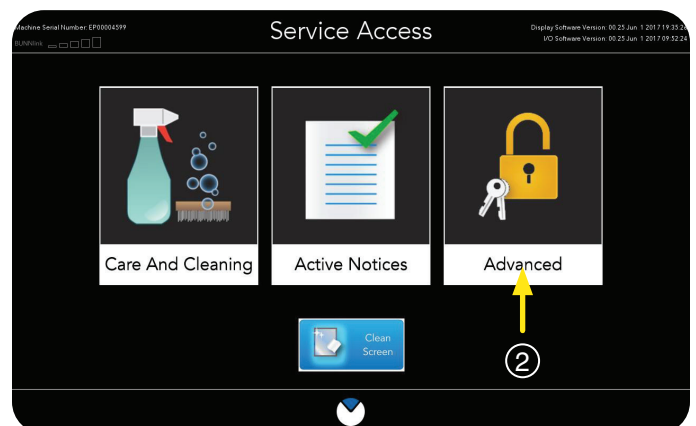

MACHINE SETTINGS

Service Access (continued)

- Choose the **MACHINE SETTINGS** icon.

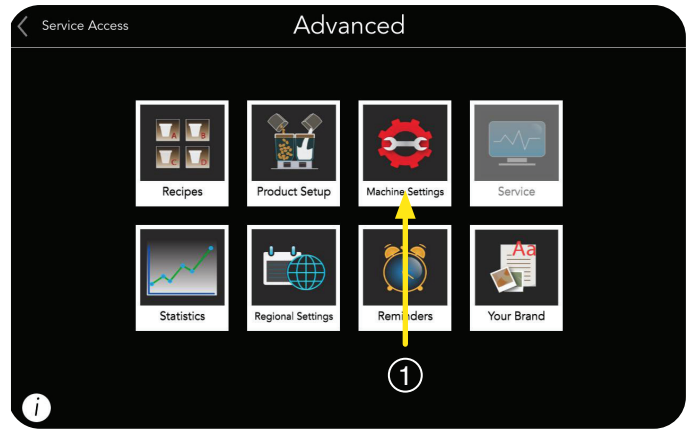

Temperature

- The brew tank temperature default is 200°F. If the temperature needs to be adjusted for high altitude, press the **“Altitude Chart”** button.

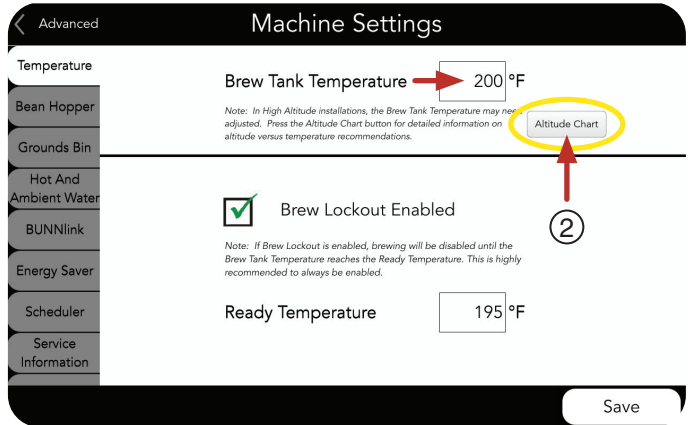

- On the chart, find your current **Altitude**, then move to the right to find the suggested tank temperature setting.

The chart will scroll down for more altitude settings.

Press **OK** to return to the temperature screen.

Altitude (Feet)	Boiling point of Water		Recommended water temperature	
	°F	°C	°F	°C
-1000	213.8	101.0	200	93.3
-500	212.9	100.5	200	93.3
0	212.0	100.0	200	93.3
500	211.1	99.5	200	93.3
1000	210.2	99.0	200	93.3
1500	209.3	98.5	200	93.3
2000	208.4	98.0	200	93.3
2500	207.4	97.4	200	93.3
3000	206.5	96.9	199	92.8
3500	205.6	96.4	198	92.8

An 'Ok' button is visible at the bottom right of the table, with a circled '3' and a yellow arrow pointing to it.

- Touch the **Temperature** box to edit the temperature setting.

- Press **Enter** to accept.

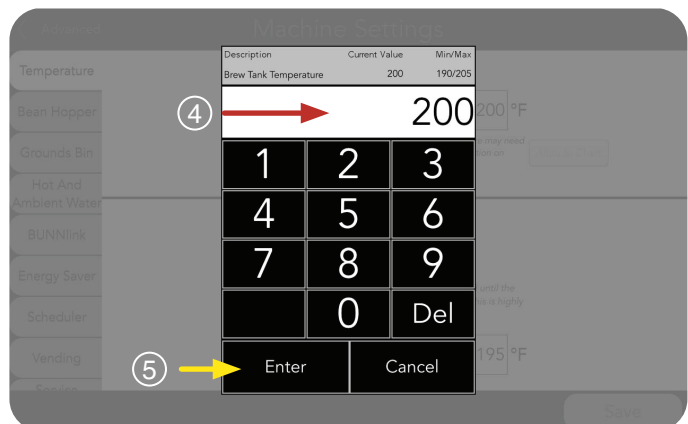

MACHINE SETTINGS

- If the tank temperature falls below the ready temperature setting, brewing will be disabled until the ready temperature is reached.

Press the **Ready Temperature** box to alter the ready temperature.

- Press in the check box to remove the green check mark, and disable **Brew Lockout**. Coffee brewing can be performed regardless of tank temperature.
- If any changes are made to the **Temperature** screen, press **Save** to confirm.

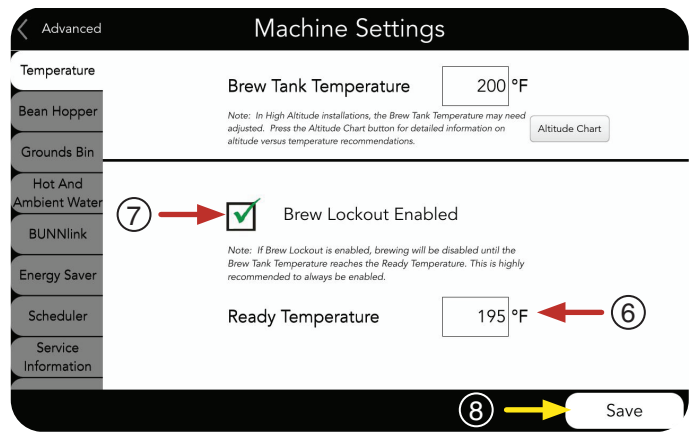

Bean Hopper

- Hoppers have sensors which will indicate when the hopper is low on beans.

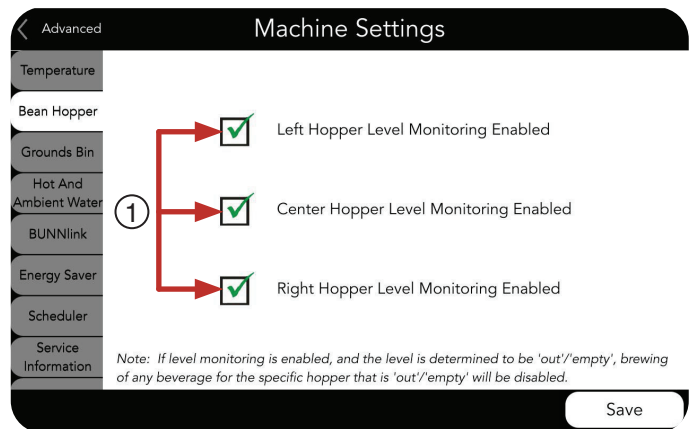

- To disable bean hopper level monitoring, press in the check box for any or all hoppers to remove green check mark.

- If any changes have been made, press **Save** to confirm.

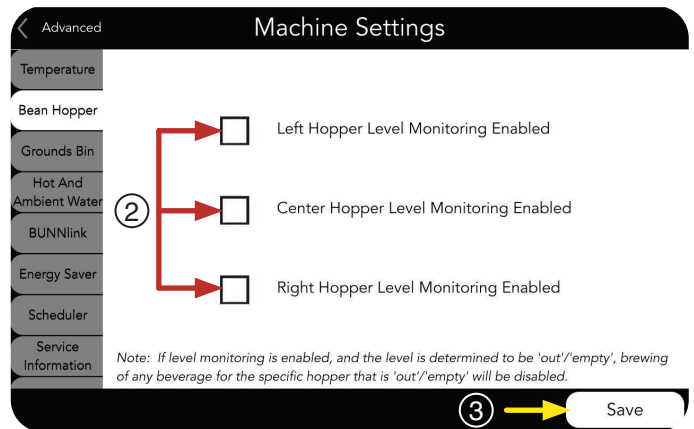

MACHINE SETTINGS

Grounds Bin

1. The grounds bin level is monitored by measuring the grinder on time. When the machine has determined that enough coffee has been used, a grounds bin full message will be displayed.
2. If the grounds bucket is too full, sliding the button to the left will reduce the amount of grounds in the bucket before indicating full. If there is extra room in the bucket at the full signal, sliding the button to the right will allow more grounds before indicating full.
3. If any changes to the screen have been made, press **Save** to confirm.

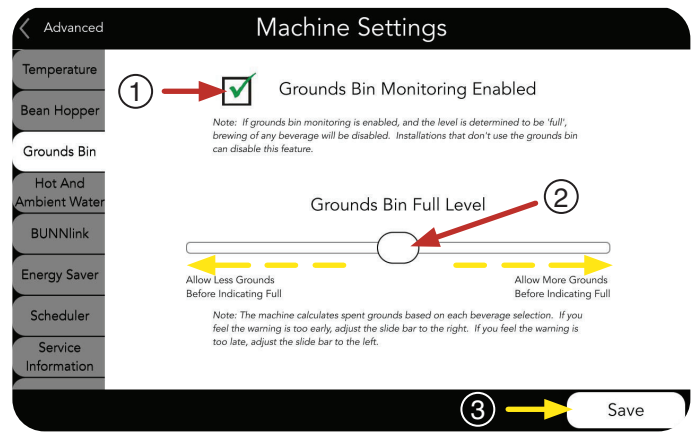

Through Counter Disposal

The grounds bin can be removed for “**through the counter**” grounds disposal. In this mode, the grounds bin detection must be disabled to allow brewing.

1. Press the check box next to “**Grounds Bin Monitoring Enabled**” to remove the green check mark, and disable grounds bin monitoring.
2. Press **Save**.

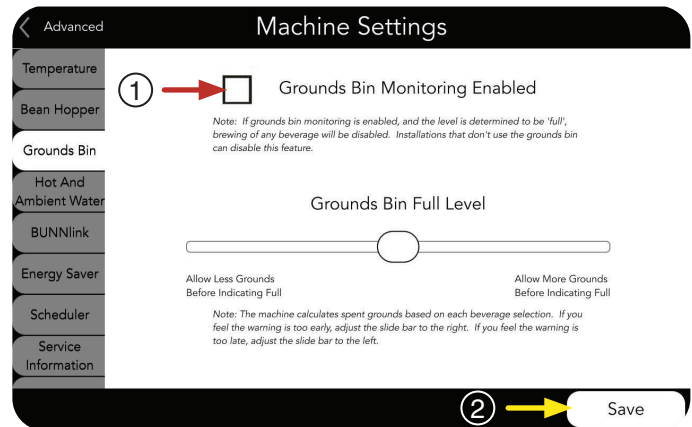

Hot and Ambient Water

1. With the check boxes enabled for **Hot and Ambient Water**, icons will be displayed on the lower right of the main screen for push and hold dispensing. Either **Hot or Ambient Water** dispensing can be disabled by pressing the check box to remove the green check mark and disable. *This will also remove the corresponding icon from the main screen.*
2. If any changes to the screen have been made, press **Save** to confirm.
3. Once enabled, the blue droplet (**Ambient**) and (**Red H**) droplet (**Hot**) will be displayed on the main screen.

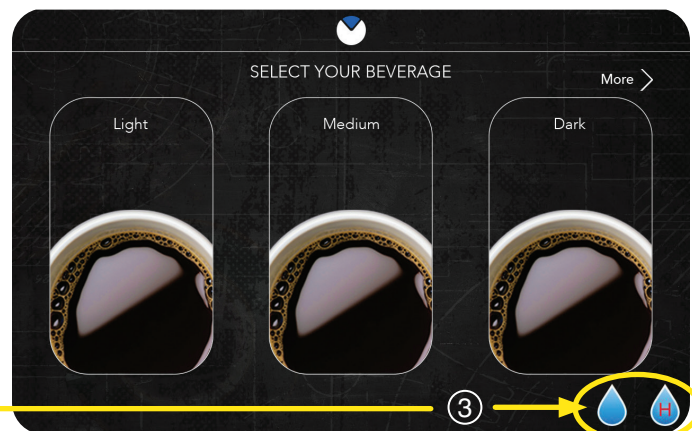
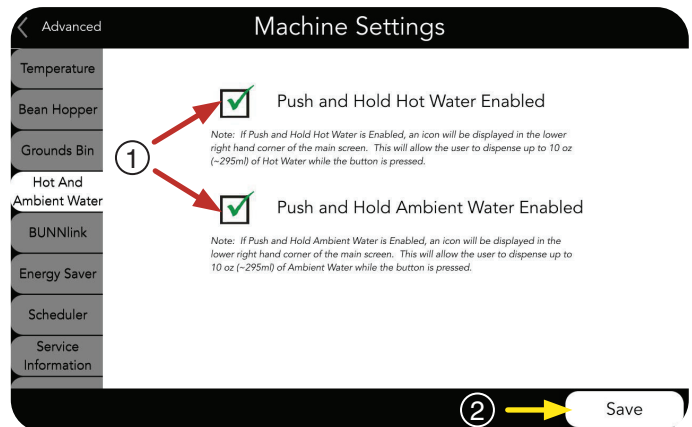

MACHINE SETTINGS

BUNNlink®

If BUNNlink hardware has been installed in the machine, this screen will indicate that it is active, and provide other data. There is no editable information on this screen.

NOTE: BUNNlink has to be **Enabled at Setup** after it is installed.

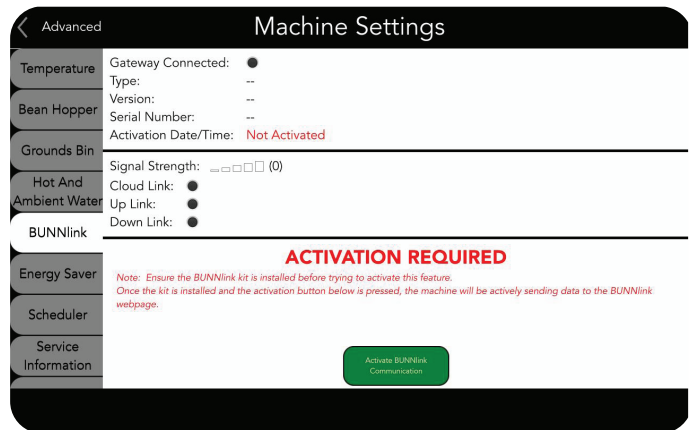

Energy Saver

1. Touching the check box will add the green arrow and enable the **Energy Saver** feature. If the check box is enabled, the machine will operate in an energy saver mode. After two hours of inactivity, the screen saver video will be stopped, and the backlight will dim. After four hours of inactivity, the brew tank temperature setting will drop to 140°F.
2. Touching the main screen at any time will exit the **Energy Saver** feature. If any changes to the screen have been made, press **Save** to confirm.

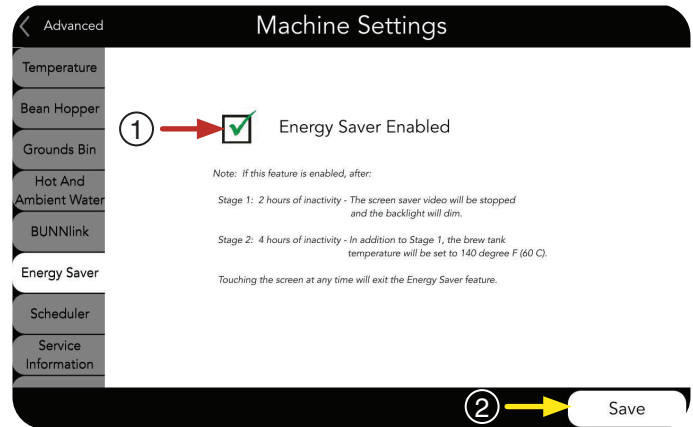

Scheduler

1. When **Scheduler** is enabled, the on/off, times/days of the week can be set to allow vending (brewing/dispensing). This can be used in conjunction with **Energy Saver**.
2. In this example, the machine is set to allow vending between 6:00 AM through 6:00 PM on Monday through Friday.

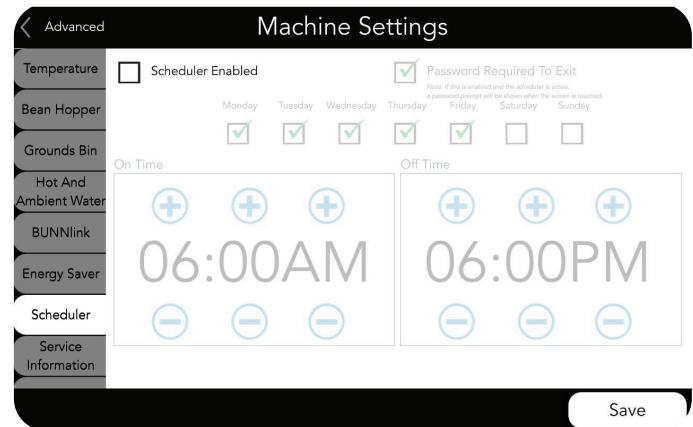

3. The **Password Required To Exit** checkbox means that a password (number) must be entered to allow vending.
4. Press **Save** to confirm.

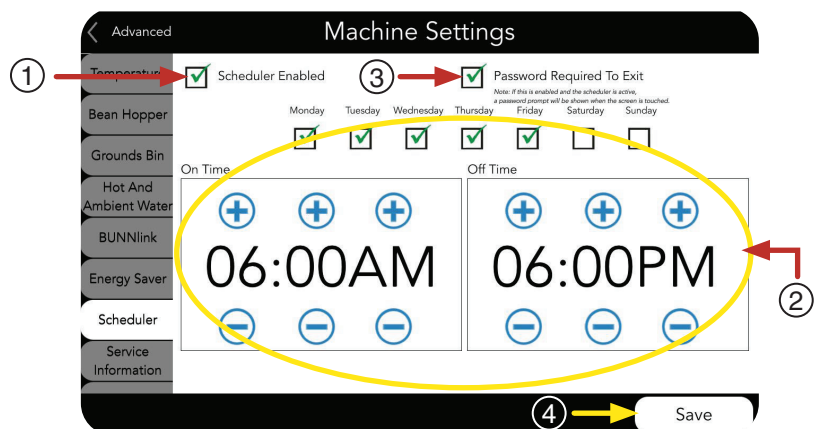

MACHINE SETTINGS

Service Information

1. In the event service may be required, information for contacting the appropriate service provider may be entered on this screen for ready access.
2. If any changes to the screen have been made, press **Save** to confirm.

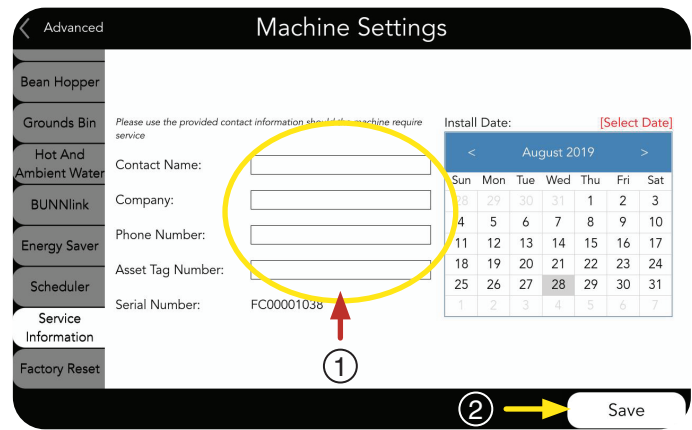

Factory Reset

Pressing the red button will cause stored values to be restored to the default setting the machine had when it shipped from the factory.

Caution! This will remove custom setting and images, and can NOT be undone!

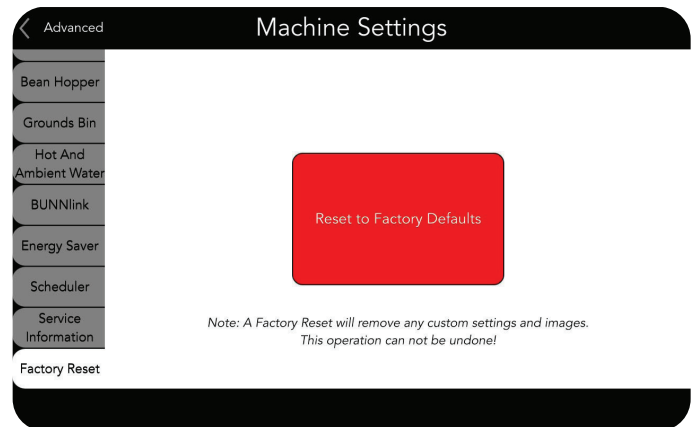

A warning screen will appear for a second opportunity to confirm that the **Factory Reset** should proceed.

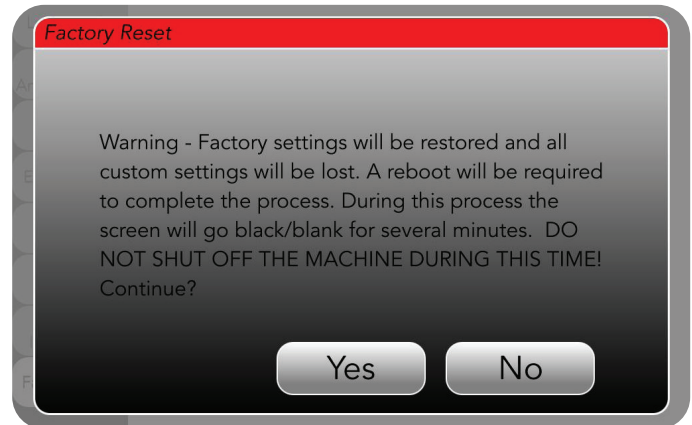

EXPORTING DATA USING USB

Setup of Multiple Machines

Once a machine is setup, you can export all of the settings and recipes to a **USB Stick**, and then copy this information to other machines (if they are to be setup the same way).

1. Press and hold the **BUNN** Logo Icon for three (3) seconds to access the **SERVICE ACCESS** screen.
2. At the **SERVICE ACCESS** screen, select the **Advanced** button.
3. At the **PASSWORD** screen, enter **2738**.
4. Next, At the **ADVANCED** service screen select the **YOUR BRAND** icon.

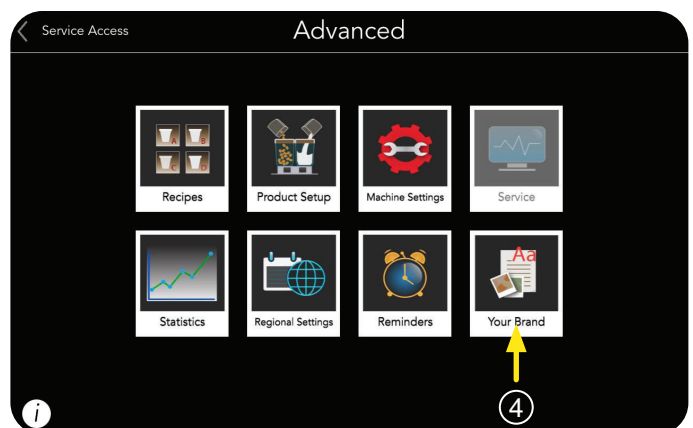
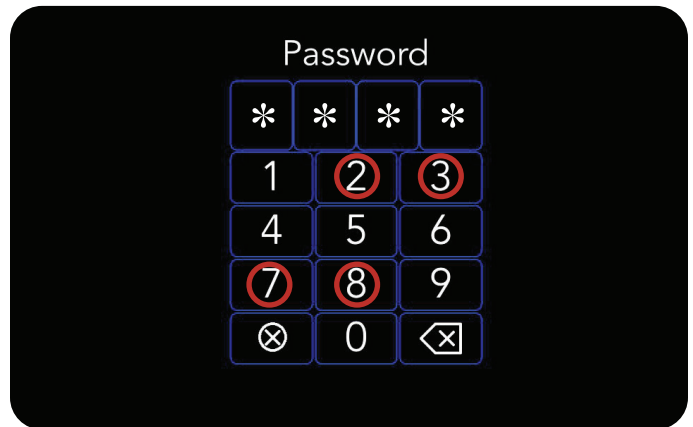
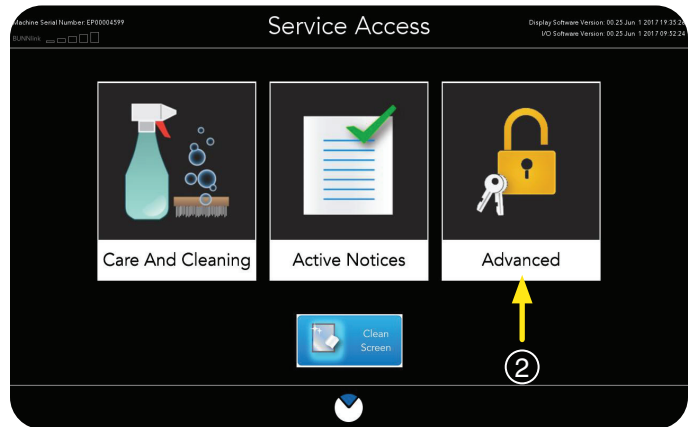
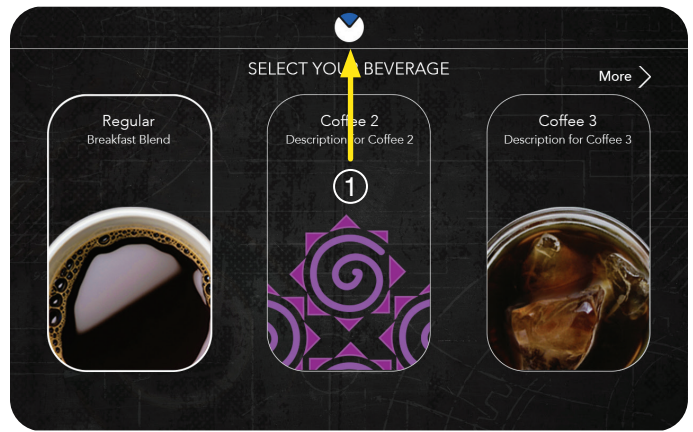

EXPORTING DATA USING USB

Setup of Multiple Machines (continued)

- At the **YOUR BRAND** screen select the **EXPORT** tab.

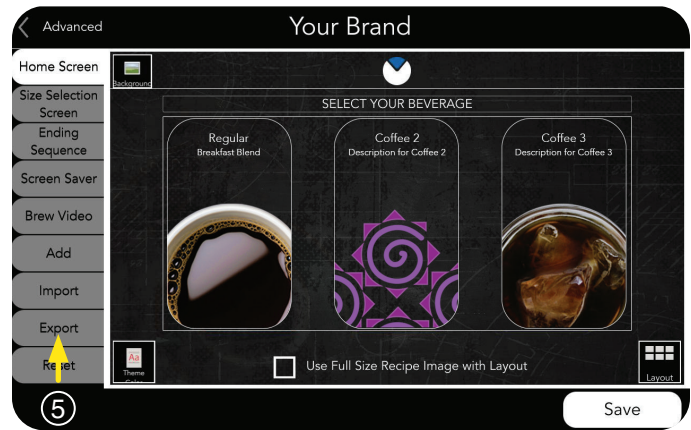

- Next, the user is prompted to insert the USB stick.



- The **USB port** is located behind the left side of the touch screen.



NOTE: The BUNN default **USB Stick** is part number 64165.0000

- A confirmation screen will appear showing the progress of the import.
- For more information about the status of the import, press the **Details** button.



EXPORTING DATA USING USB

- When the export is completed, the **OK** button can be selected and the **USB Stick** can be safely removed.

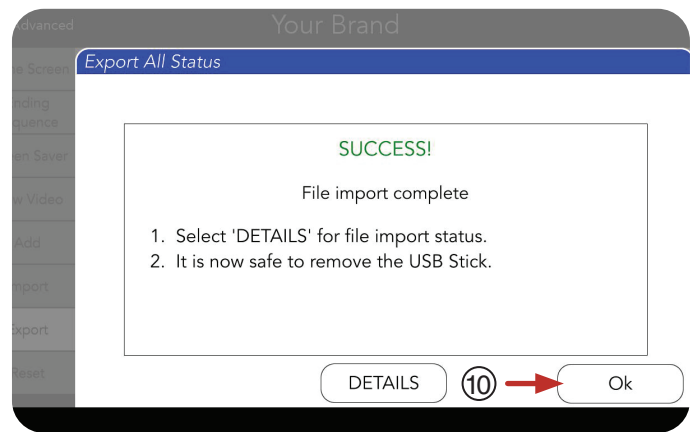

NOTE: If the screen says FAILURE!, no USB memory stick found! Then press the **Reboot** button to **Power Cycle** the machine.

The USB should be recognized after machine is fully powered up.

Refer back to step 11 for confirmation and details information.

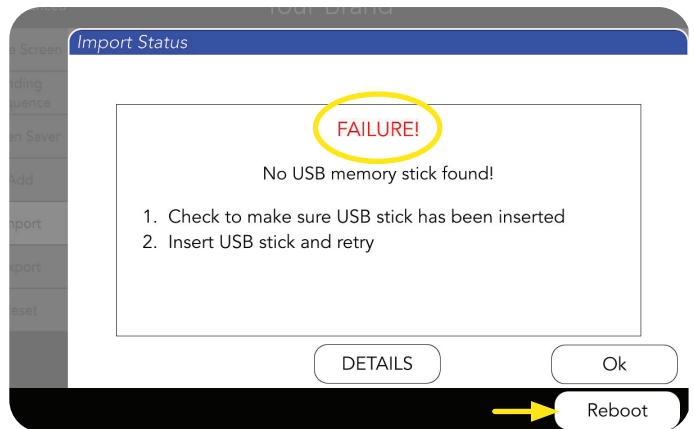

Copying Settings from Machine to Machine

- If you have a **USB Stick** with a copy of all the settings and recipes from one machine, and you want to copy this information to another machine; repeat the process from page 28, in steps 1 - 4, from the section “**Setup of Multiple Machines**”. Then, at the **YOUR BRAND** screen on the unit you are moving the settings to, select the **IMPORT** tab.
- The user is prompted to insert the **USB Stick**.

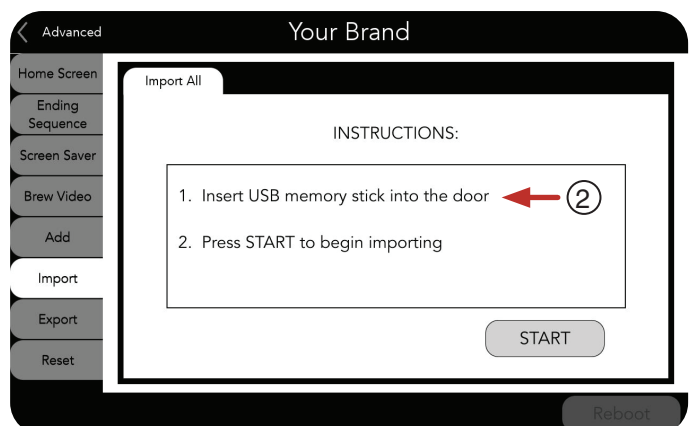
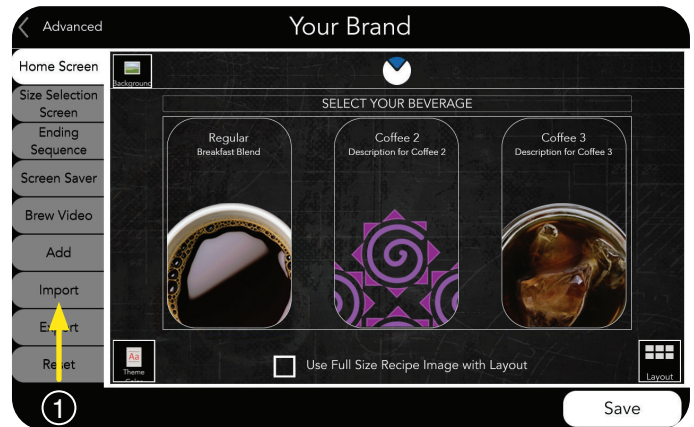

EXPORTING DATA USING USB

Copying Settings Machine to Machines (continued)

- The **USB port** is located behind the left side of the touch screen.



- Now that the USB stick is inserted, press **Start**.

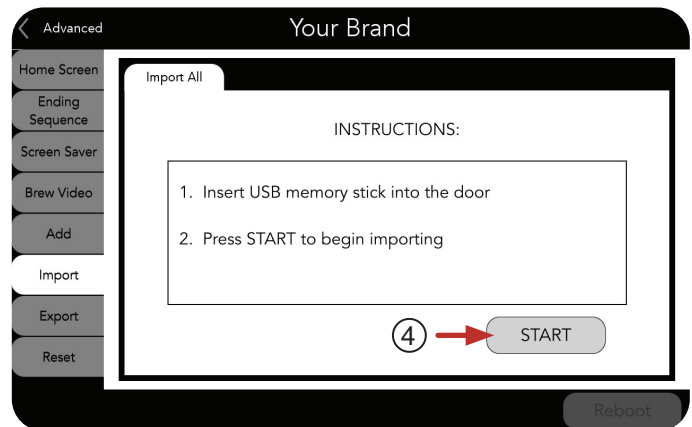

- A confirmation screen will appear showing the progress of the import.

- For more information about the status of the import, press the **Details** button.

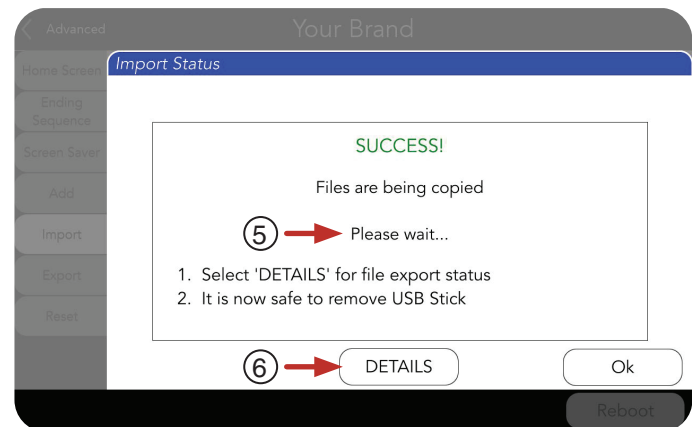

- When the import is completed, the **OK** button can be selected and the USB stick can be safely removed.

- Next, the **Reboot** button needs to be selected to complete the import. This will restart the machine's operating system.

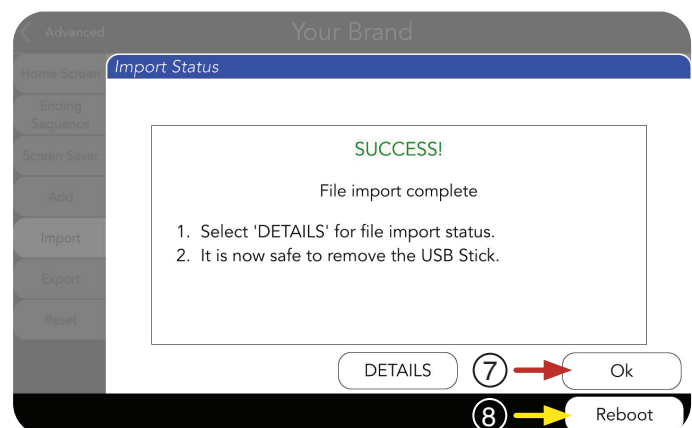

IMPORTING DATA USING USB

The **Update** screen will appear.

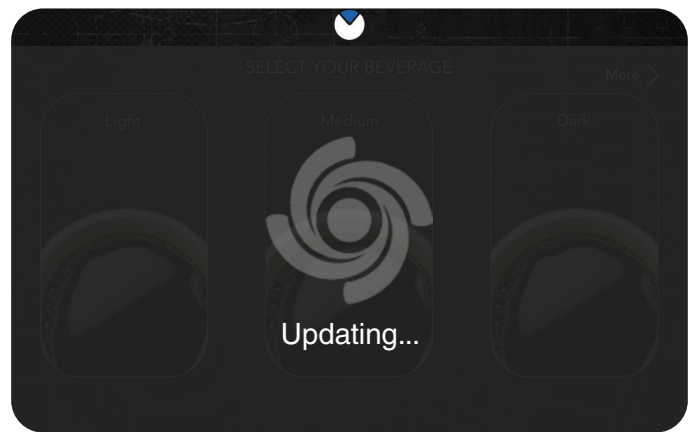

The **Importing Data** steps are complete. The imported settings and recipes should be available for use.

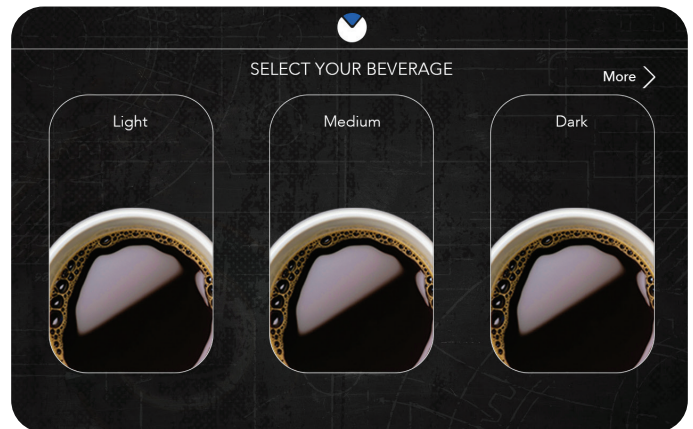

Adding to Your Brand

1. Press and hold the **BUNN** Logo Icon for three (3) seconds to access the **SERVICE ACCESS** screen.

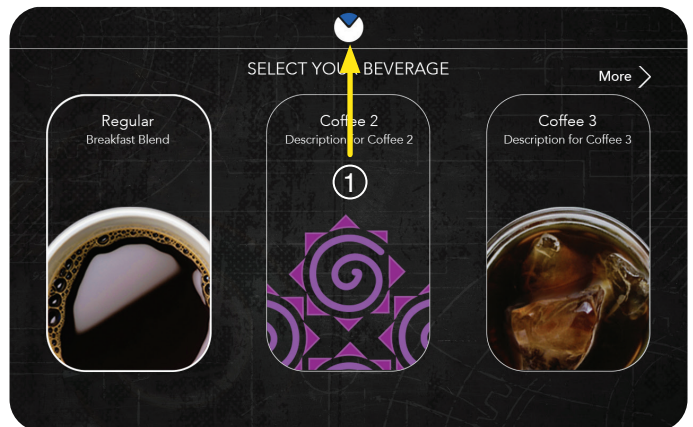

2. At the **SERVICE ACCESS** screen, select the **Advanced** button.

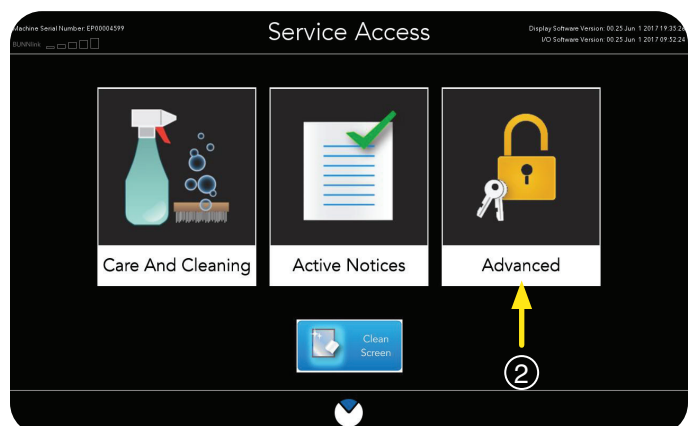

IMPORTING DATA USING USB

Adding to Your Brand (continued)

3. At the **PASSWORD** screen, enter **2738**.

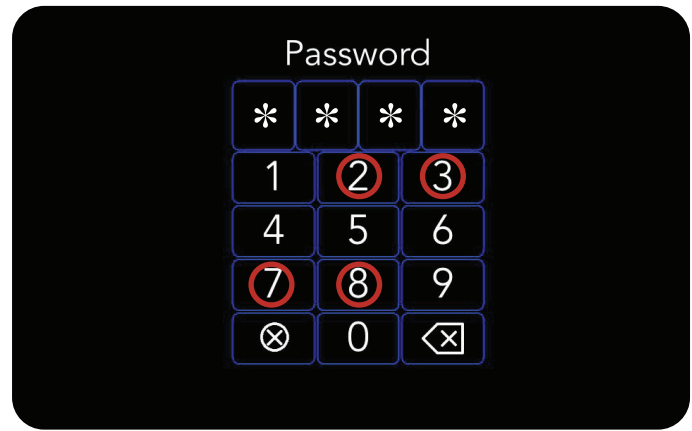

4. Next, At the **ADVANCED** service screen select the **YOUR BRAND** icon.

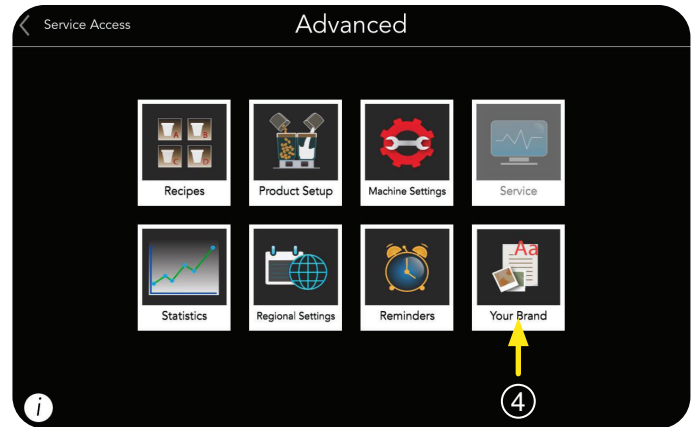

5. Select the **ADD** tab.

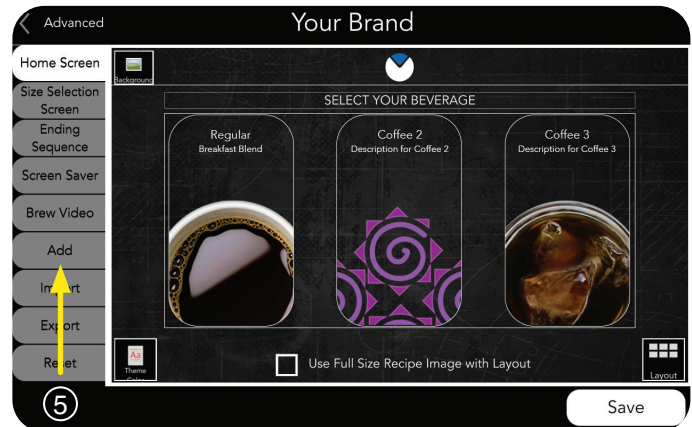

The **YOUR BRAND** screen will help you navigate to the customizable areas of the machine.

Customizable Areas Include:

- | | |
|--------------------|------------------------|
| Background Images | Product Images |
| Branding Logos | Brew Videos |
| Recipe Images | Ending Sequence Banner |
| Screensaver Videos | Training Material |
| Cup Size Images | |

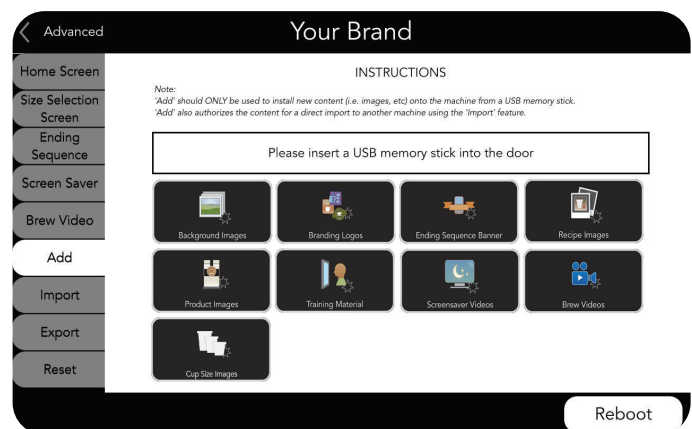

IMPORTING DATA USING USB

NOTE: Here is a list of standards to use in these customizable areas (for compatibility with the software):

General Specifications

- Images - .png or .jpg files saved in RGB mode.
- Videos - .mp4 files (no sound)

All should use clear naming structures **without** these keyboard symbols: /, ;, *, ?, ", <, >, |.

Image and Video sizes:

Background Image - 1280 x 800 px
Beverage Complete Background - 1280 x 800 px
Screen Saver Video - 1280 x 800 px

Beverage Icon
350 x 350 px

Product Badges
100 x 132 px

Logo
up to 160 x 80 px

Brew Video - 1280 x 720 px

End of Sequence Banner
1240 x 400 px

In addition to images and videos, sections have options within each branding opportunity, like changing font color, editing text, enabling/disabling videos, etc.

6. For this example, we selected the “Recipe Images” button.

NOTE: The **ADD** tab should be used by people approved to make changes since your customers will see the changes.

NOTE: This is the 1st step to loading graphics onto a single machine. If you want to setup multiple machines, see page 29 for **Copying Settings from Machine to Machine**.

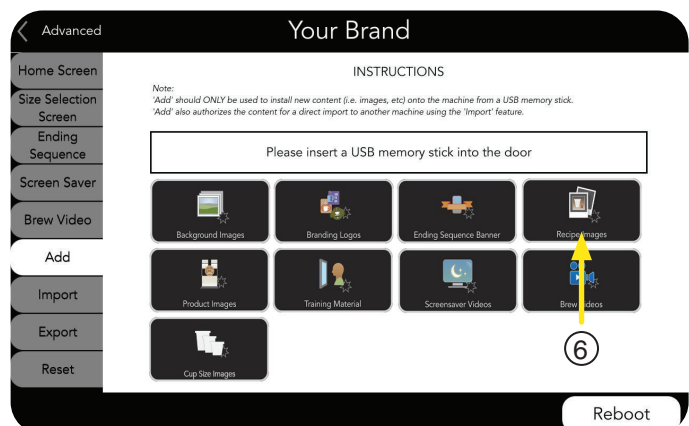

IMPORTING DATA USING USB

Adding to Your Brand (continued)

7. A screen will prompt you to insert the USB stick.

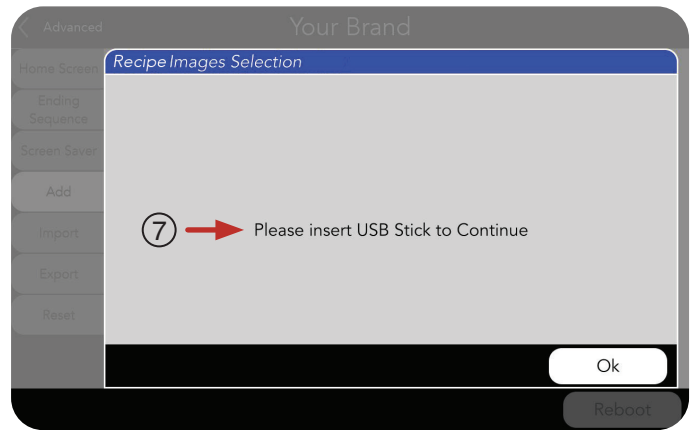

8. The **USB port** is located behind the left side of the touch screen.

NOTE: The BUNN default USB stick is part number 64165.0000.



9. Once the USB is detected, the file browser screen will appear.

NOTE: Do not press **OK** yet.

Select which **language** the files should be imported into (where applicable) by pressing the arrow on the **drop down menu**.

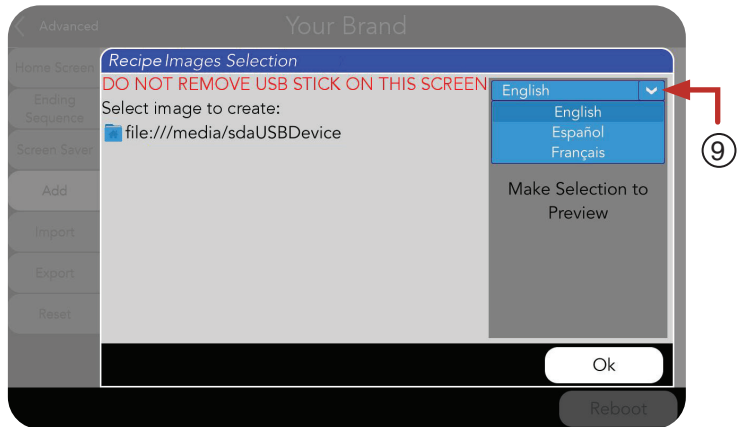

10. Select the folder location (source).

11. Contents in the folder should appear, showing either more folders or individual images. Press the file name of the chosen image. A **preview** will appear.

12. If the image is approved, press **Add**.

TIP: Including dimensions of files in descriptions can make choosing the correct file easier.

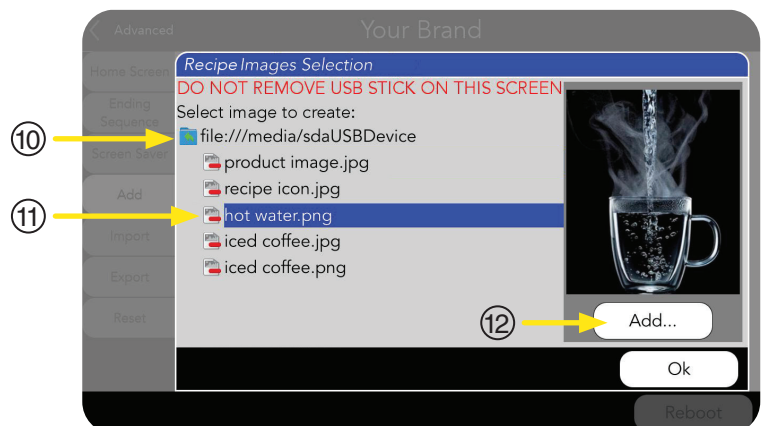

IMPORTING DATA USING USB

13. The **SUCCESS** screen will appear when a file finishes importing.
14. When the import is completed, select the **OK** button.
15. For more information about the status and history of the imports, press the **Details** button.

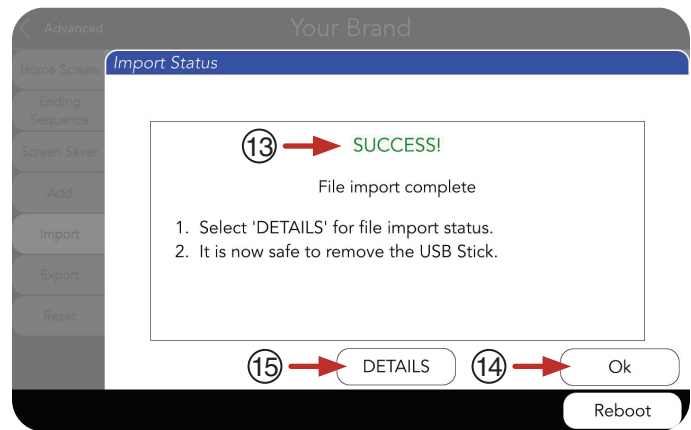

NOTE: If needed, repeat steps 10 thru 14 to add more files.

16. When the files are done importing, press **OK**.
17. If you are done adding files, the USB stick can be safely removed, and the **Reboot** button should be pressed.

NOTE: The **Reboot** button will restart the machine's operating system.

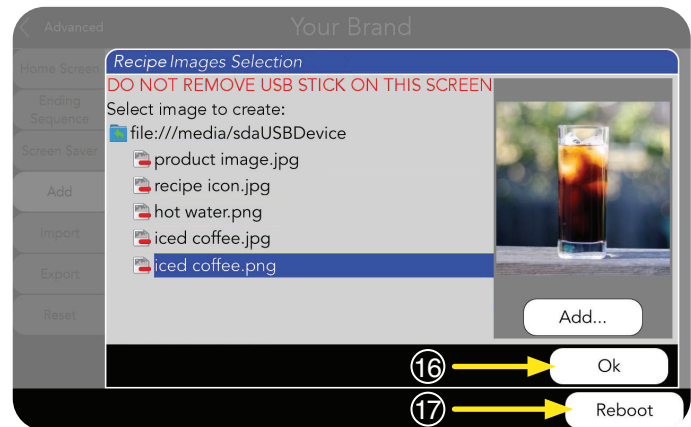

Accessing Imported Images & Videos

1. Touch and hold the **BUNN** logo for a few seconds until **SERVICE ACCESS** appears on the display.
2. Select the **ADVANCED** icon.

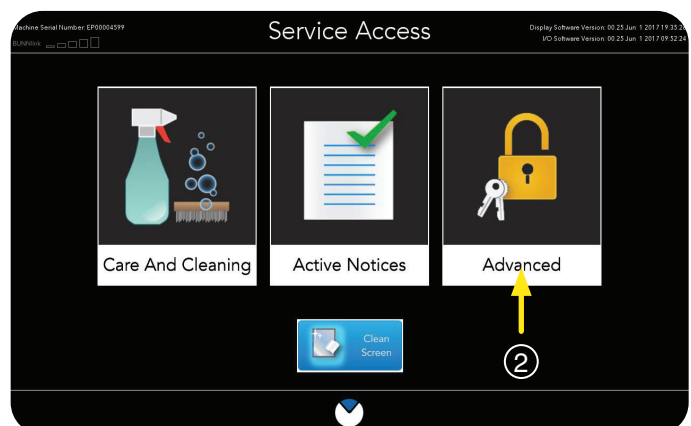
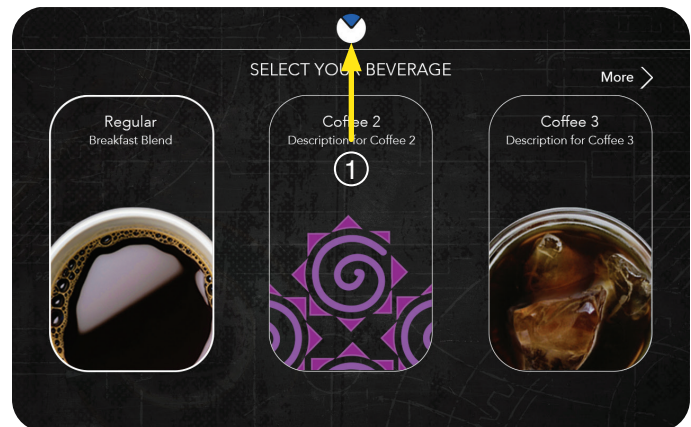

IMPORTING DATA USING USB

Accessing Imported Images & Videos (continued)

3. Next, enter the passcode **6601**.

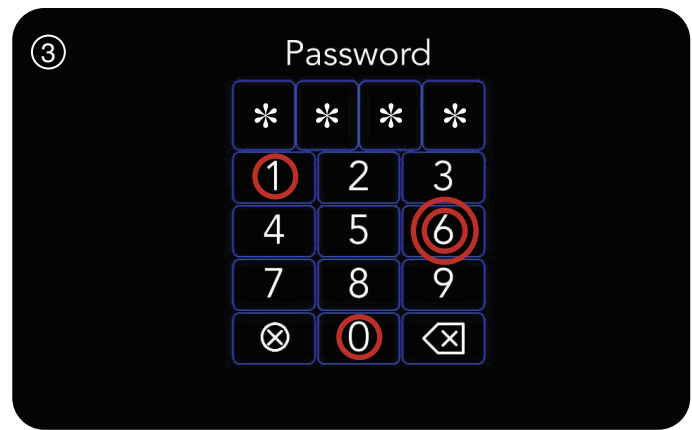

4. Touch the **YOUR BRAND** icon.

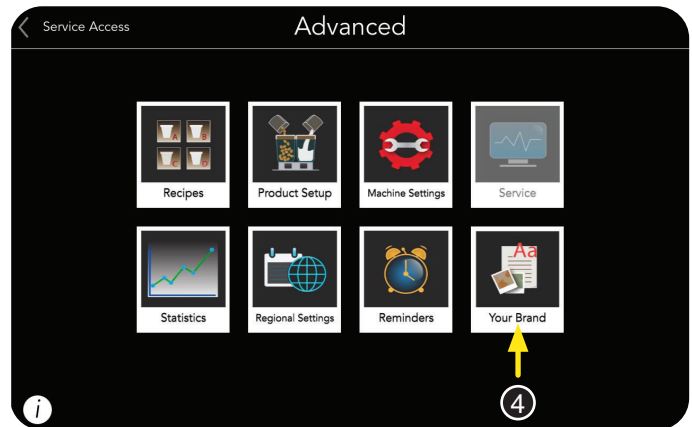

From the **Your Brand** home screen, you can customize the look of your layout.

HOME SCREEN Tab

1. Press **Home Screen** tab to select the area you want to customize.

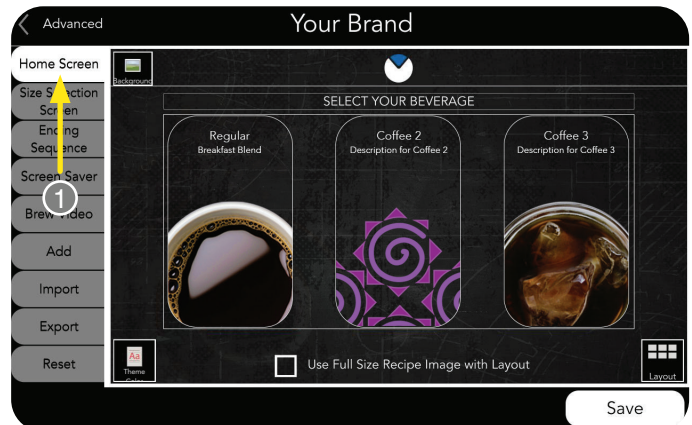

Options Available:

► CHANGE BRANDING LOGO

a. Select **LOGO** field.

NOTE: Logo size should be up to 500 x 53 pixels.

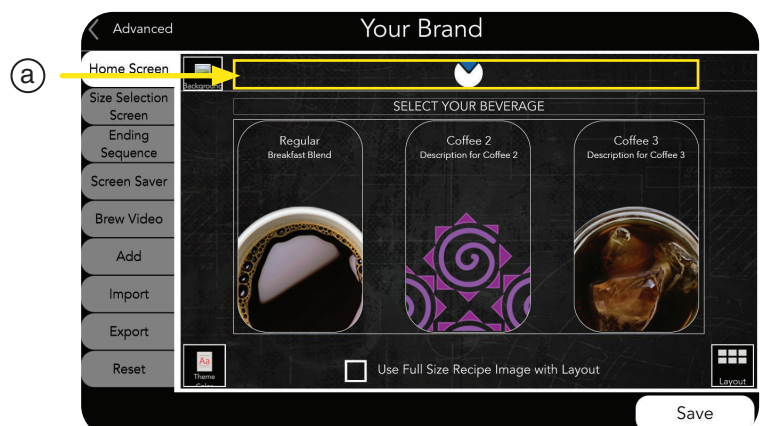

IMPORTING DATA USING USB

- b. The **Branding Logo** screen will appear.

Scroll **side-to-side** to view image library.
Then click selected image.

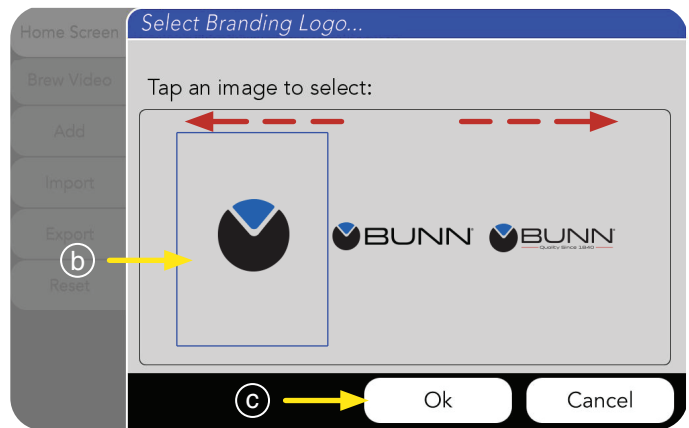

- c. If a new logo is chosen, press **OK**.

► BACKGROUND IMAGE

- a. Select **Background Images** icon.

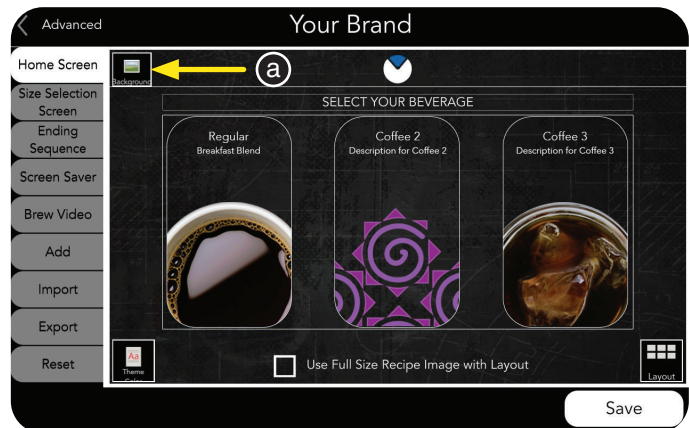

- b. The **Background Images** screen will appear.

By swiping **side-to-side**, you can see the image library.

Press the chosen **Background Image**.

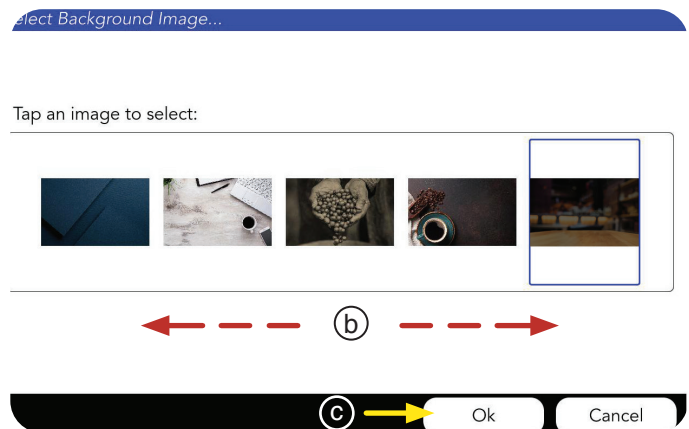

- c. If a new image is chosen, press **OK**.

► THEME COLOR

- a. Select icon to change **Theme Color**.

NOTE: The **Theme** currently says "Select Your Beverage". If the **Theme Color** icon is selected, the color of this text and the beverage descriptions will be changed.

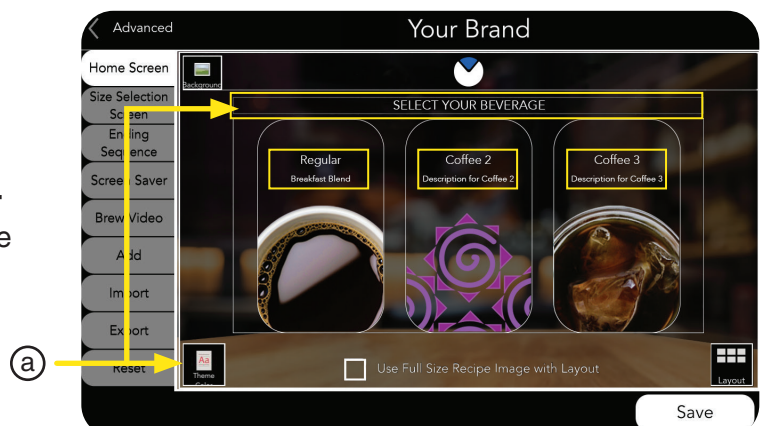

IMPORTING DATA USING USB

Accessing Imported Images & Videos (continued)

- i. The color picker will appear.
Use the **sliders** to choose a color.

- b. If a new color is chosen, press **Save**.

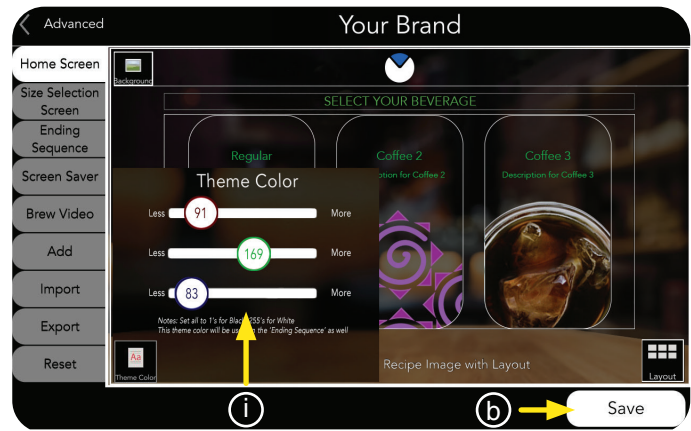

► BEVERAGE ICON LAYOUT

- a. Select icon to change **Layout** of Beverage Icons.

NOTE: This example shows the current layout.

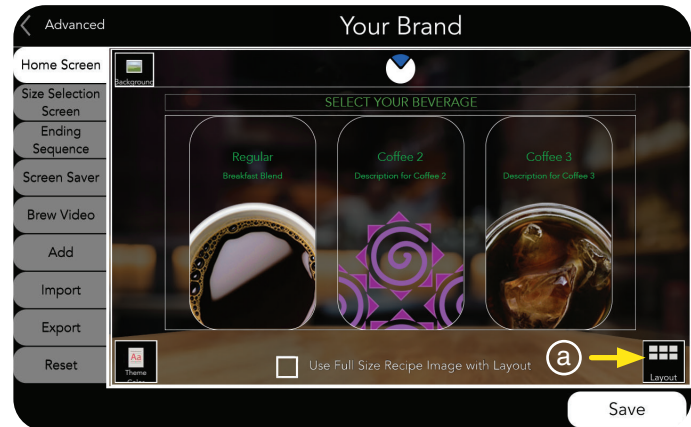

- b. **Layout** screen appears.

- i. To change the columns and rows of the beverage icons, select the **Plus** or **Minus** buttons to edit the numbers.

NOTE: Images will conform to the size selected. The optimal size for the layout selected is shown in the upper right corner of the screen.

- c. If a new layout is chosen, press **OK**.

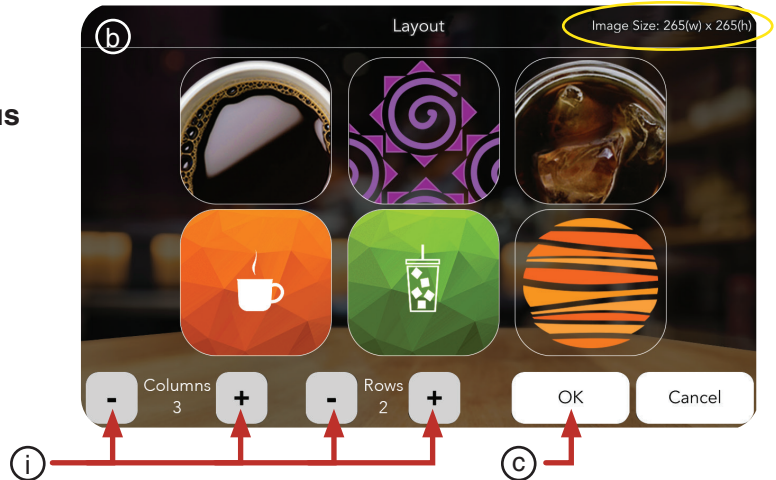

- d. To enable **Full Size Recipe Images with Layout**, check box.

- e. Select **Save** if any changes were made.

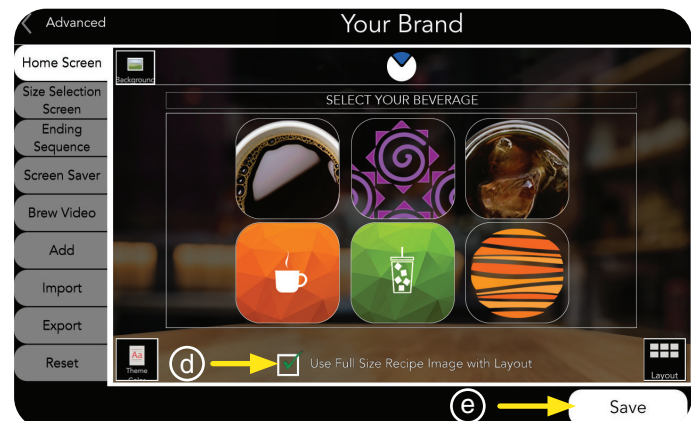

IMPORTING DATA USING USB

SIZE SELECTION SCREEN Tab

1. Press **Size Selection Screen** tab to select the area you want to customize.

Options Available:

► SHOW IMAGES

- a. Check box to **Show Image**.
- b. Check box to show image.

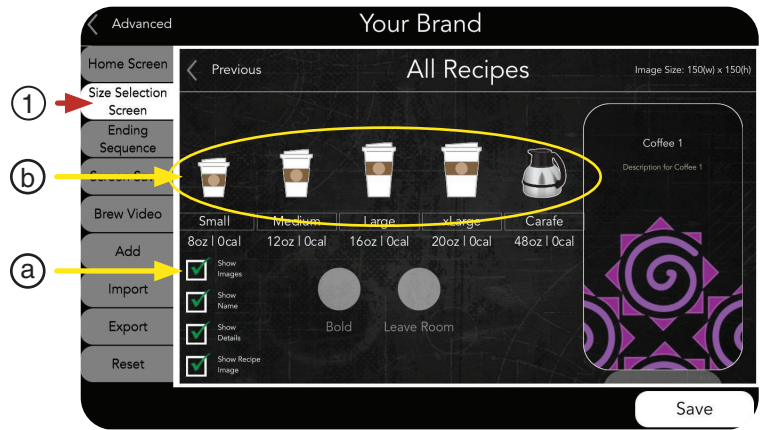

The **Container Images** screen will appear.

By swiping **side-to-side**, you can see the image library.

- c. Press the chosen Image.

- d. If a new image is chosen, press **OK**.

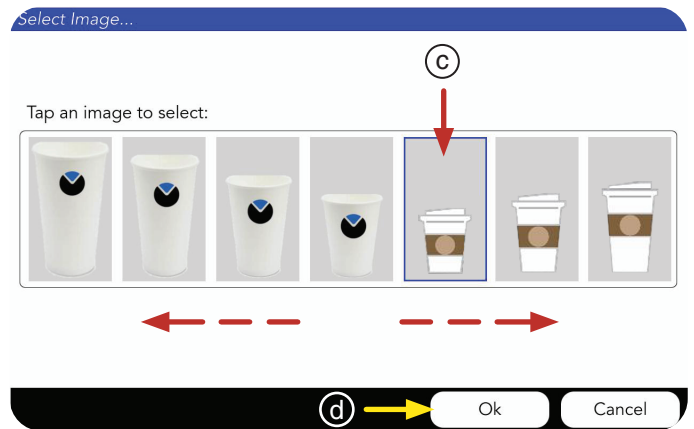

► SHOW NAME

- a. Check box to **Show Name**.
- b. By pressing **Cup Size Name** text fields, an input screen will appear for each name selected.



- c. Type the description.

- d. Press the **Return** key to complete.

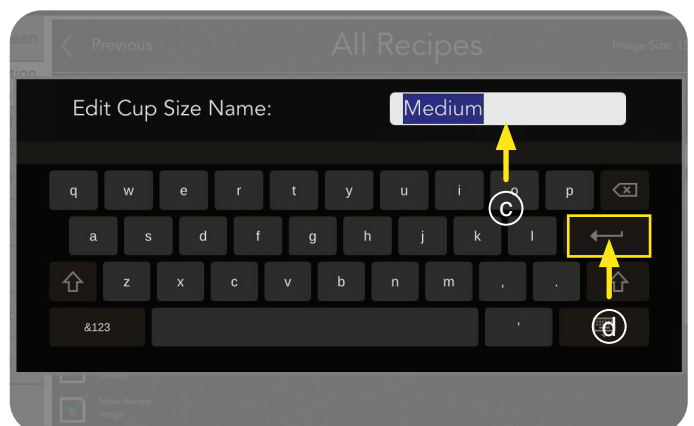

IMPORTING DATA USING USB

SIZE SELECTION SCREEN Tab (continued)

Options Available:

► SHOW DETAILS

- Check box to **Show Details**.
- Beverage details can be edited within **Product Setup**. See page 5 for steps.



► SHOW RECIPE IMAGE

- Check box to **Show Recipe Image**.
- Beverage details can be edited within **Recipe Setup**. See page 12 for steps.
- Select **Save** if any changes were made.



ENDING SEQUENCE Tab

- Select **Ending Sequence** tab.
- Check the box to enable the **“Show Ending Sequence”**.

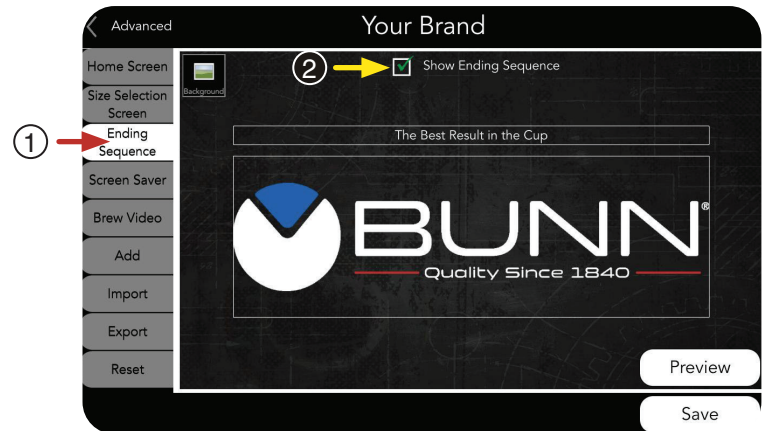

Options Available:

- ##### ► CHANGING BACKGROUND
- Select **Background** icon.

NOTE: Background Image size should be 1024 x 1280 pixels.

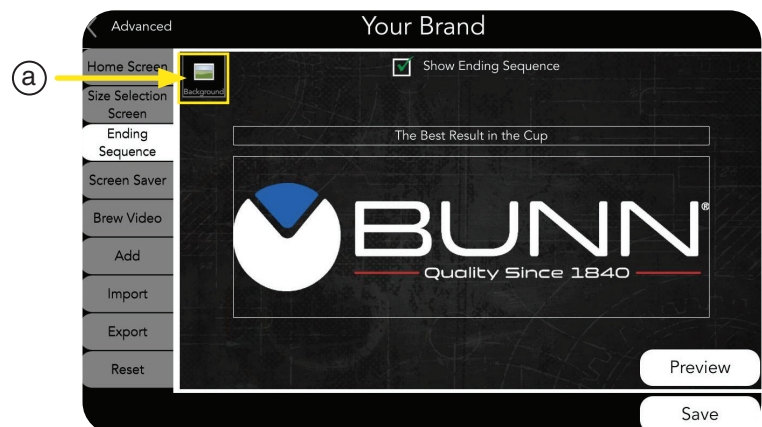

IMPORTING DATA USING USB

- b. Scroll **side-to-side** to view image library. Then click selected image.
- c. Select **OK**.

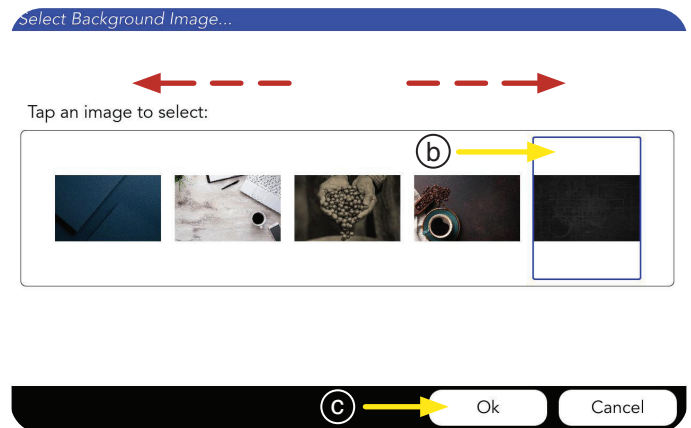

► END OF SEQUENCE BANNER

- a. Select **End of Sequence** field.

NOTE: End of Sequence Banner size should be 948 x 400 pixels.

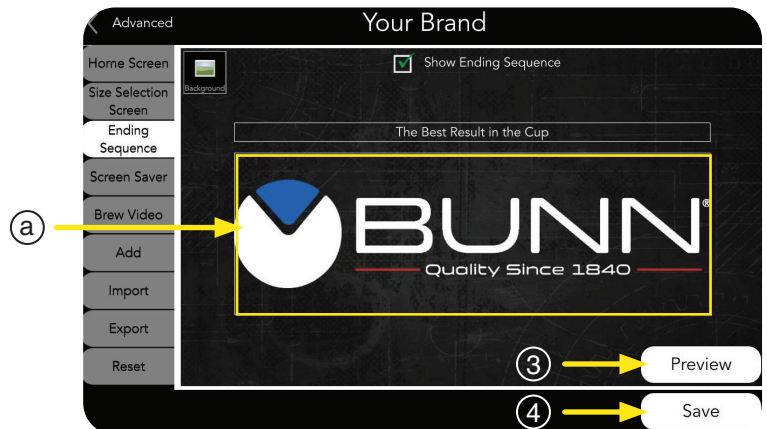

- b. Selection Screen will open. Scroll **side-to-side** to view image library. Then click selected image.
- c. Press **OK**.

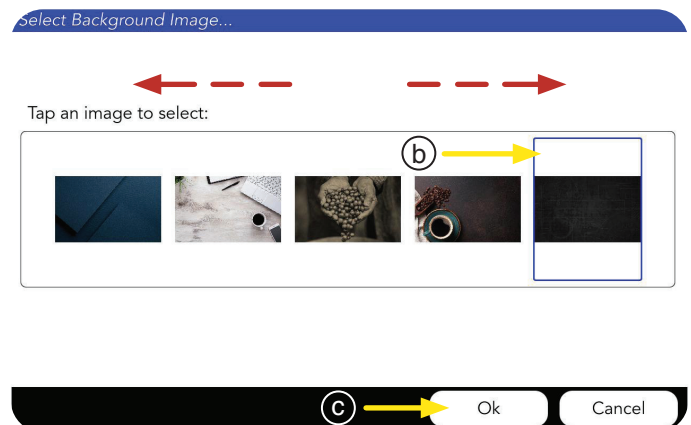

3. The **Preview** button can be selected after any edits to view changes.
4. Select **SAVE** when edits are complete.

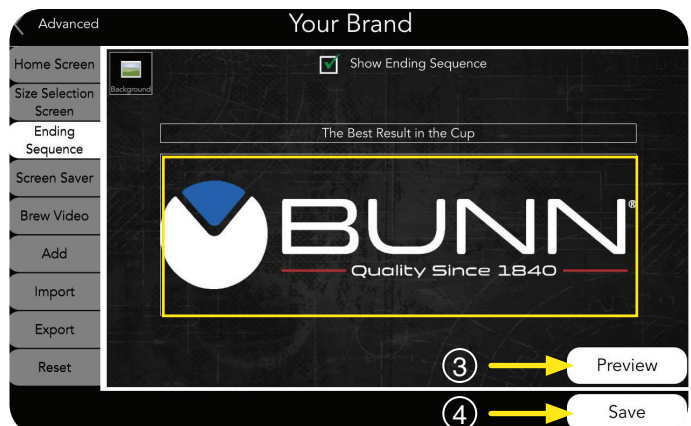

IMPORTING DATA USING USB

SCREEN SAVER Tab

1. Select **Screen Saver** tab.
2. Check **Screen Saver Enable** box.

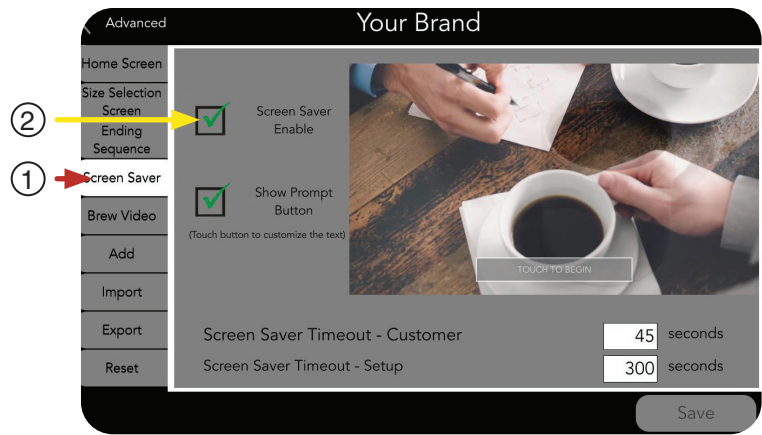

Options Available:

► CHANGING SCREENSAVER IMAGE

- a. Select **Screen Saver** image.

NOTE: Screen Saver size should be 1024 x 1280 pixels.

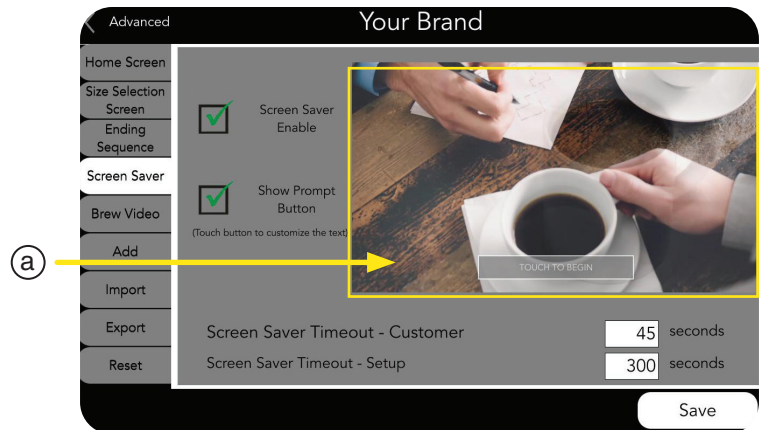

- b. A selection screen will open. If there are more images available than shown, scroll **side-to-side** to view library. Then click selected image.

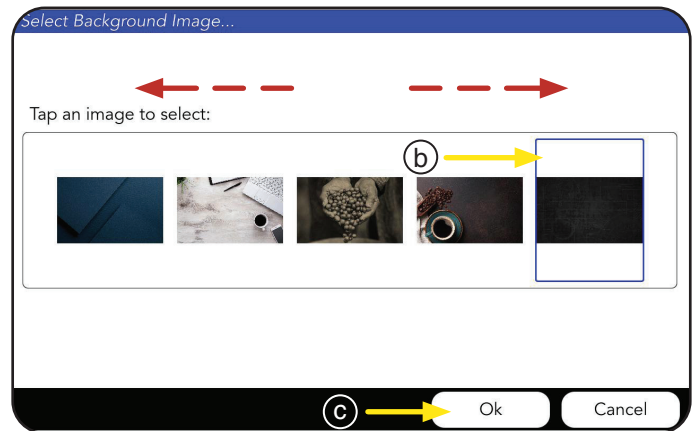

- c. Press **OK**.

► SHOW PROMPT BUTTON

- a. Select **Show Prompt Button** box.

- b. Select **Prompt Button** to edit text.

- c. Select **Save**.

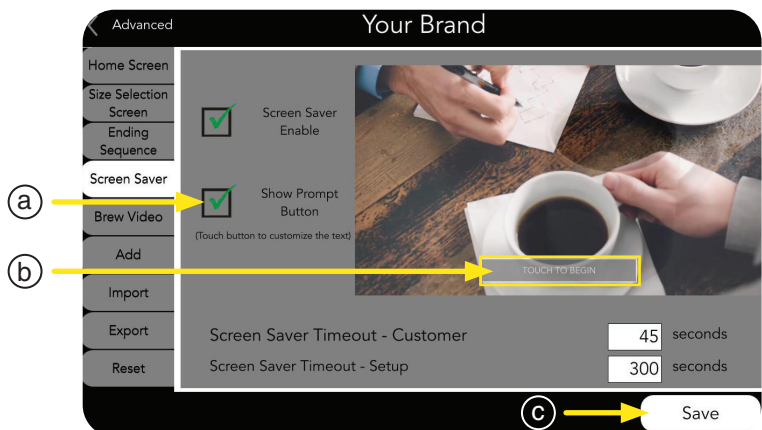

IMPORTING DATA USING USB

3. Select either **Screen Saver Timeout** field.
 - **Customer** field edits seconds after customer dispenses beverage.
 - **Setup** field edits seconds after machine, while in setup mode.

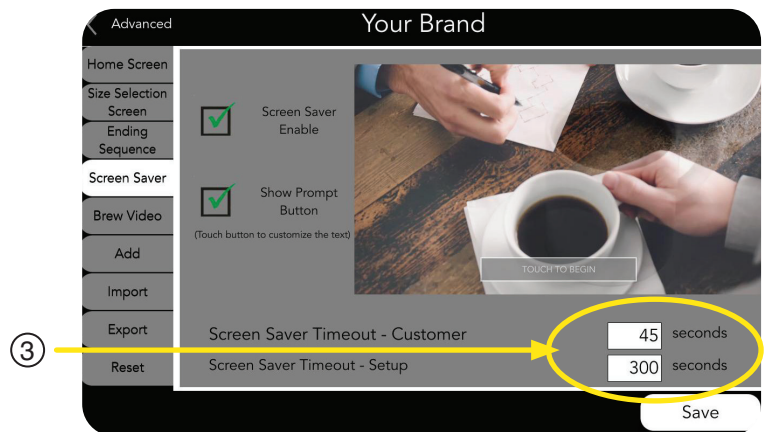

4. Change time in **Input Field**.

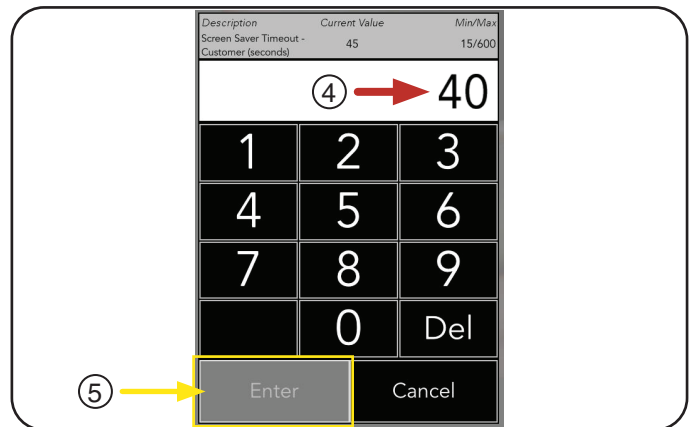

5. Select **Enter**.

6. Select **Save**

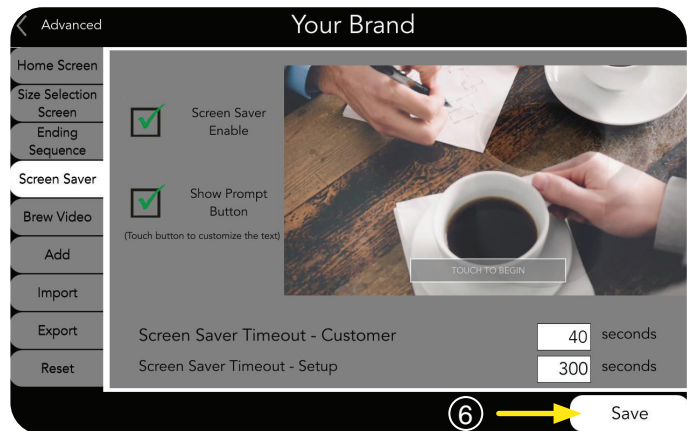

BREW VIDEO Tab

1. Select **Brew Video** tab.
2. Click on preview area to view available videos.

NOTE: Brewing video size should be 1024 x 1120 pixels.

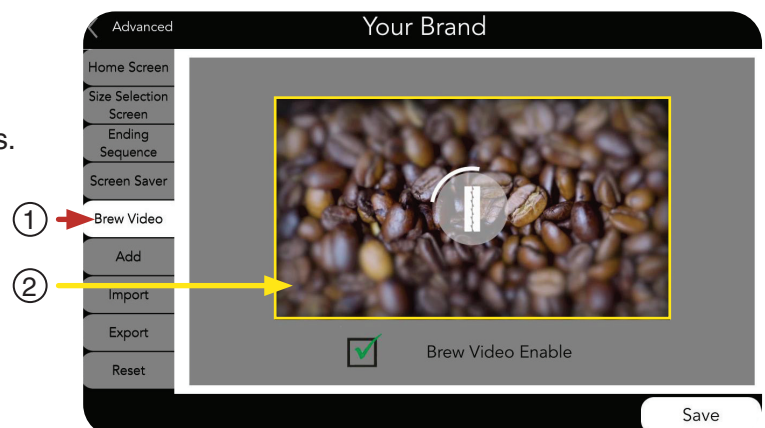

IMPORTING DATA USING USB

BREW VIDEO Tab (Continued)

- a. A selection screen will open. If there are more videos available than shown, scroll **side-to-side** to view library. Then click selected image.
- b. Press **OK**.

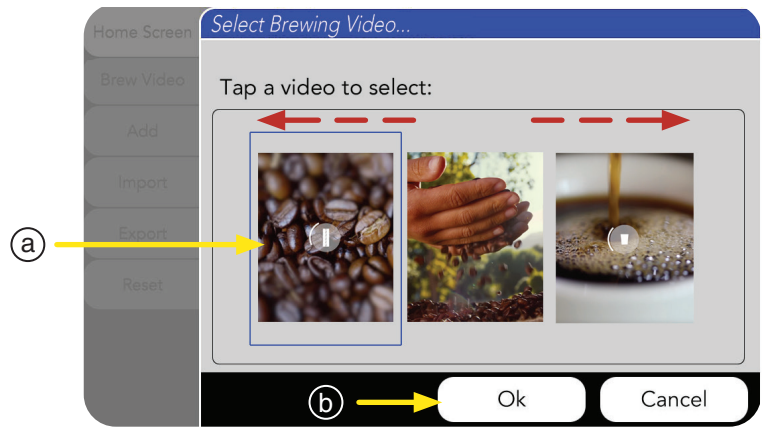

- 3. **Brew Video Enable** box must be checked to make **Brew Video** active.

- 4. Select **Save**.

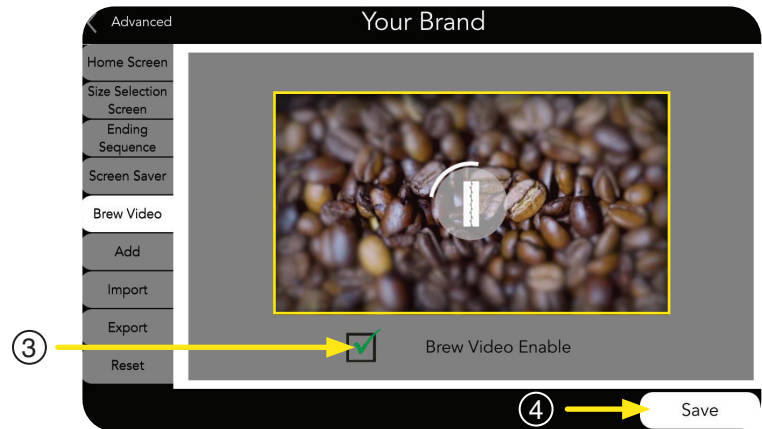

ADD Tab

NOTE: The **ADD** tab should be used by people approved to make changes since your customers will see the changes.

► See “Adding to Your Brand” for steps to add new content from a **USB Stick**.

NOTE: This is the 1st step to loading graphics onto a single machine. If you want to setup multiple machines, see page 29 for **Copying Settings from Machine to Machine**.

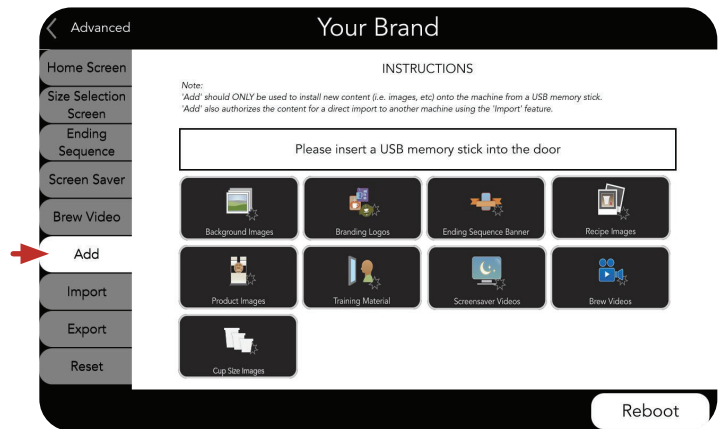

IMPORT Tab

If you have a **USB Stick** with custom configuration files, use the **Import** tab to move them to multiple machines.

- 1. Press the **IMPORT** tab.

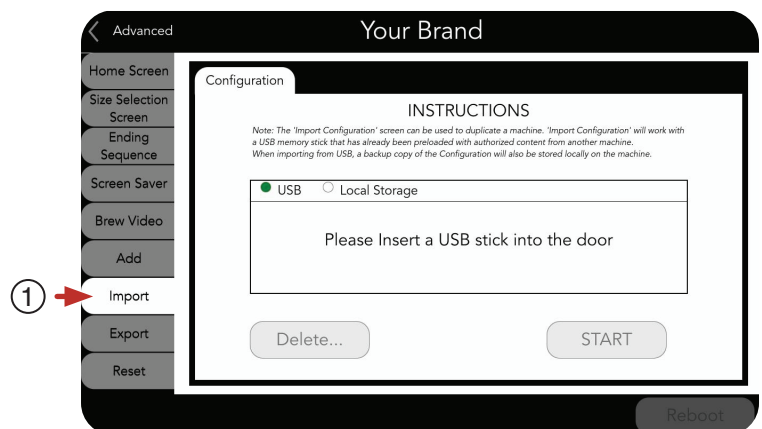

IMPORTING DATA USING USB

2. Insert **USB Stick**.

NOTE: The **USB port** is located behind left side of the touch screen.



3. Select new **Configuration** file.

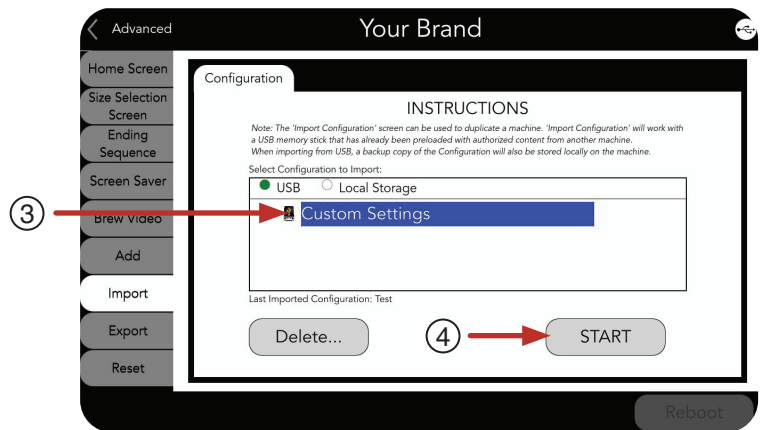

4. Press **Start** button.

5. Screen will show progress of file import.

NOTE: Do not remove **USB Stick** while files are copying.

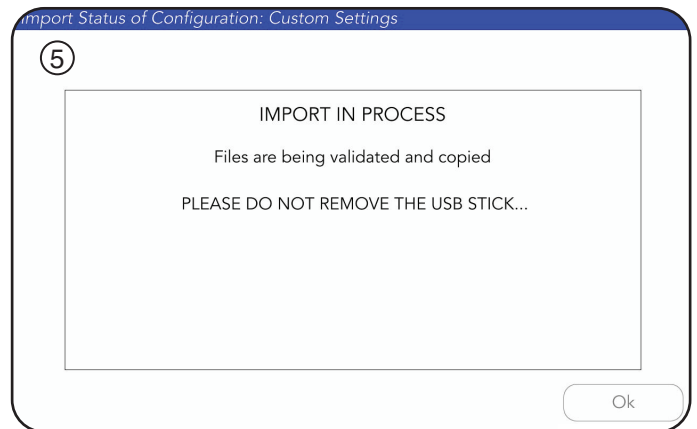

6. When the import is completed, the **OK** button can be selected and the **USB Stick** can be safely removed.

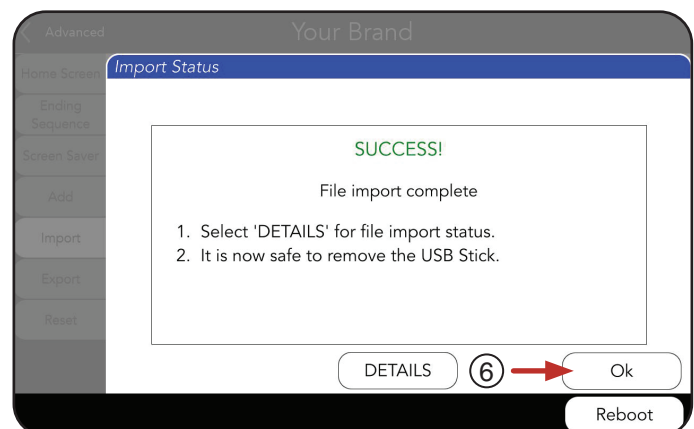

IMPORTING DATA USING USB

IMPORT Tab (Continued)

7. Press **Reboot** button to complete import.

NOTE: This will restart the machine's operating system.



8. The machine will update with your custom **Configuration** files.

After the machine updates, the **HOME** screen should appear, and the **Products** and variables you imported should be available.

You are ready to serve.

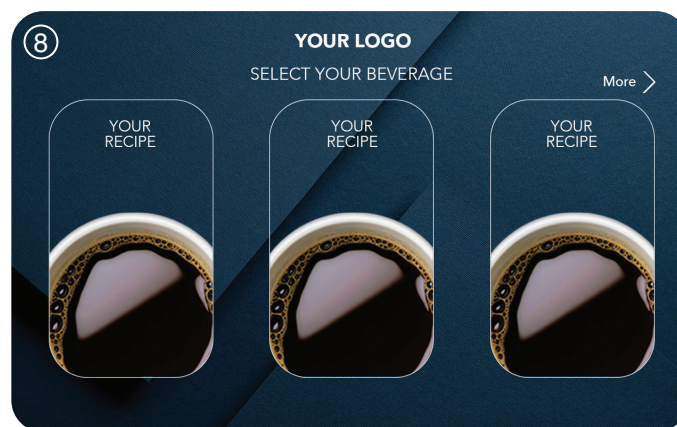

EXPORT Tab

Once a machine is setup, you can Export all of the settings and recipes to a **USB Stick**, and then copy this information to other machines (if they are to be setup the same way).

► See page 29 "Setup of Multiple Machines" for steps to **Export** content to a **USB Stick**.



RESET Tab

CAUTION: The Reset Select screen should **ONLY** be used by **AUTHORIZED ADVANCED** users. It is to be used to Reset/Delete **SPECIFIC** custom content that has been added to the machine.

Pressing **ANY** active button will immediately Reset/Delete the content.

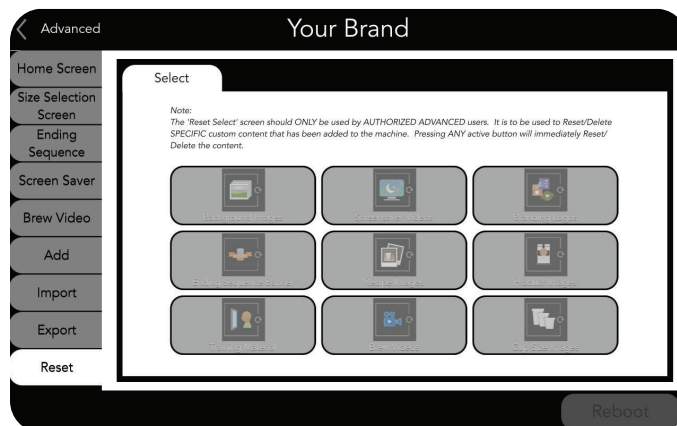

IMPORTING DATA USING USB

Saving Your Brand Changes

If any updates were made and saved within any of the **Your Brand** sections, complete these steps to implement.

1. Select **ADVANCED**.



2. Select **SERVICE ACCESS**.

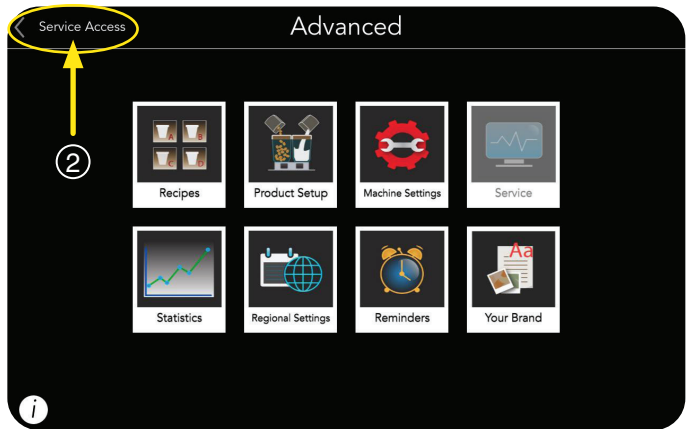

3. Touch and hold the **BUNN** logo for a few seconds until the screen starts to reset.

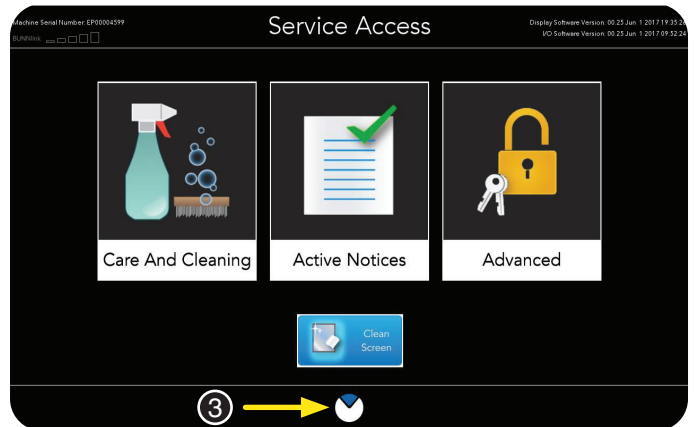

After the machine updates, the **HOME** screen should appear and the products and variables you just added should be available.

You are ready to serve.

NOTE: If you have more than eight **Beverages** set up, and you don't see all of them on the screen, either swipe **side-to-side by pressing the images**, or press the **More Arrow** on the bottom right corner to scroll through.

ENJOY.

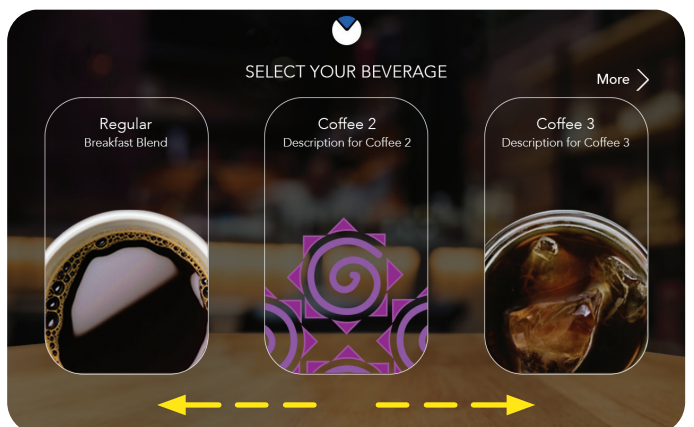

REMINDERS

Options Available:

Cleaning, Preventive Maintenance and Water Filtration

1. Touch and hold the **BUNN** logo for a few seconds until the **SERVICE ACCESS** screen appears.

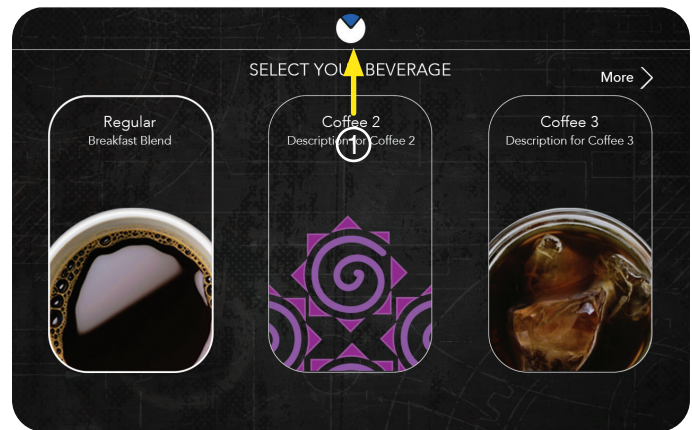

2. Select the **ADVANCED** icon.

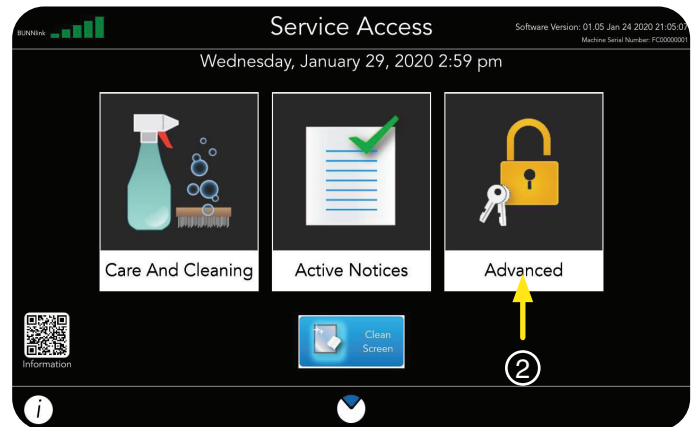

3. Enter the passcode **6601**.

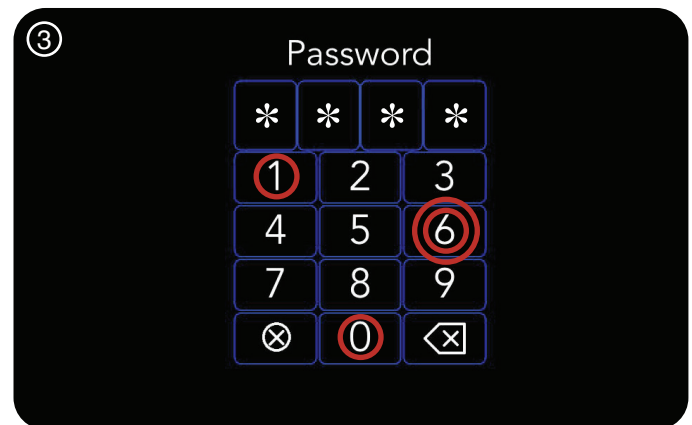

4. Press the **REMINDERS** icon.

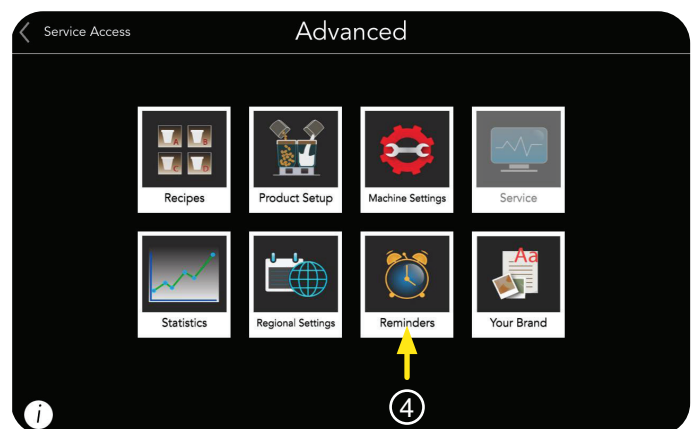

REMINDERS

▶ CLEANING TAB

1. Select **CLEANING** Tab.
2. Use the **drop down** menu to select the preferred **Day of the Week** to clean.

NOTE: The default day is Monday.

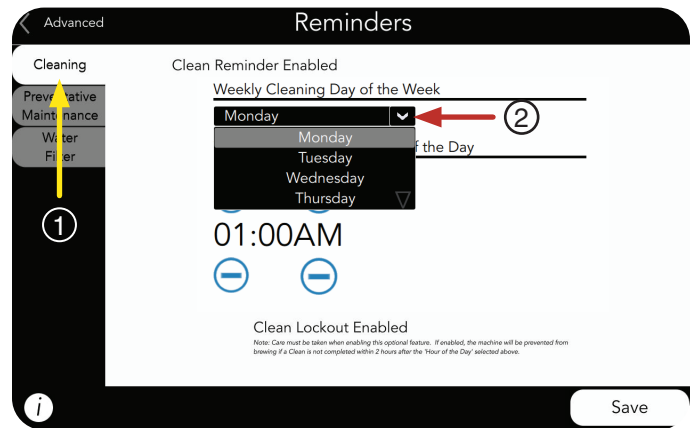

3. Next, press the **+** and **-** symbols to change the **Time**, then **AM** or **PM**.

NOTE: The default time is 1:00 am.

4. Press **SAVE** if changes are made.
5. Press **ADVANCED** to return to **SERVICE ACCESS** screen.

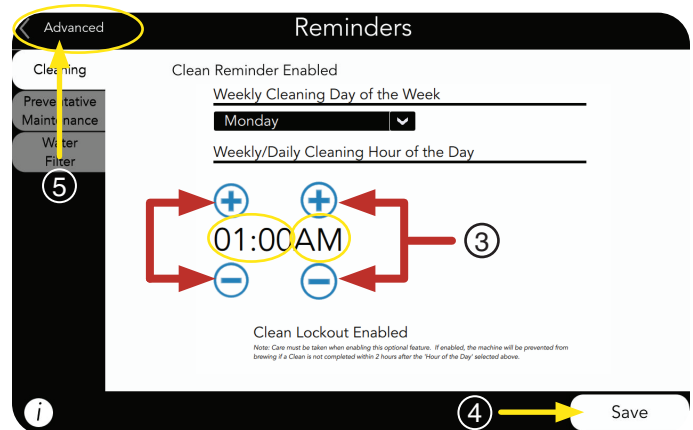

▶ PREVENTATIVE MAINTENANCE TAB

1. Select **PREVENTATIVE MAINTENANCE** Tab.

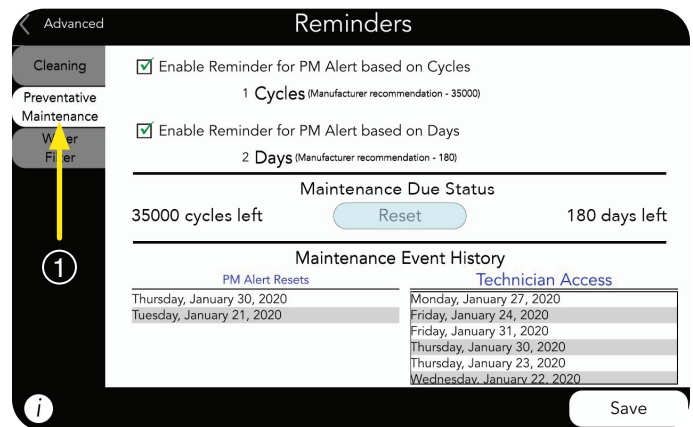

2. *Enable Reminder for PM Alert based on Cycles* is checked as a default.

②

3. *Enable Reminder for PM Alert based on Days* is checked as a default.

③

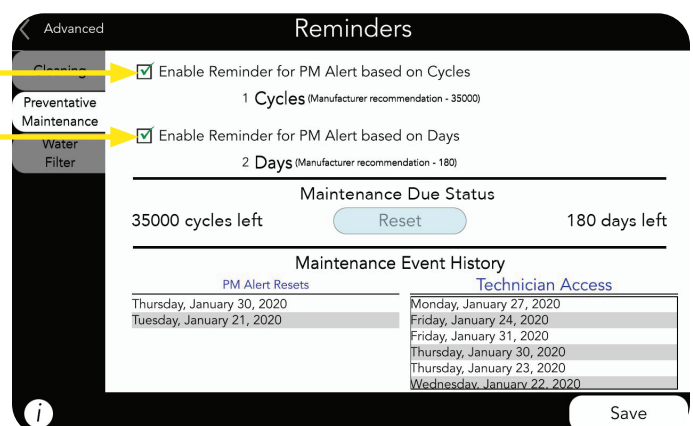

REMINDERS

► PREVENTATIVE MAINTENANCE TAB (Continued)

- If recommended PM **Cycles** or **Days** are running out, the screen will show countdown(s) in red.

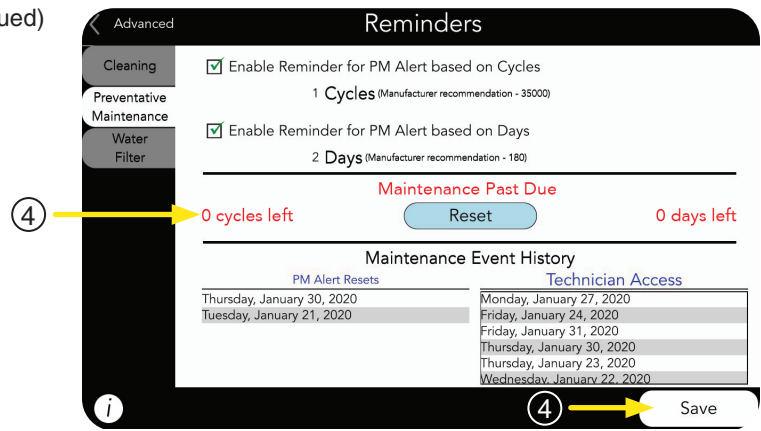

- The PM alert will also show on the Service Access screen.

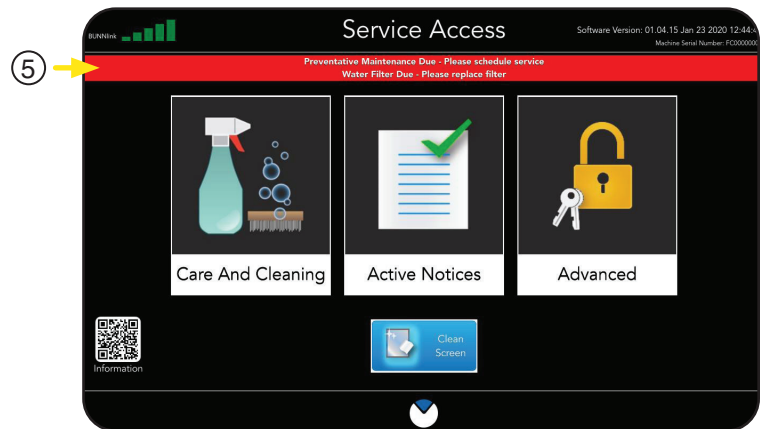

- When PM service is completed, press the **Reset** button.

- Press **SAVE** if changes are made.

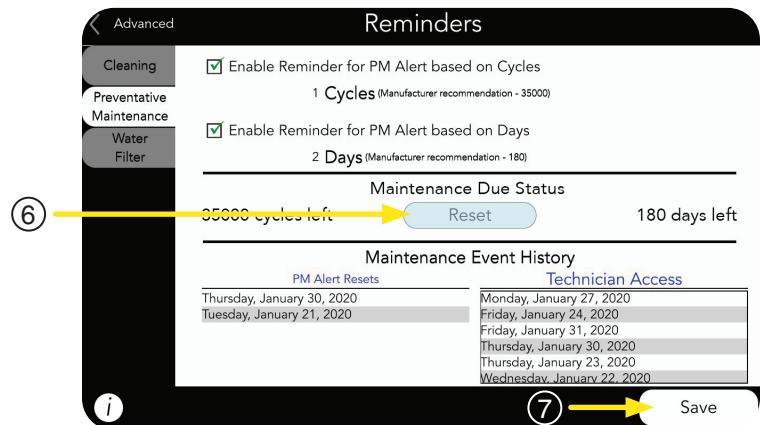

► WATER FILTER TAB

- Select **WATER FILTER** Tab.

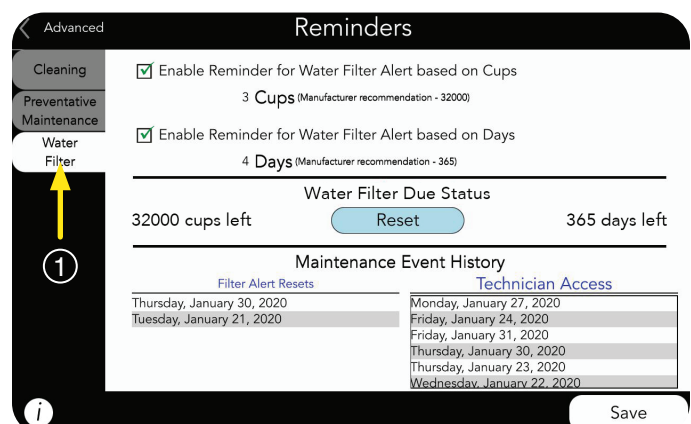

REMINDERS

2. Enable Reminder for Water Filter Alert based on Cups is checked as a default.
3. Enable Reminder for Water Filter Alert based on Days is checked as a default.

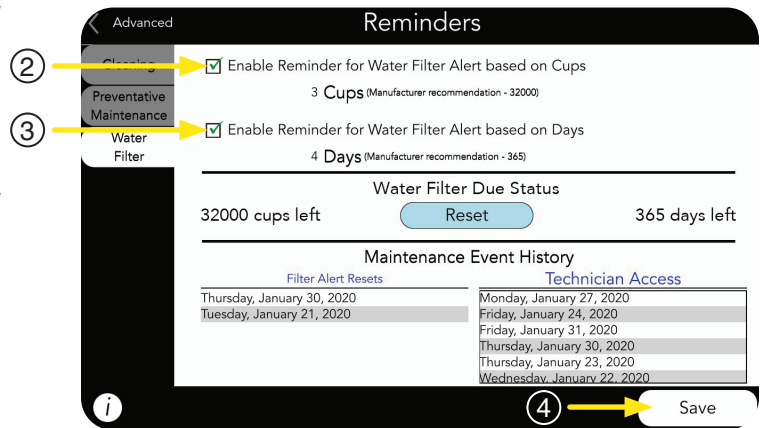

4. If recommended **Cups** or **Days** are running out, the screen will show countdown(s) in red.

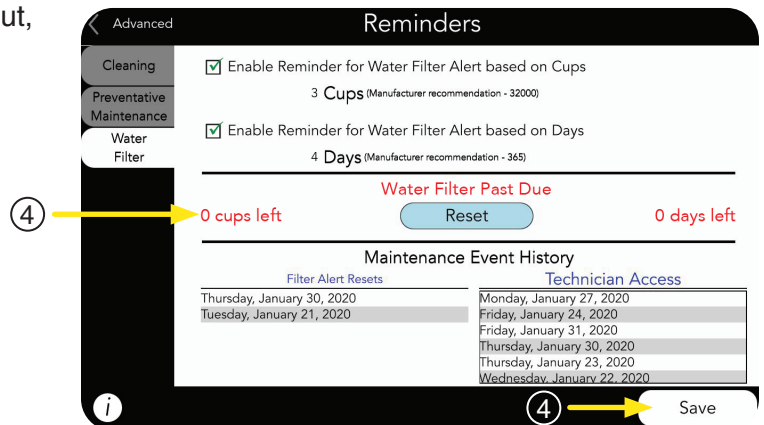

5. The Water Filter alert will also show on the Service Access screen.

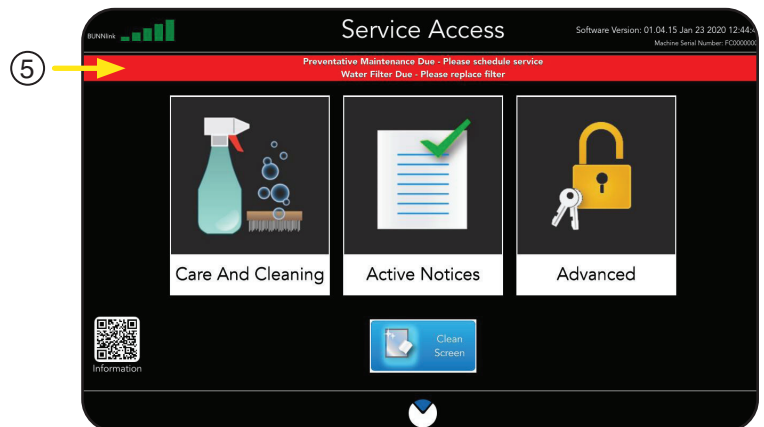

6. After a new Water Filter is installed, press the **Reset** button.
7. Press **SAVE** if changes are made.

