



EMEA CATALOGUE



2020 EQUIPMENT CATALOGUE



QUALITY SINCE 1840™

Bunn-O-Matic Corporation® can trace its foundation to 1840 when Jacob Bunn opened his grocery store in a developing Springfield, IL USA, and a young Abe Lincoln was one of his first customers.

That venture grew into Bunn Capitol Wholesale Grocery Company and was later managed by George R. Bunn who founded a beverage equipment division in the late 1950s. Bunn-O-Matic Corporation was officially incorporated as a separate entity in 1963, and since that time has been at the forefront of dispensed beverage equipment manufacturers.

The company remains privately-held and family-owned through five generations of Bunn family entrepreneurship. It has evolved from a foodservice and coffee focus to include a long list of equipment innovations in all dispensed beverage categories. Now often referred to simply as “BUNN,” the company has become a global partner you can count on for profitability, reliability and support wherever customers are served.

TABLE OF CONTENTS

BREWED BEVERAGES

COFFEE	5
<i>Infusion Series® Brewers</i>	5
<i>Pourover Brewers</i>	8
<i>Axiom® Brewers</i>	11
<i>Urn Brewers</i>	13
<i>TF Brewers</i>	14
<i>Thermal Brewers</i>	16
GRINDERS	24
BEAN-TO-CUP	31
COFFEE & TEA COMBOS	33

DISPENSED BEVERAGES

COLD COFFEE	36
HOT CHOCOLATE/CAPPUCCINO	38
HOT WATER	41
FROZEN GRANITA/SLUSHY	45

ACCESSORIES/EXTRAS

SERVING & HOLDING	48
PAPER FILTERS	58
ACCESSORIES	60

DID YOU KNOW THAT WE HAVE LOCATIONS
AROUND THE WORLD TO SERVE YOU?



CANADA - AURORA, ONTARIO • MEXICO - MEXICO CITY • GERMANY - BERLIN • BRAZIL - SÃO
PAULO • UNITED KINGDOM - BIRMINGHAM • CHINA - SHANGHAI • CHINA - SHENZHEN

AGENCY SYMBOLS

 NSF International

 Electrical Testing
Labs Sanitation

 Electrical Testing
Labs Safety

 EurAsian
Conformity Mark

KSA* Kingdom of
Saudi Arabia

 CE Listed

 UL LISTED UL Listed

ECAS* UAE

KUCAS* Kuwait



ELECTRICAL PLUGS



AUSTRALIA
CCC



NEMA-5-15P



EURO CE



IRAM

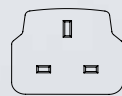

UK CE

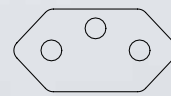

INMETRO

*FOR KSA, KUCAS, AND ECAS EQUIPMENT, PLEASE CONTACT YOUR BUNN SALES REPRESENTATIVE

A glass mug filled with dark coffee sits on a dark surface, surrounded by scattered coffee beans. The image is overlaid with a blue geometric pattern of overlapping shapes. The word "COFFEE" is written in white, uppercase letters across the front of the mug.

COFFEE

Infusion Series® Platinum Edition®

The New Infusion Series Platinum Edition line of brewing equipment is equipped with an intuitive 4.3" touch screen, providing an enhanced user experience when operating and programming the brewers

ICB DV, ICB DV TALL AND ICB TF

Intuitive 109cm touchscreen with user interface provides an enhanced experience when operating and programming the brewers

The powerful duo of a BUNN-exclusive Peak Extraction™ Sprayhead coupled with SmartWAVE® technology delivers increased turbulence in the coffee bed, unrivaled uniformity of extraction, and complexity in the finished beverage

USB port for easy programming

Digital readout displays in English, Spanish, or French—for easier programming and control

Electronic funnel lock prevents removal of each brew funnel until drip-through is complete

ICBA PE is compatible with new TF 1.8L and 3.8L ThermoFresh® Servers (with Base), all previous generations of TF 5.7L TF Servers (with Base), Titan® 5.7L servers, and Airpots



ICBA PE

 Servers sold separately

DESCRIPTION						CAPACITY	ELECTRICAL					AGENCY		
Product #	Model	Finish	Funnel Type	Dimensions Height x Width x Depth (Centimeters)			236mL cups/hr	Volts	Amps	Watts	Hertz	Phase	Plug	Listing
53300.0500	ICBA PE	STAINLESS	BLACK/SMART	68.10	25.40	56.13	141	220-240	11-12	2400-2900	50-60	1	EURO	CE
53300.0501	ICBA PE	STAINLESS	BLACK/SMART	68.10	25.40	56.13	141	220-240	11-12	2400-2900	50-60	1	UK	CE

SOLD SEPARATELY



Single/Dual Filter Pack
20138.1000

Inlet Hose Assembly
32865.1002



Servers

Legs
00511.0000

Infusion Series® Standard Edition

The Infusion Series coffee and tea equipment platform provides Best Result In The Cup™ performance with the proven industry knowledge to deliver the lowest cost of ownership

ICBA

Three brew buttons for three separate brewing profiles; two programmable switches for full and half batches

Designed to brew into 2.5-3.8L airpots or 3.8L and 5.7L ThermoFresh® servers without stand

The exclusive Peak Extraction® Sprayhead features grooves that capture minerals and isolate the directional stream holes which then spray the whole coffee bed, providing full saturation and the ideal uniformity of extraction.



ICB

Servers sold separately

DESCRIPTION		CAPACITY					ELECTRICAL					AGENCY		
Product #	Model	Finish	Funnel Type	Dimensions Height x Width x Depth (Centimeters)			236mL cups/hr	Volts	Amps	Watts	Hertz	Phase	Plug	Listing
53100.0501	ICBA	STAINLESS	BLACK/SMART	68.10	25.40	55.90	141	220-240	11-12	2400-2900	50-60	1	UK	CE
53100.0502	ICBA	STAINLESS	BLACK/SMART	68.10	25.40	55.90	141	220-240	11-12	2400-2900	50-60	1	EURO	CE
53100.0509	ICBA	STAINLESS	BLACK/SMART	68.10	25.40	55.90	141	220-240	11-12	2400-2900	50-60	1	ME	CE

SOLD SEPARATELY



Single/Dual Filter Pack
20138.1000

Inlet Hose Assembly
32865.1002



Servers

Legs
00511.0000



Infusion Series® Soft Heat® Edition

BUNN-exclusive Soft Heat technology supplies controlled heat to the brewed coffee within the server whenever it's docked on the brewer, ensuring ideal holding temperatures and optimal flavor for longer periods

Sleek modernized design language on the brewer and servers

The exclusive Peak Extraction® Sprayhead features grooves that capture minerals and isolate the directional stream holes which then spray the whole coffee bed, providing full saturation and the ideal uniformity of extraction.

Three brew buttons and three batch sizes allow for multiple brewing profiles

Easy Pulse programming automatically adjusts contact time for optimal flavor profile

Compatible with BrewWISE® intelligence

Wireless Server monitoring on some models allows for remote tracking of coffee freshness on mobile devices

New Infusion Soft Heat® servers [sold separately] are ergonomic, lighter weight, energy efficient and now offer programmable recipe/ batch based holding times and temperatures, alerting staff when freshness has expired or server is empty

Compatible with new Infusion SH servers, new TF 5.7L ThermoFresh® Servers (with Base), and all previous generations of TF 5.7L TF Servers (with Base)



Infusion Series®
Soft Heat® Stainless

 Servers sold separately

DESCRIPTION					CAPACITY		ELECTRICAL					AGENCY		
Product #	Model	Finish	Funnel Type	Dimensions Height x Width x Depth (Centimeters)			236mL cups/hr	Volts	Amps	Watts	Hertz	Phase	Plug	Listing
51100.0500	ICBA SH	STAINLESS	BLACK/SMART	83.3	30.00	59.40	163	220-240	13.2-14.1	2900-3400	50-60	1	EURO	CE

SOLD SEPARATELY



Single/Dual Filter Pack
20138.1000

Inlet Hose Assembly
32865.1002



Servers
27850.0200



Pourover Decanter Brewer 2 Warmer - VP17A-1

Ideal simple switch control office coffee service that does not require plumbing or special wiring

Space-saving design; under 45.2cm tall

SplashGard® funnel deflects hot liquids away from the hand

Pourover brewer requires no plumbing – completely portable



VP17A-1

Servers sold separately

DESCRIPTION		CAPACITY			ELECTRICAL						AGENCY		
Product #	Model	Warmers	Dimensions Height x Width x Depth (Centimeters)			236mL cups/hour	Volts	Amps	Watts	Hertz	Phase	Plug	Listing
13300.0024	VP17A-1	1 LOWER	43.94	21.59	44.96	93*	220-240	9-9.9	2000-2375	50-60	1	EURO	CE
13300.0058	VP17A-1	1 LOWER	43.94	21.59	44.96	93*	220-240	9-9.9	2000-2375	50-60	1	No	KSA KUCAS ECAS

SOLD SEPARATELY



Regular Filter Pack
20115.0000



Decanters



Pourover Decanter Brewer 1 Warmer - VP17A-2

Ideal simple switch control office coffee service that does not require plumbing or special wiring

Two separately controlled warmers

SplashGard® funnel deflects hot liquids away from the hand

Pourover brewer requires no plumbing – completely portable



VP17A-2

 Servers sold separately

DESCRIPTION		CAPACITY			ELECTRICAL						AGENCY		
Model	Product #	Warmers	Dimensions Height x Width x Depth (Centimeters)			236mL cups/hr	Volts	Amps	Watts	Hertz	Phase	Plug	Listing
13300.0015	VP17A-2	1 UPPER/ 1 LOWER	48.01	21.59	45.21	104*	220-240	9.5-10.4	2100-2500	50-60	1	EURO	CE
13300.0041	VP17A-2	1 UPPER/ 1 LOWER	48.01	21.59	45.21	104*	220-240	9.5-10.4	2100-2500	50-60	1	UK	CE
13300.0059	VP17A-2	1 UPPER/ 1 LOWER	48.01	21.59	45.21	104*	220-240	9.5-10.4	2100-2500	50-60	1	No	KSA KUCAS ECAS

SOLD SEPARATELY



Regular Filter Pack
20115.0000



Decanters



Pourover Decanter Brewer 3 Warmers - VP17A-3

Ideal simple switch control office coffee service that does not require plumbing or special wiring

Three separately controlled warmers; two configuration options

SplashGard® funnel deflects hot liquids away from the hand

Pourover brewer requires no plumbing – completely portable



VP17A-3

Servers sold separately 

DESCRIPTION		CAPACITY			ELECTRICAL					AGENCY			
Product #	Model	Warmers	Dimensions Height x Width x Depth (Centimeters)			236mL cups/hr	Volts	Amps	Watts	Hertz	Phase	Plug	Listing
13300.0057	VP17A-3	3 LOWER	43.94	41.66	44.96	120*	220-240	15-16	3290-3800	50-60	1	No	KSA KUCAS ECAS

SOLD SEPARATELY



Regular Filter Pack
20115.0000



Decanters

AXIOM® Automatic 3 warmers

Plumbed, medium volume brewing solution with Digital Brewer Control™ for precise extraction control

Large 5.9L tank provides back-to-back brewing capacity

For high lime areas, BrewLOGIC® technology calculates flow rate and adjusts brew time to maintain consistent pot levels

Coffee extraction, pot level, cold brew lock-out and tank temperature controlled with programmable features

Electronic diagnostics and built-in tank drain simplify maintenance and service

Energy Saver Mode



AXIOM-3

 Servers sold separately

Product #	Model	DESCRIPTION			CAPACITY			ELECTRICAL					AGENCY
		Warmers	Funnel Type	Dimensions Height x Width x Depth (Centimeters)	236mL cups/hr	Volts	Amps	Watts	Hertz	Phase	Plug	Listing	
38700.0038	AXIOM-3	2 UPPER/ 1 LOWER	STAINLESS	48.01 21.59 54.36	80*	220-240	13.2-14.4	2900-3500	50-60	1	EURO	CE	
38700.0039	AXIOM-3	2 UPPER/ 1 LOWER	STAINLESS	48.01 21.59 54.36	80*	220-240	8.6-9.0	1900-2100	50-60	1	EURO	CE	
38700.0004	AXIOM-3	2 UPPER/ 1 LOWER	PLASTIC	48.01 21.59 54.36	80*	220-240	8.6-9.0	1900-2100	50-60	1	EURO	CE	
38700.0107	AXIOM-3	2 UPPER/ 1 LOWER	STAINLESS	48.01 21.59 54.36	80*	220-240	8.6-9.0	1900-2100	50-60	1	No	KSA KUCAS ECAS	

Plumbing: 138-621 kPa. Machines supplied with 1/4" Male flare fitting. All plumbed models that are CE listed feature backflow prevention.

SOLD SEPARATELY



Regular Filter Pack
20115.0000

Inlet Hose Assembly
32865.1001



Decanters

Automatics with Upper Warmers

Plumbed, medium volume brewing solution with simple switch controls

CWTF35A & CWTF35A

SplashGard® funnel deflects hot liquids away from the hand

Hot water faucet and pourover backup on all models



CWTF-35A

Servers sold separately 

Product #	Model	DESCRIPTION			CAPACITY			ELECTRICAL					AGENCY
		Warmers	Funnel Type	Dimensions Height x Width x Depth (Centimeters)	236mL cups/hr	Volts	Amps	Watts	Hertz	Phase	Plug	Listing	
12950.0277	CWTF35A	2 UPPER/ 1 LOWER	PLASTIC	48.01 21.59 45.21	90*	220-240	14.5-15.8	3200-3800	50-60	1	EURO	CE	
12950.0317	CWTFA	2 UPPER/ 1 LOWER	PLASTIC	48.01 21.59 45.21	84-90*	220-240	10.0-11.0	2200-2600	50-60	1	EURO	CE	
12950.0450	CWTF35A	2 UPPER/ 1 LOWER	PLASTIC	48.01 21.59 45.21	90*	220-240	14.5-15.8	3200-3800	50-60	1	NO	KSA KUCAS ECAS	

Plumbing: 138-621 kPa. Machines supplied with 1/4" Male flare fitting. All plumbed models that are CE listed feature backflow prevention.

SOLD SEPARATELY



Regular Filter Pack
20115.0000

Inlet Hose Asembly
32865.1001



Decanters

Urns

Unique urn brewer design ensures low evaporation loss

U3 TWIN

Two spigots

Large water tank holds over 75.7L

Half-batch option



U3

DESCRIPTION						CAPACITY	ELECTRICAL					AGENCY	
Product #	Model	Funnel Type	Dimensions Height x Width x Depth (Centimeters)			236mL cups/hr	Volts	Amps	Watts	Hertz	Phase	Plug	Listing
20500.0016	U3A	PLASTIC	82.30	87.63	53.34	278	220-240	26.4-28.6	5800-6850	50-60	1	No	CE

Plumbing: 138-621 kPa. Machines supplied with 3/8" Male flare fitting. All plumbed models that are CE listed feature backflow prevention.



Urn Filter Pack
20109.0000



Decanters

SOLD SEPARATELY



Drip Tray (U3)
07284.0000

Inlet Hose Assembly
32865.1001

ThermoFresh® Single®

TF brewers use Digital Brewer Control™ with insulated ThermoFresh servers that hold beverages at optimum temperature without requiring the energy consumption of traditional warming plates

Three variable batch sizes

SplashGard® funnel and funnel locks help improve safety

BrewWISE® intelligence means compatible grinders and a Smart Funnel® can be programmed one time to manage repeated brewing cycles from start to finish

Stores individual coffee recipes so operator can easily brew many varieties



Single TF DBC
Stainless

Servers sold separately

DESCRIPTION								CAPACITY		ELECTRICAL				AGENCY
Product #	Model	Finish	Funnel Type	Dimensions Height x Width x Depth (Centimeters)			236mL cups/hr	Volts	Amps	Watts	Hertz	Phase	Plug	Listing
34800.0009	Single TF DBC	BLACK	SMART	90.68	30.73	48.77	140-182*	220-240	14.5-15.7	3180-3780	50-60	1	EURO	CE NSF
34800.0012	Single TF DBC	STAINLESS	SMART	90.68	30.73	48.77	140-182*	220-240	14.5-15.7	3180-3780	50-60	1	EURO	CE NSF
34800.0033	Single TF DBC	STAINLESS	SMART	90.68	30.73	48.77	140-182*	220-240	14.5-15.7	3180-3780	50-60	1	NO	CE
34800.0035	Single TF DBC	STAINLESS	SMART	90.68	30.73	48.77	140-182*	220-240	14.5-15.7	3180-3780	50-60	1	NO	KSA KUCAS ECAS

Plumbing: 138-621 kPa. Machines supplied with 3/8" Male flare fitting. All plumbed models that are CE listed feature backflow prevention.

SOLD SEPARATELY



Single/Dual Filter Pack
20138.1000



Inlet Hose Assembly
32865.1002

Servers and Stands

ThermoFresh® Dual®

TF brewers use Digital Brewer Control™ with insulated ThermoFresh servers that hold beverages at optimum temperature without requiring the energy consumption of traditional warming plates

Brews 61.7 to 71.5L of coffee per hour

Three variable batch sizes

BrewWISE® intelligence means compatible grinders and a Smart Funnel® can be programmed one time to manage repeated brewing cycles from start to finish

Stores individual coffee recipes so operator can easily brew many varieties



Dual TF DBC

 Servers sold separately

		DESCRIPTION					CAPACITY	ELECTRICAL					AGENCY	
Product #	Model	Finish	Funnel Type	Dimensions Height x Width x Depth (Centimeters)			236mL cups/hr	Volts	Amps	Watts	Hertz	Phase	Plug	Listing
34600.0011	Dual TF DBC	STAINLESS	SMART	90.68	55.37	51.31	302*	220-240	27-29.5	6000-7100	50-60	1	No	CE 
34600.0020	Dual TF DBC	STAINLESS	SMART	90.68	55.37	51.31	276	230	33.5	8000	50-60	1	No	CE
							414	400	16	11125	50-60	3		

Plumbing: 138-621 kPa. Machines supplied with 3/8" Male flare fitting. All plumbed models that are CE listed feature backflow prevention.

SOLD SEPARATELY



Single/Dual Filter Pack
20138.1000

Inlet Hose Assembly
32865.1002



Servers and Stands



SmartWAVE® Thermal

BUNN exclusive brewing technology that increases turbulence in the funnel for enhanced uniformity of extraction

Adjustable low profile product design can accommodate a variety of thermal servers and countertop configurations

Analog switches accompanied by red/green LED for programming and brewing status (Ready, Heating, Brewing)

Choice of 3 pulse brew settings to adjust flavour profile

Energy Saver Mode reduces tank temperature during idle periods

Specialty

Includes Gourmet C funnel for larger throw weights

Large 17-hole sprayhead maximizes uniformity of extraction



WAVE -S-BF-APS
with Gourmet Funnel

Servers sold separately

DESCRIPTION						CAPACITY	ELECTRICAL					AGENCY	
Product #	Model	Funnel Type	Dimensions Height x Width x Depth (Centimeters)			236mL cups/hr	Volts	Amps	Watts	Hertz	Phase	Plug	Listing
39900.0017	WAVE-S-BF-APS Specialty	GOURMET C	47.47	24.66	43.79	84-90*	220-240	8.3-9	1800-2200	50-60	1	EURO	CE

Plumbing: 138-621 kPa. Machines supplied with 1/4" hose thread adapter and fitting. All plumbed models that are CE listed feature backflow prevention.



Servers

SOLD SEPARATELY



Gourmet C Funnel
34559.0000



Gourmet Filter Pack
20157.0001

AXIOM® Airpot & Thermal Carafe

Medium volume brewing solution featuring Digital Brewer Control™ for precise extraction control

Brew directly into 1.9 - 3.0L airpots

Programmable Energy Saver Mode reduces operating cost during idle periods

Cold brew lock-out and automatic warmer time-out ensure high quality, fresh tasting coffee

Front of machine programming simplifies installation



AXIOM-APS



AXIOM-TC

 Servers sold separately

DESCRIPTION				CAPACITY		ELECTRICAL					AGENCY		
Product #	Model	Funnel Type	Dimensions Height x Width x Depth (Centimeters)			236mL cups/hr	Volts	Amps	Watts	Hertz	Phase	Plug	Listing
38700.0037	AXIOM-APS	BLACK PLASTIC	59.94	22.86	46.99	90*	220-240	12.5-13.6	2750-3275	50-60	1	EURO	CE
38700.0104	AXIOM-TC	BLACK PLASTIC	45.21	22.86	46.99	90*	220-240	6.7-7.3	1475-1750	50-60	1	EURO	CE

Plumbing: 138-621 kPa. Machines supplied with 3/8" Male flare fitting. All plumbed models that are CE listed feature backflow prevention.



Regular Filter Pack
20115.0000



Servers

SOLD SEPARATELY



Airpots



Gourmet C Funnel
34559.0000



Gourmet Filter Packs
20157.0001



CW Airpot

Simple switch controls and flexible server options

CWTFA

Brew directly into 1.9 to 3.0L airpots

Hot water faucet with pourover backup feature

Digital timer enables users to make cycle adjustments from front panel

CWA

CWA models are pourover only

Gourmet funnel available for use with heavier throw weights of coffee



CWTF-A-APS

Servers sold separately

DESCRIPTION			DIMENSIONS			CAPACITY	ELECTRICAL					AGENCY	
Product #	Model	Funnel Type	Height	Width	Depth	236mL cups/hr	Volts	Amps	Watts	Hertz	Phase	Plug	Listing
POUROVER - NO FAUCET													
23001.0024	CWA-APS	BLACK PLASTIC	59.94	22.86	46.99	84-90*	220-240	8.6-9.5	1900-2300	50-60	1	EURO	CE
23001.0074	CWA-APS Master On/Off	BLACK PLASTIC	59.94	22.86	46.99	84-90*	220-240	8.6-9.5	1900-2300	50-60	1	UK	CE
AUTOMATIC - WITH FAUCET													
23001.0021	CWTF-A-APS	BLACK PLASTIC	59.94	22.86	46.99	84-90*	220-240	8.6-9.5	1900-2300	50-60	1	EURO	CE

Plumbing: 138-621 kPa. Machines supplied with 1/4" Male flare fitting. All plumbed models that are CE listed feature backflow prevention.

SOLD SEPARATELY



Regular Filter Pack
20115.0000

Inlet Hose Assembly
32865.1001



Gourmet C Funnel
34559.0000



Gourmet Filter Pakcs
20157.0001

Thermal Carafe

Brew directly into portable insulated servers that keep coffee at optimal temperature

Accepts thermal carafe up to 21.6cm

Use in quick-turn environment where high quality coffee is continuously refreshed

Simple switch controls

CWA-TC

Pourover brewer requires no plumbing – completely portable

CWTFA-TC

Hot water faucet and pourover backup feature



CWTFA-TC



CWA-TC

 Servers sold separately

DESCRIPTION				CAPACITY		ELECTRICAL					AGENCY		
Product #	Model	Funnel Type	Dimensions Height x Width x Depth (Centimeters)			236mL cups/hr	Volts	Amps	Watts	Hertz	Phase	Plug	Listing
POUROVER - NO FAUCET													
23001.0105	CWA-TC	BLACK PLASTIC	45.47	22.86	46.99	83*	220-240	8.6-9.5	1900-2300	50-60	1	EURO	CE
AUTOMATIC - WITH FAUCET													
12950.0362	CWTFA-TC	BLACK PLASTIC	45.47	22.86	46.99	83*	220-240	8.6-9.5	1900-2300	50-60	1	EURO	CE

Plumbing: 138-621 kPa. Machines supplied with 1/4" Male flare fitting. All plumbed models that are CE listed feature backflow prevention.



Regular Filter Pack
20115.0000

SOLD SEPARATELY

Inlet Hose Assembly
32865.1001



CARAFES



Soft Heat® Single®

BUNN exclusive technology automatically manages heat in the server docking system

Brews 1.9, 3.8 or 5.7L batches

Brews up to 43.2L per hour with three variable batch sizes

Instant power contact with docking station

Metric volume and Celsius temperature settings

BrewWISE® brewer reads the information in the Smart Funnel®, adjusts the recipe, and brews a flavorful batch of coffee



Single SH DBC

Servers sold separately

DESCRIPTION			CAPACITY			ELECTRICAL					AGENCY		
Product #	Model	Funnel Type	Dimensions Height x Width x Depth (Centimeters)			236mL cups/hr	Volts	Amps	Watts	Hertz	Phase	Plug	Listing
33600.0006	SINGLE SH DBC	SMART	90.93	23.62	58.67	169	230	19	4400	50-60	1	No	CE

Plumbing: 138-621 kPa. Machines supplied with 1/4" Male flare fitting. All plumbed models that are CE listed feature backflow prevention.

SOLD SEPARATELY



Single/Dual Filter Pack
20138.1000

Inlet Hose Assembly
32865.1001



Servers and Stands



One Position Drip Tray
(Single/Single SH)
26830.0000

Soft Heat® Dual®

BUNN exclusive technology automatically manages heat in the server docking system

Brews up to 71.5L per hour with three variable batch sizes

Instant power contact with docking station

Metric volume and Celsius temperature settings

BrewWISE® brewer reads the information in the Smart Funnel®, adjusts the recipe, and brews a flavorful batch of coffee



Dual SH

 Servers sold separately

DESCRIPTION			CAPACITY			ELECTRICAL					AGENCY		
Product #	Model	Funnel Type	Dimensions Height x Width x Depth (Centimeters)			236mL cups/hr	Volts	Amps	Watts	Hertz	Phase	Plug	Listing
33500.0008	DUAL SH	SMART	90.93	45.72	53.85	302*	220-240	27.0-29.5	6000-7100	50-60	1	No	CE

Plumbing: 138-621 kPa. Machines supplied with 1/4" Male flare fitting. All plumbed models that are CE listed feature backflow prevention.



Single/Dual Filter Pack
20138.1000

SOLD SEPARATELY



Servers and Stands



Dual Position Drip Tray
(Dual/ Dual SH)
27150.0000



Titan® Dual®

High volume solution using fresh ground coffee and featuring Digital Brewer Control™

Increased brewing capacity

Coffee extraction controlled with pre-infusion and pulse brew, digital temperature control, and large sprayhead; variable bypass controls coffee strength

BrewMETER® allows easy programming of pulse routine

Funnel has 0.8kg capacity and paper filter retainers to eliminate fold-over



Titan Dual

Servers sold separately

DESCRIPTION			CAPACITY			ELECTRICAL					AGENCY		
Product #	Model	Funnel Type	Dimensions Height x Width x Depth (Centimeters)			236mL cups/hr	Volts	Amps	Watts	Hertz	Phase	Plug	Listing
39200.0002	TITAN DUAL	STAINLESS	101.65	90.50	55.22	503	400	16	11125	50-60	3	NO	
						307-366*	220-240	28-33	6200-8000	50-60	1		

Plumbing: 138-621 kPa. Machines supplied with 3/8" Male flare fitting. All plumbed models that are CE listed feature backflow prevention.

SOLD SEPARATELY



Single/Dual Filter Pack
20111.0000

Inlet Hose Assembly
32865.1001

Flavour Label
41745.1000



11.3L Titan Server
39400.0001



5.7L Titan Server
46300.0000





GRINDERS

G Series VH Grinder

Users have 340° of grind resolution on the “no-click” selection dial, giving them complete freedom when dialing-in their ideal grind particle size

Available in .45kg, .91kg and 1.36kg versions. the GVH series features tinted hoppers that are sleek and durable.

Versatile design allows grinding into bags, cans, and cups and other containers to meet a multitude of customer needs

Fast grinding – one pound (.45kg) in about 30 seconds – maximizes speed of service

340° dial resolution for precise tuning of grind particle size

Ergonomic clamp for holding smaller size bags and containers in place for hands-free operation

Easy to use cleaning lever for complete removal of coffee from grind chamber ensures the customer gets all the coffee ground for them

Precision Rockwell 65C hard burrs provide consistency, grind after grind

Bag switch prevents grinding before bag/container is in place

Four-year warranty on grinding burrs



GVH-2

GVH-3

DESCRIPTION						CAPACITY		ELECTRICAL					AGENCY	
Product #	Model	Finish	Dimensions Height x Width x Depth (Centimeters)			Number of Hoppers	Kg per Hopper	Volts	Amps	Watts	Hertz	Phase	Plug	Listing
55600.0201	GVH-2A TURK BURR	STAINLESS	62.50	17.80	40.40	1	.90	220-240	6.5-7.8	990-1080	50	1	EURO	CE
55600.0301	GVH-3A	STAINLESS	65.50	17.80	40.40	1	1.36	220-240	6.5-7.8	990-1080	50	1	EURO	CE
55600.0303	GVH-3A	STAINLESS	65.50	17.80	40.40	1	1.36	220-240	6.5-7.8	990-1080	60	1	UK	KSA
55600.0304	GVH-3A	STAINLESS	65.50	17.80	40.40	1	1.36	220-240	6.5-7.8	990-1080	50-60	1	UK	CE

SOLD SEPARATELY



GVH Hopper .45L
54329.0000



GVH Hopper .9L
54332.1000



GVH Hopper 1.35L
54335.1000

Multi-Hopper Series Grinder and Storage System

An intuitive, portion-controlled coffee grinding system that handles multiple bean varieties

Portion-controlled for the right amount of coffee every time, with 3 batch sizes per hopper

Convenient front-loading hoppers are easy to clean and store individual coffee grind weight profiles

Choice of black or stainless finish

BrewWISE® intelligence means the Smart Funnel® manages the grinding and brewing process from start to finish:

Grinder adjusts the grind time for each batch to deliver just the right grind volumes

Grinder communicates coffee batch size and coffee name to the Smart Funnel during grinding process

BrewWISE brewer reads the information in the Smart Funnel, adjusts the recipe, and brews a flavorful batch of coffee

Rack and Hopper

Store and display coffee varieties and promote fresh ground coffee program

Hoppers with locking lids serve as storage containers when not in the grinder (lock for lids sold separately)



MHGA

DESCRIPTION			CAPACITY				ELECTRICAL					AGENCY		
Product #	Model	Finish	Dimensions Height x Width x Depth (Centimeters)			Number of Hoppers	Kg per Hopper	Volts	Amps	Watts	Hertz	Phase	Plug	Listing
35600.0021	MHGA	STAINLESS	73.91	23.77	45.72	2	2.72	220-240	6.5	920	50-60	1	EURO	CE
35600.0023	MHGA	BLACK	73.91	23.77	45.72	2	2.72	220-240	6.5	920	50-60	1	EURO	CE
35600.0137	MHGA	STAINLESS	73.91	23.77	45.72	2	2.72	220-240	6.5	920	50-60	1	UK	CE



2 Position Rack
36760.0000



4 Position Rack
36760.0001

SOLD SEPARATELY



Hopper/Lid Assembly
36845.0000

Hopper Partition
36053.0000



Weight Driven Series Grinder

Weight-based, portion-control for the right amount of coffee every time with three batch sizes

Unparalleled grind weight accuracy

Front-loading, removable hopper is easy to clean

BrewWISE® intelligence means the Smart Funnel® manages the grinding and brewing process from start to finish:

Grinder communicates coffee weight to the Smart Funnel during the grinding process

BrewWISE brewer reads the information in the Smart Funnel, adjusts the recipe, and brews a flavorful batch of coffee



G9WD-RH

DESCRIPTION						CAPACITY		ELECTRICAL					AGENCY	
Product #	Model	Finish	Dimensions Height x Width x Depth (Centimeters)			Number of Hoppers	Kg per Hopper	Volts	Amps	Watts	Hertz	Phase	Plug	Listing
40700.0006	G9WD-RH	STAINLESS	75.69	20.68	48.26	1	2.72	220-240	6.5	920	50-60	1	UK	ECAS KUCAS
40700.0132	G9WD-RH	STAINLESS	75.69	20.68	48.26	1	2.72	220-240	6.5	920	50-60	1	EURO	CE
40700.0137	G9WD-RH	STAINLESS	75.69	20.68	48.26	1	2.72	220-240	6.5	920	50-60	1	UK	CE

SOLD SEPARATELY



Hopper/Lid Assembly
36845.0000

Hopper Partition
36053.0000

Portion Control Series Grinder

Portion controlled for the right amount of coffee every time, with three batch sizes per hopper

Two hoppers hold 2.7kg each of regular, decaf or specialty coffee beans

Three batch sizes per hopper, with individual grind profiles

Compatible with BrewWISE TF, SG, ICB

BrewWISE® intelligence means the Smart Funnel® manages the grinding and brewing process from start to finish:

Grinder adjusts the grind time for each batch to deliver just the right grind volumes

Grinder communicates coffee batch size and coffee name to the Smart Funnel during grinding process

BrewWISE brewer reads the information in the Smart Funnel, adjusts the recipe, and brews a flavorful batch of coffee



G9-2TA DBC

DESCRIPTION						CAPACITY		ELECTRICAL					AGENCY	
Product #	Model	Finish	Dimensions Height x Width x Depth (Centimeters)			Number of Hoppers	Kg per Hopper	Volts	Amps	Watts	Hertz	Phase	Plug	Listing
33700.0133	G9-2TA DBC	STAINLESS	68.83	21.08	45.72	2	2.72	220-240	6.5	920	50-60	1	UK	KUCAS
33700.0134	G9-2TA DBC	STAINLESS	68.83	21.08	45.72	2	2.72	220-240	6.5	920	50-60	1	UK	KSA



Portion Control and Low Profile Series Grinder

Coffee grinding systems with simple switch control operation

Low profile height and narrow footprint conserves countertop space

Large, clear bean hopper merchandises 2.72kg of fresh coffee beans

Easy access on back for grind weight adjustment

Compatible with VP, CW, Axiom®



LPGA

Funnels sold separately

DESCRIPTION						CAPACITY		ELECTRICAL					AGENCY	
Product #	Model	Finish	Dimensions Height x Width x Depth (Centimeters)			Number of Hoppers	Kg per Hopper	Volts	Amps	Watts	Hertz	Phase	Plug	Listing
20580.0133	LPGA	STAINLESS	38.35	21.95	25.40	1	2.72	220-240	1.5	330-360	50-60	1	UK	

Bulk Series Grinder

High volume grinding systems with turbo action that draws the coffee through the chamber for greater grinding speed and efficiency

G2A, G3A HD

Grinds .45kg in approximately 30 seconds

Wide range of grinds can be selected

Convenient cleaning lever ensures complete clean out of grind chamber



G3A HD



G2A HD

DESCRIPTION						CAPACITY		ELECTRICAL					AGENCY	
Product #	Model	Finish	Dimensions Height x Width x Depth (Centimeters)			Number of Hoppers	Kg per Hopper	Volts	Amps	Watts	Hertz	Phase	Plug	Listing
22102.0232	G2A HD	BLACK	67.31	18.54	40.64	1	0.91	220-240	6.5-7.8	990-1080	50-60	1	EURO	CE
22100.0039	G3A HD	BLACK	67.31	18.54	40.64	1	1.36	220-240	6.5-7.8	990-1080	50-60	1	UK	KSA
22100.0232	G3S HD	BLACK	67.31	18.54	40.64	1	1.36	220-240	6.5-7.8	990-1080	50-60	1	EURO	CE



**BEAN
TO
CUP**

Crescendo®

Authentic single-cup espresso served pure, or built into your choice of 9 café beverages

Touchpad features two programmable portion sizes, 230 and 350ml and 9 beverage choices, plus hot water

9 bar brew pressure used with a variable brew group produces an excellent single or double shot with beautiful crema

Engineered with three powder hoppers; two 1.5kg hoppers for the larger demand flavors and a third 1kg hopper that allows for additional flavor

Waterfall design and compact footprint compliment front-of-house and self-service environments

1 kg hopper displays fresh whole coffee beans



Crescendo®

DESCRIPTION		CAPACITY			ELECTRICAL							
Product #	Model	Dimensions Height x Width x Depth (Centimeters)			Shots/hr	Volts	Amps	Watts	Hertz	Phase	Plug	Agency
44300.0200	CRESCENDO	79.40	35.90	49.90	40	220-240	11.5-12.2	2500-2900	50-60	1	EURO	CE
44300.0202	CRESCENDO	79.40	35.90	49.90	40	220-240	11.5-12.2	2500-2900	50-60	1	NO	CE
44300.0211	CRESCENDO	79.40	35.90	49.90	40	220-240	11.5-12.2	2500-2900	50-60	1	NO	KSA
44300.0213	CRESCENDO	79.40	35.90	49.90	40	220-240	11.5-12.2	2500-2900	50-60	1	UK	CE

Plumbing: 20-90 PSI. Machine supplied with garden hose fitting.



A photograph of two beverages on a wooden surface. In the foreground, a glass mug with a handle is filled with dark coffee. To its right, a tall glass is filled with iced tea and several ice cubes. The background is a light-colored wooden surface. A large, semi-transparent blue geometric pattern of overlapping diamonds is overlaid on the left side of the image. The text 'COFFEE & TEA COMBOS' is centered in white, bold, sans-serif font over the coffee mug.

**COFFEE &
TEA COMBOS**

Infusion Series® Standard Edition Coffee and Tea Combo

The Infusion Series coffee and tea equipment platform provides Best Result in the Cup™ performance with the proven industry knowledge to deliver the lowest cost of ownership

ITCBA

Brews into all BUNN iced tea dispensers (except TDS-5), 1.9 to 3.8L airpots, thermal carafes and can accommodate BUNN® ThermoFresh® Servers

The exclusive Peak Extraction® Sprayhead features grooves that capture minerals and isolate the directional stream holes which then spray the whole coffee bed, providing full saturation and the ideal uniformity of extraction



ITCBA

 Servers sold separately

DESCRIPTION		CAPACITY COFFEE			CAPACITY TEA		ELECTRICAL					AGENCY	
Product #	Model	Dimensions Height x Width x Depth (Centimeters)			236mL cups/hour	236mL cups/hour	Volts	Amps	Watts	Hertz	Phase	Plug	Listing
52200.0500	ITCBA	88.90	25.65	60.45	120*	337	220-240	13.2-14.1	2900-3400	50-60	1	EURO	CE

Plumbing: 138-621 kPa. Machines supplied with 1/4" Male flare fitting. All plumbed models that are CE listed feature backflow prevention.

SOLD SEPARATELY



Coffee/Tea Filter Pack
20138.1000



Tea Dispensers



Airpots and Thermal Carafes
36845.0000





COLD COFFEE

COLD COFFEE SOLUTIONS



BUNN offers a variety of profitable solutions for your Cold Coffee menu. From fresh-brewed tailored recipes by the batch to cold brew concentrate dispensers for multiple gallons of finished drinks, we have you covered.

PRODUCT	PAGE NUMBER
Infusion Series® Coffee Brewer Family - ICB	5-6
Infusion Series® Tea & CoffeeCombo Brewer Family - ITCB	33
Nitron₂® Family	36
Ultra® Family	45-46

LEARN MORE: bunn.com/cold-coffee

Nitron²® Cold Draft

Keg-free design delivers authentic Cold Brew taste without need for a complex brewing process

Achieve a nitro infusion with no kegs to change-out, store, clean, or sanitize. Uses two 3.8L concentrate BIBs or BUNN refillable containers that staff are already familiar with and each BIB yields multiple liters of finished drinks

The Nitron Experience: No milk or sugar needed! BUNN's patented in-line gas infuser produces up to 3 minutes of cascading micro-bubbles*, resulting in a nitro cold brew crowned with a smooth, silky stout-like head that tastes distinctively creamy with a velvety soft mouthfeel.

Outfit the standard and nitro taps with separate beverages - your choice of cold brew coffee, iced coffee, or iced tea - all from one slim, 25.40cm wide countertop design

At a rate of one 473mL drink per minute, can dispense 60 drinks before exceeding 5°C

**based on product concentrate used*



Nitron²® Cold Draft

DESCRIPTION						ELECTRICAL						
Product #	Model	Temperature Setting °C	Dimensions Height x Width x Depth (Centimeters)			Volts	Amps	Watts	Hertz	Phase	Plug	Agency
51600.0024	NITRON COLD DRAFT C-TOP 4:1 to 12:1	5	86.36	25.40	72.14	220-240	2.25-2.75	410-520	50-60	1	EURO	CE
51600.0025	NITRON COLD DRAFT C-TOP 4:1 to 12:1	5	86.36	25.40	72.14	220-240	2.25-2.75	410-520	50-60	1	UK	CE
51600.0037	NITRON, 230V N-2 SCHOLLE W/ BLK DR EURO	5	86.36	25.40	72.14	220-240	2.25-2.75	410-520	50-60	1	EURO	CE



CAPPUCCINO
HOT CHOCOLATE

iMIX® 5S+

Sleek powdered beverage dispenser delivers hot drinks with exceptional reliability and taste - all from an operator friendly design

Five 3.6kg hoppers

3 Size Portion Control

LED Back Lit Graphics

Variable speed motors allow control of product consistency in mixing chamber (.75 to 6.6g powder per second)

Left or top-hinged door option

Display allows adjustments and service operational testing from front of machine, communicates advertising messages, machine status, and technical support contact information

Dispense 68 355ml cups in 37 minutes before dropping 5.6°C from first cup serving temperature

Set as push and hold or single size portion control



iMIX-5S+A

DESCRIPTION					ELECTRICAL					AGENCY	
Product #	Model	Dimensions Height x Width x Depth (Centimeters)			Volts	Amps	Watts	Hertz	Phase	Plug	Listing
38100.0005	iMIX-5S+A	83.31	49.02	60.96	220-240	13.6-14.5	3000-3500	50-60	1	EURO	CE

Plumbing: 138-621 kPa. Machines supplied with 1/4" Male flare fitting. All plumbed models that are CE listed feature backflow prevention.

SOLD SEPARATELY

Inlet Hose Assembly
32865.1001

iMIX® 3

Sleek powdered beverage dispenser delivers hot drinks with exceptional reliability and taste - all from an operator friendly design

Three 3.6kg hoppers

LED backlit door graphics

Variable speed motors allow control of product consistency in mixing chamber (.75 to 6.6g powder per second)

Left or top-hinged door option

Dispense 36 355ml cups in 14 minutes before dropping 5.6°C from first cup serving temperature

Display allows adjustments and service operational testing from front of machine, communicates machine status, technical support contact information, and advertising messages

3 size portion control



iMIX-3A

DESCRIPTION					ELECTRICAL						AGENCY
Product #	Model	Dimensions Height x Width x Depth (Centimeters)			Volts	Amps	Watts	Hertz	Phase	Plug	Listing
36900.0014	iMIX-3A	83.31	31.24	61.21	220-240	13.6-14.5	3000-3500	50-60	1	EURO	CE

Plumbing: 138-621 kPa. Machines supplied with 1/4" Male flare fitting. All plumbed models that are CE listed feature backflow prevention.

SOLD SEPARATELY

Inlet Hose Assembly
32865.1001

A glass mug filled with water, sitting on a wooden surface. The mug has a thick rim and a handle. The water is clear, and there's a slight reflection on the surface. The background is a wooden table with a dark, textured grain. Overlaid on the left side of the image is a decorative pattern of overlapping, rounded diamond shapes in shades of blue and grey. The text 'HOT WATER' is centered on the mug in a white, sans-serif font.

HOT
WATER

Precise Temperature *Medium Volume*

Accuracy, adjustability, energy efficiency and styling in a quality hot water dispenser

11.4L tank

Precise temperature control and hot water on-demand to 96°

Contemporary, low profile design for front-of-house and self-service

Push and Hold dispense -with one programmable Portion Control setting for a volume of up to 7.6 liters

Eco-friendly technology maximizes energy use

Thinsulate® tank insulation improves energy efficiency

Programmable “Energy Saver Mode” reduces operating costs during idle periods

LED display provides simple temperature adjustment

Intuitive blue LED dispense button

Cup clearance accommodates a range of serving options for custom-crafted, hand pour coffees and teas

Backed by standard BUNN® Commercial Warranty

This unit can be portion control as well



H3EA

DESCRIPTION						CAPACITY		ELECTRICAL					AGENCY
						WATER INPUT 15.6°C	L/hr						
Product #	Model	Dimensions Height x Width x Depth (Centimeters)			Temperature Setting °C	L/hr	Volts	Amps	Watts	Hertz	Phase	Plug	Listing
45300.0000	H3EA Element	56.39	19.3	51.82	96	29.9	220-240	11.5-12.5	2500-3000	50-60	1	UK	CE
45300.0002	H3EA Element	56.39	19.3	51.82	96	29.9	220-240	11.5-12.5	2500-3000	50-60	1	EURO	CE EAC

Plumbing: 138-621 kPa. Machine supplied with 1/4" BSPP Male flare fitting.

Precise Temperature *Medium Volume*

Accuracy, adjustability, energy efficiency and styling in a quality hot water dispenser

18.9L tank

Thinsulate® tank insulation provides increased energy efficiency

LED display provides simple temperature adjustment

Digital thermostat provides consistent and accurate temperatures of 15.6°-100°C

Programmable "Energy Saver Mode" reduces operating cost during idle periods



H5XA Element
(Stainless)



H5XA Element
(White)



H5XA Element

DESCRIPTION				CAPACITY	ELECTRICAL						AGENCY			
Product #	Model	Dimensions Height x Width x Depth (Centimeters)			Finish	Temperature Setting °C	L/hr	Volts	Amps	Watts	Hertz	Phase	Plug	Listing
43600.0013	H5XA Element	72.40	18.00	48.00	STAINLESS	100	36.6*	220-240	15.5-16	3400-3800	50/60	1	EURO	CE EAC
43600.0022	H5XA Element	72.40	18.00	48.00	BLACK	100	36.6*	220-240	15.5-16	3400-3800	50/60	1	EURO	CE EAC
43600.0023	H5XA Element	72.40	18.00	48.00	WHITE	100	36.6*	220-240	15.5-16	3400-3800	50/60	1	EURO	CE EAC
43600.0032	H5XA Element	72.40	18.00	48.00	STAINLESS	100	36.6*	220-240	15.5-16	3400-3800	50/60	1	NO	CE

Plumbing: 138-621 kPa. Machine supplied with 1/4" OD Male flare fitting.

SOLD SEPARATELY

Inlet Hose
32865.1001

Shelf Kit
12599.0000

Wall Bracket Kit, Side Mount
12599.0000

Constant Temperature *Medium Volume*

Space-saving machine just 18cm wide to fit any counter

High quality, easy-to-clean stainless steel exterior and tank for a long life

Includes drip tray



HW2A



H5EA PC

Product #	Model	DESCRIPTION			Temperature Setting °C	CAPACITY		ELECTRICAL				AGENCY	
		Dimensions Height x Width x Depth (Centimeters)				L/hr	Volts	Amps	Watts	Hertz	Phase	Plug	Listing
02500.0002	HW2A	60.96	18.03	36.32	93.3	19.3	220-240	7.3-7.9	1600-1900	50-60	1	EURO	CE EAC
02500.0017	HW2A	60.96	18.03	36.32	93.3	19.3	220-240	7.3-7.9	1600-1900	50-60	1	NO	KSA KUCAS
39100.0003	H5EA	60.96	18.03	36.32	93.3	19.3	220-240	15.5-16.0	3400-3800	50/60	1	EURO	CE EAC

SOLD SEPARATELY

Inlet Hose Assembly
32865.1001



FROZEN GRANITA
SLUSHY

Ultra® Series

Frozen beverage dispenser with reversing auger technology for superior mixing and freezing

Manual Fill

Two 11.36L hoppers

Pour water and product mix directly into hopper; special plumbing not required

Torque sensor technology maintains consistent product thickness for superior beverages

Reversing auger insures product quality and product presentation in the hopper

High efficiency LED lighting on units without a flat lid



Ultra-2A

DESCRIPTION						ELECTRICAL					AGENCY	
Product #	Model	Dimensions Height x Width x Depth (Centimeters)			Finish	Volts	Amps	Watts	Hertz	Phase	Plug	Listing
34000.0002	ULTRA-2A	81.28	40.64	62.23	BLACK	220-240	4.7-5.1	1050-1100	50-60	1	EURO	CE (NSF)
34000.0003	ULTRA-2A	81.28	40.64	62.23	STAINLESS/WHITE	220-240	4.7-5.1	1050-1100	50-60	1	EURO	CE (NSF)
34000.0573	ULTRA-2A	81.28	40.64	69.85	BLACK	220-240	4.7-5.1	1050-1100	50-60	1	No	CE (NSF)

Ultra® Series

Frozen beverage dispenser with reversing auger technology for superior mixing and freezing

AUTOFILL

Two 11.36L hoppers

High efficiency LED lighting

Torque sensor technology maintains consistent product thickness for superior beverages

Reversing auger insures product quality and product presentation in the hopper

Designed to be compliant with ADA self service requirements

CF VALVE AUTOFILL

Constant flow control for accurate brixing of product

Internal brixing allows interface with standard BIB pumping

LIQUID AUTOFILL

Liquid autofill product hoppers automatically replenish

Designed to be used with Brix Pumps



Ultra-2A

DESCRIPTION					ELECTRICAL						AGENCY		
Product #	Model	Dimensions Height x Width x Depth (Centimeters)			Finish	CF Valve	Volts	Amps	Watts	Hertz	Phase	Plug	Listing
34000.0066	ULTRA-2A Liquid Autofill	81.28	40.64	62.23	BLACK	NO	220-240	4.7-5.1	1050-1100	50-60	1	EURO	CE
34000.0557	ULTRA-2A CFV Liquid Autofill	81.28	40.64	62.23	BLACK	YES	220-240	4.7-5.1	1050-1100	50-60	1	EURO	CE

Plumbing: 138-621 kPa. Machines supplied with 1/4" Male flare fitting. All plumbed models that are CE listed feature backflow prevention.

A waiter in a blue uniform is holding a silver tray. On the tray, there is a white coffee cup with a saucer and a tall glass filled with an amber-colored beverage and ice cubes. The background is blurred, showing other people in a social setting. The image is overlaid with a pattern of blue and white diamond shapes.

SERVING & HOLDING

ThermoFresh® Digital Gauge Servers

Holds flavour profile for hours without traditional warming plates

TF Server

Digital timer begins to count up in one minute increments to specifically display how long the brewed beverage has been stored; requires four AAA batteries; display shows low battery symbol

Brew-thru lid design also features a pour spout for easy emptying and cleaning

Translucent faucet guard for visibility while dispensing

Ideal for use with Single or Dual TF DBC and Infusion Series® Brewers

TF Server without Stand

Ideal with Infusion Series® Coffee Brewer (ICB)

TF Server Stand

Use for easy dispensing; 17.9cm cup clearance

Built-in drip tray is easily removed for cleaning or providing extra clearance for large vessels



3.8L TF Server
(Stand included)



3.8L TF Server
without Stand



TF Server Stand

Product #	Model	Dimensions			Holding Capacity	Includes Stand	Finish	Compatible Brewers	Agency
		Height	Width	Depth					
42700.0200	TF Server DSG3	52.58	23.62	33.02	3.8L	YES	STAINLESS	Single TF DBC, Dual TF DBC, ITCB, ITCB HV	NSF
42750.0200	TF Server DSG3	57.66	23.62	33.02	5.7L	YES	STAINLESS		
42700.0250	TF Server DSG3	32.00	23.11	32.26	3.8L	NO	STAINLESS	ICB ICB Twin	NSF
42750.0250	TF Server DSG3	37.34	23.11	32.26	5.7L	NO	STAINLESS		
54473.1000	TF Server Stand	24.64	23.50	33.02	n/a	n/a	STAINLESS	TF Servers Without Stand	

ThermoFresh® Mechanical Gauge Servers

Holds flavour profile for hours without traditional warming plates

TF Server

Glass sight gauge on front of server allows for visible indication of level capacity

Brew-thru lid design also features a pour spout for easy emptying and cleaning

Translucent faucet guard for visibility while dispensing

Ideal for use with Single or Dual TF DBC and Infusion Series® Brewers

TF Server without stand

Ideal with Infusion Series® Coffee Brewer (ICB)

TF server stand

Use for easy dispensing; 17.9cm cup clearance

Built-in drip tray is easily removed for cleaning or providing extra clearance for

Titan TF Server

11.36L capacity

Insulated and portable

Large cup clearance for a variety of dispensing options large vessels



Titan TF Server
(3 gal)



Titan TF Server
(1.5 gal)



3.8L TF Server
without Stand



TF Server Stand

5.7L TF Server
(Stand included)

MECHANICAL GAUGE SERVERS

Product #	Model	Dimensions Height x Width x Depth (Centimeters)			Holding Capacity	Includes Stand	Finish	Compatible Brewers	Agency
		Height	Width	Depth					
44000.0200	TF SERVER	52.83	23.62	33.02	3.8L	YES	STAINLESS	SINGLE TF DBC DUAL TF DBC, ITCB ITCB HV	NSF
44050.0200	TF SERVER	58.17	23.62	33.02	5.7L	YES	STAINLESS		
44000.0250	TF SERVER	32.04	23.11	30.15	3.8L	NO	STAINLESS	ICB ICB TWIN	
44050.0250	TF SERVER	32.04	23.11	30.15	5.7L	NO	STAINLESS		
54473.1000	TF SERVER STAND	24.64	23.50	33.02	N/A	N/A	BLACK	TF SERVERS WITHOUT STAND	
46300.0000	Titan TF Server	58.17	29.72	38.86	5.7L	NO	STAINLESS	Titan, ThermoFresh, Infusion Series (Tall)	NSF



Infusion Series® Soft Heat® Server System

BUNN-exclusive Soft Heat technology supplies controlled heat to the brewed coffee within the server whenever it's docked on the brewer, ensuring ideal holding temperatures and optimal flavor for longer periods

SH Server

5.7L capacity; choose from five optional holding time settings

Safety-Fresh® brew-thru lid with vapor seal and spill prevention

Ergonomic handle for secure portability

SH Docking Station

Remote one and two server docking stations with 10.2cm legs

Instant power contact with servers

Add additional remote stations to increase volume



2SH Docking Station



1 SH Server and Docking Station

SOFT HEAT® SERVER SYSTEMS

Product #	MODEL	Dimensions			Holding Capacity	Finish	Volts	Amps	Watts	Hertz	Phase	Plug	Compatible Brewers	Agency
		Height	Width	Depth										
27850.0200	INFUSION SERIES® SH SERVER	36.83	23.11	33.78	5.7L	STAINLESS/BLACK								NSF UL LISTED KSA
27850.0206	INFUSION SERIES® SH SERVER	36.83	23.11	33.78	5.7L	STAINLESS/BLACK			N/A					NSF UL LISTED
27825.0300	INFUSION SERIES® 1SH DOCKING STATION	23.60	25.90	30.00	1 SH SERVER	STAINLESS	220-240	0.45-0.49	70-80	50-60	1	EURO	NEW INFUSION SERIES 51100.0500	CE
27875.0300	INFUSION SERIES® 2SH DOCKING STATION	23.60	51.30	30.00	2 SH SERVER	STAINLESS	220-240	0.75-0.82	150-160	50-60	1	EURO	NEW INFUSION SERIES 51100.0500	CE
27875.0301	INFUSION SERIES® 2SH DOCKING STATION	23.60	51.30	30.00	2 SH SERVER	STAINLESS	220-240	0.75-0.82	150-160	50-60	1	UK	NEW INFUSION SERIES 51100.0500	KSA

Soft Heat® Server System

BUNN-exclusive Soft Heat technology supplies controlled heat to the brewed coffee within the server whenever it's docked on the brewer, ensuring ideal holding temperatures and optimal flavor for longer periods

SH Server

5.7L capacity; choose from five optional holding time settings

Safety-Fresh® brew-thru lid with vapor seal and spill prevention

Ergonomic handle for secure portability

SH Docking Station

Remote one and two server docking stations with 10.2cm legs

Instant power contact with servers

Add additional remote stations to increase volume



1SH Docking Station



1 SH Server and Docking Station

SOFT HEAT® SERVER SYSTEMS

Product #	MODEL	Dimensions Height x Width x Depth (Centimeters)			Holding Capacity	Setting	Finish	Volts	Amps	Watts	Hertz	Phase	Plug	Compatible Brewers	Agency
27850.0001	SH SERVER	42.16	21.59	35.56	5.7L	N/A	STAINLESS/ BLACK								
27850.0004	SH SERVER	42.16	21.59	35.56	5.7L	ADJUSTABLE TIMER	BLACK								
27850.0006	SH SERVER	42.16	21.59	35.56	5.7L	45MIN	STAINLESS								
27850.0008	SH SERVER	42.16	21.59	35.56	5.7L	60MIN	BLACK							SINGLE SH DBC	
27850.0009	SH SERVER	42.16	21.59	35.56	5.7L	240MIN	STAINLESS			N/A				DUAL SH DBC	NSF
27850.0016	SH SERVER	42.16	21.59	35.56	5.7L	120MIN	BLACK							SINGLE SH DUAL SH	UL LISTED
27850.0022	SH SERVER	42.16	21.59	35.56	5.7L	120MIN	BLACK								
27850.0023	SH SERVER	42.16	21.59	35.56	5.7L	ADJUSTABLE TIMER	STAINLESS								
27850.0046	SH SERVER	42.16	21.59	35.56	5.7L	60MIN	STAINLESS								
27825.0001	1SH DOCKING STATION	34.42	25.65	33.53	1 SH SERVER	N/A	STAINLESS	220-240	0.33-0.36	70-85	50-60	1	EURO	1 SH SERVER	CE NSF EAC

Thermal Carafes, Pitchers and Airpots

Thermal Carafe

Durable stainless steel interior and exterior

Thermal Pitcher

Stainless steel lining ensures hot coffee for hours

Push Button Airpot

Brew-thru pump assembly - no need to remove for brewing

Lever-Action Airpot

Brew-thru lid with lever-action for easy use



Vacuum Pitcher



Lever-Action Airpot



Push-Button Airpot



Seamless Thermal Carafe



Thermal Carafe

CARAFES								
Product #	Model	Capacity	Liner	Lid Color	Quantity per Case	Compatible Brewers	Agency	
36029.0001	DELUXE THERMAL CARAFE	1.9L	STAINLESS STEEL	BLACK	1	SmartWAVE CWTF-TC	NSF	
36029.0000	DELUXE THERMAL CARAFE	1.9L	STAINLESS STEEL	BLACK	12			
36252.0001	DELUXE THERMAL CARAFE	1.9L	STAINLESS STEEL	ORANGE	1			
36252.0000	DELUXE THERMAL CARAFE	1.9L	STAINLESS STEEL	ORANGE	12			
51746.0001	SEAMLESS THERMAL CARAFE	1.9L	STAINLESS STEEL	BLACK	1			
51746.0101	SEAMLESS THERMAL CARAFE	1.9L	STAINLESS STEEL	BLACK	12			
PITCHERS								
Product #	Model	Capacity	Liner		Quantity per Case	Brewers	Agency	
39430.0000	VACUUM	1.9L	STAINLESS STEEL		1	SmartWAVE	NSF	
39430.0100	VACUUM	1.9L	STAINLESS STEEL		6	SmartWAVE		
40400.0000	VACUUM PITCHER	1L	STAINLESS STEEL		1	SmartWAVE		
AIRPOTS								
Product #	Model	Capacity	Liner		Quantity per Case	Brewers	Agency	
28696.0002	PUSH-BUTTON	2.2L	GLASS		1	CW-APS ICB ICB Twin SmartWAVE CWTF-APS CWTF Twin APS ITCB AXIOM APS	Intertek	
28696.0006	PUSH-BUTTON	2.2L	GLASS		6			
13041.0001	PUSH-BUTTON	2.5L	GLASS		1			
13041.0101	PUSH-BUTTON	2.5L	GLASS		6			
32700.0000	LEVER-ACTION	2.2L	GLASS		6			
32125.0000	LEVER-ACTION	2.5L	STAINLESS STEEL		1			
32125.0100	LEVER-ACTION	2.5L	STAINLESS STEEL		6			
32130.0000	LEVER-ACTION	3L	STAINLESS STEEL		1			
32130.0100	LEVER-ACTION	3L	STAINLESS STEEL		6			
36725.0000	LEVER-ACTION	3.8L	STAINLESS STEEL		1			
36725.0100	LEVER-ACTION	3.8L	STAINLESS STEEL		6			
								NSF

Coffee Decanters

EASY POUR®

BUNN® exclusive design; high quality stainless steel base with drip proof, fast-pour lip

Clear, impact-resistant material complies with FDA regulations for food contact

Glass decanters

Reliable, shatter-resistant, and perfectly balanced with laboratory-grade, stress-free glass



Glass



Easy Pour®



Stainless Steel

DESCRIPTION					COMPATIBLE EQUIPMENT	
Product #	Model	Capacity	Handle Color	Quantity Per Case	Brewers	Agency
06100.0101	EASY POUR	1.9L	BLACK	1	Decanter Brewers VP17 AXIOM CW	
06100.0102	EASY POUR	1.9L	BLACK	2		
06100.0103	EASY POUR	1.9L	BLACK	3		
06100.0106	EASY POUR	1.9L	BLACK	6		
06100.0112	EASY POUR	1.9L	BLACK	12		
06100.0124	EASY POUR	1.9L	BLACK	24		
06101.0101	EASY POUR	1.9L	ORANGE	1		
06101.0102	EASY POUR	1.9L	ORANGE	2		
06101.0103	EASY POUR	1.9L	ORANGE	3		
06101.0124	EASY POUR	1.9L	ORANGE	24		
42400.0024	GLASS	1.9L	BLACK	24		
42401.0101	GLASS	1.9L	ORANGE	1		
42400.0103	GLASS	1.9L	BLACK	3		
42401.0024	GLASS	1.9L	ORANGE	24		
42400.0101	GLASS	1.9L	BLACK	1		
42401.0103	GLASS	1.9L	ORANGE	3		
06026.0000	STAINLESS	1.9L	BLACK	1		
42400.0103	GLASS w/RFID	1.9L	BLACK	3		
42401.0103	GLASS w/RFID	1.9L	ORANGE	3		

Universal Airpot Racks

Versatile merchandising system for airpots

Displays can be combined or taken apart easily for greater flexibility

Sturdy, carbon-steel wire construction with vinyl coating resists corrosion, easy to clean

Configurations available for two to six airpots



UNIV-4 APR



UNIV-3 APR



UNIV-2 APR

AIRPOT RACKS

Product #	Model	Dimensions Height x Width x Depth (Centimeters)			Capacity
35728.0000	UNIV-2 APR (1 Upper, 1 Lower)	35.81	19.05	61.21	TWO AIRPOTS
35728.0001	UNIV-2 APR (2 Lower)	17.53	37.85	28.45	TWO AIRPOTS
35728.0002	UNIV-3 APR (3 Lower)	17.53	58.17	28.45	THREE AIRPOTS
35728.0003	UNIV-4 APR (2 Upper, 2 Lower)	35.56	37.85	63.25	FOUR AIRPOTS
35728.0004	UNIV-5 APR (3 Upper, 2 Lower)	35.56	58.17	63.25	FIVE AIRPOTS
35728.0005	UNIV-6 APR (3 Upper, 3 Lower)	35.56	58.17	63.25	SIX AIRPOTS

GPR Servers and Remote Warmers

Convenient servers and warming stands allow for easy set-up and maintenance of remote serving stations

Portable Server

5.7L capacity

Top handle allows for easy transport to remote service

Safety-Fresh® brew-thru lid with vapor seal and spill prevention

Warmer

Adjustable black plastic legs



RWS1 Warmer



1.5 GPR-FF

SERVER

Product #	Model	Dimensions Height x Width x Depth (Centimeters)			Capacity	Finish	Compatible Brewers	Agency
20950.0004	1.5GPR-FF	24.89	17.02	32.33	5.7	STAINLESS/BLACK	SINGLE AND DUAL	
20950.0019	1.5GPR-FF	24.89	17.02	32.33	5.7	STAINLESS/BLACK	SINGLE AND DUAL	KSA KUCAS

WARMER

Product #	Model	Dimensions Height x Width x Depth (Centimeters)			Capacity	Finish	Volts	Amps	Watts	Hertz	Phase	Plug	Compatible Servers	Agency
12203.0010	RWS1	22.86	21.59	23.62	1 GPR Server	STAINLESS	120	1	100	60	1	NEMA 5-15P	1.5GPR	

Iced Tea and Iced Coffee Dispensers

Solid stainless construction stands up to demands of foodservice environments

Sump dispense valves assure complete dispensing of beverage

Variety of shapes and sizes for every counter configuration



Oval



TD3T-N



Narrow



Square



Round

NARROW						
Product #	Model	Capacity	Handles	Additional Feature	Brewers	Agency
39600.0001	TDO-N-3.5	13.2L	FRONT/BACK	STANDARD DISPENSE FAUCET	Tall models w/ 73.66cm trunk: TB3 ITCB, ITCB HV	
39600.0031	TDO-N-3.5	13.2L	FRONT/BACK	LIFT DISPENSE FAUCET		
39600.0002	TDO-N-4.0	15L	FRONT/BACK	STANDARD DISPENSE FAUCET		
39600.0047	TDO-N-3.5	13.2L	FRONT/BACK	PINCH TUBE FAUCET		
39600.0081	TDO-N-3.5	13.2L	FRONT/BACK	STANDARD DISPENSE FAUCET, BREW-THRU LID		
39600.0083	TDO-N-3.5	13.2L	FRONT/BACK	PINCH TUBE FAUCET, BREW-THRU LID		
43900.0001	TD3T-N	13.2L	FRONT/BACK	LIFT HANDLE, BREW-THRU LID		
43900.0002	TD3T-N	13.2L	FRONT/BACK	LIFT HANDLE, SOLID LID		
SQUARE						
03250.0003	TD4	15.1L	SIDE	SOLID LID	Short models w/ 65.41cm trunk: TB3 ITCB	
03250.0006	TD4T	15.1L	SIDE	BREW-THRU LID		
03250.0004	TD4	15.1L	SIDE	SOLID LID, TALL	Tall models w/ 73.66cm trunk: ITCB ITCB HV	
03250.0005	TD4T	15.1L	SIDE	BREW-THRU LID, TALL		
03250.0018	TD4T	15.1L	SIDE	BREW-THRU LID, TALL, NO DECAL		
CYLINDER - ROUND						
33000.0000	TDS-3	11.4L	SIDE	STAINLESS LID	TB3 ITCB ITCB HV	
33000.0001	TDS-5	18.9L	SIDE	STAINLESS LID	TU5	
33000.0023	TDS-3.5	13.2L	SIDE	SOLID, PLASTIC LID		
CYLINDER - OVAL						
34100.0000	TDO-4	15L	SIDE	SOLID, PLASTIC LID	TB3 ICB ITCB HV	
34100.0002	TDO-4	15L	SIDE	BREW-THRU PLASTIC LID		
34100.0001	TDO-5	18.9L	SIDE	SOLID, PLASTIC LID		
34100.0003	TDO-5	18.9L	SIDE	BREW-THRU PLASTIC LID		



PAPER
FILTERS

Paper Filters

Selection of coffee filters is a vital step in brewing perfect coffee - don't settle for anything less than BUNN® quality coffee filters. Using the results of years of research, BUNN manufactures the best filters from high quality, heavy weight paper, so the water flows properly through the coffee. Our filters are uniquely designed for strength with taller walls to help reduce overflow and grounds in your coffee.



BUNN's paper stock used in the manufacturing of our coffee filters is produced using an elemental chlorine-free (ECF) bleaching method.

BUNN Paper Filter materials meet:

Restrictive limits as stated in Resolution ResAP(2002)1 on paper and board materials intended to come into contact with foodstuff

Compositional and end product requirements stated in the Dutch legislation "Regeling Verpakkingen en gebruiksartikelen, Chapter II, Paper and board, pt 2 Paper and board used as cooking paper and for filtering above 80°C"

Limits stated in the German recommendation BfR XXXVI Paper and board for food contact and the special requirements in BfR XXXVI/1 for Cooking Papers, hot filter papers and filter layers

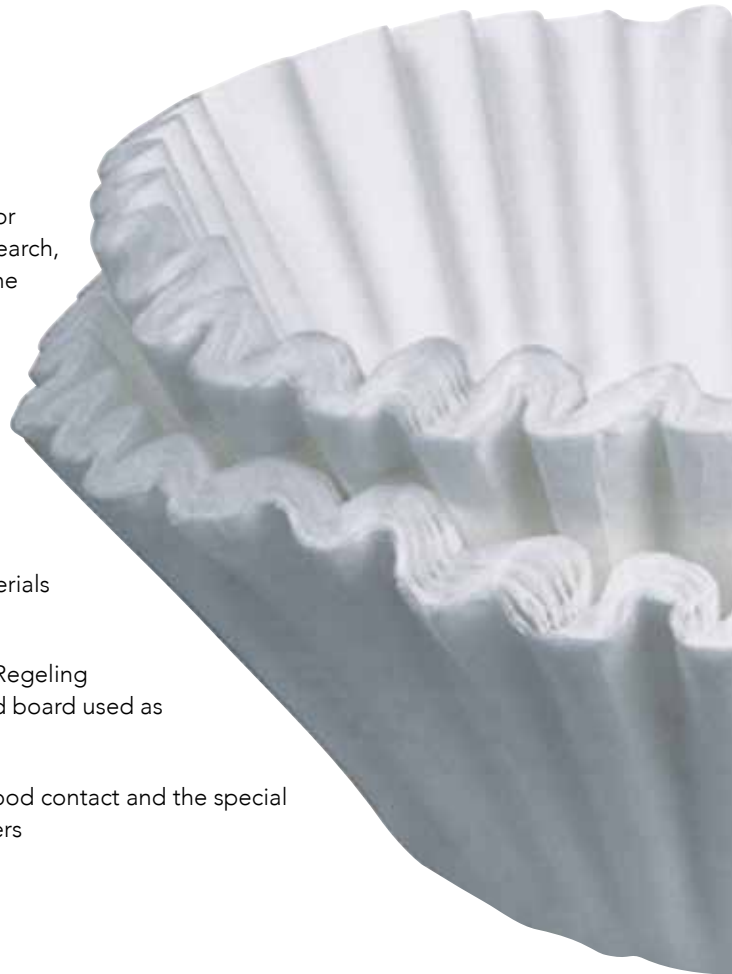

Product #	Filter Type	Description	Number per Bag	Bags per Case	Number Cluster	Overall Measure x Base Diameter (millimetres)	Packed per Case	Case Weight (lbs/kg)	Cases per Skid/Tier
20115.0000		REGULAR C, S, R, O, VLPF, VPR, VPS, VP-17	500	2	50	247.65 x 107.95	1000	1.91	180/15
20116.0000	DECANTER FILTERS	REGULAR NARROW C, S, R, O, VLPF, VPR, VPS, VP-17	500	2	50	241.3 x 82.55	1000	1.91	180/15
20122.0000		REGULAR FAST FLOW C, S, R, O, VLPF, VPR, VPS, VP-17	500	2	50	247.65 x 107.95	1000	2.04	180/15
20109.0000		URN - U3, SRU, IC-3	252	1	36	450.85 x 184.15	252	2.49	88/11
20112.0000		NARROW BASE URN	250	1	25	469.9 x 158.75	250	2.49	88/11
20124.0000		URN, 11.4L	252	1	36	482.6 x 184.15	252	2.77	88/11
20111.0000	URN FILTERS	TITAN, URN	252	1	36	508 x 196.85	252	2.99	84/12
20125.0000		URN, 22.7L	250	1	25	533.4 x 222.25	250	3.4	72/9
20113.0000		URN, 37.9L	250	1	25	603.25 x 222.25	250	4.22	54/9
20131.0000		URN, 37.9L	252	1	36	615.95 x 273.05	252	4.40	36/6
20120.0000		SYSTEM III	252	2	36	384.18 x 136.53	504	3.86	108/12
20100.0000	OTHER FILTERS	TEA BREWERS, SINGLE & DUAL COFFEE BREWERS, 5.7L URNS, ITCB, SYSTEM II	500	1	50	323.85 x 133.35	500	2.13	150/15
20157.0001		GOURMET C FUNNEL	500	2	50	349.25 x 133.35	1000	3.74	60
20138.1000		GOURMET, SINGLE TF, DUAL TF, SINGLE SH, DUAL SH, SINGLE, DUAL, 5.7L URNS	500	1	36	349.25 x 133.35	504	2.49	108/12



ACCESSORIES

Accessories and Cleaning Agents



TABZ™ Brewer Cleaner

CLEANING AGENTS AND ACCESSORIES

Part #	Model	Quantity Per Case
29875.0000	FLOWJET® SYSTEM	ONE
29875.0001	FLOWJET® SYSTEM, 230V	ONE
24634.0000	KAY-5 SANITIZER	200 PACKETS
24634.0001	KAY-5 SANITIZER	50 PACKETS
36000.1188	CAFIZA CLEANING TABLETS	TWELVE CONTAINERS
36000.1189	CAFIZA CLEANING TABLETS	ONE CONTAINER
37306.0000	URNEX DESCALER	ONE 1OZ PACKET
39159.0000	GRINDZ GRINDER CLEANER	ONE CONTAINER
39159.0001	GRINDZ GRINDER CLEANER	TWELVE BOTTLES
39265.0000	RINZA MILK CLEANER	ONE BOTTLE
39265.0001	RINZA MILK CLEANER	SIX BOTTLES
39265.0010	COMPLETE CAFE MILK CLEANER	ONE BOTTLE
39265.0011	COMPLETE CAFE MILK CLEANER	SIX BOTTLES
39302.0000	REFILLABLE CONTAINER ASSEMBLY	ONE
39637.0000	TABZ BREWER CLEANER	ONE CONTAINER
39637.0001	TABZ BREWER CLEANER	TWELVE CONTAINERS
55605.0000	CAFIZA FOR CRESCENDO	ONE CONTAINER

Stock Funnels



URN FUNNEL

PRODUCT NUMBER 07022.0012

For use with U3 brewers

BLACK PLASTIC SPLASHGARD® FUNNEL WITH DECALS

PRODUCT NUMBER 20583.0003

For use with CDBC, CWT, AXIOM®, Smart WAVE® Brewers

PRODUCT NUMBER 29351.0001

For use with O, R, CDBD Twin, CWT Twin and AXIOM® Twin Brewers



BLACK PLASTIC SINGLE/DUAL FUNNEL

PRODUCT NUMBER 53463.0008

For use with new Infusion Series® SH and Twin SH Brewers

STAINLESS STEEL SPLASHGARD® FUNNEL

PRODUCT NUMBER 20216.0000

For use with CDBC, CWT AXIOM® and Smart WAVE® brewers

PRODUCT NUMBER 20217.0000

For use with O, R, CDBC Twin, CWT Twin and AXIOM® brewers



STAINLESS STEEL SINGLE/DUAL FUNNEL

PRODUCT NUMBER 20201.1201

For use with older Single®, Dual®, and Soft Heat® brewers

SMART FUNNEL®

PRODUCT NUMBER 32643.0000

Standard w/ bypass

PRODUCT NUMBER 32643.0010

w/D-Ring basket

For use with older BrewWISE®, ThermoFresh®, Soft Heat®, DBC® and ICB brewers



TITAN® FUNNEL

PRODUCT NUMBER 40114.0000

For use with Titan® brewers

GOURMET C FUNNEL

PRODUCT NUMBER 34559.0000

For use with CDBC, CWT AXIOM® and SmartWAVE® APS and TC brewers

PRODUCT NUMBER 34559.0001

For use with CDBC Twin, CWT Twin and AXIOM® Twin APS and TC brewers

Universal design – handle may be moved to appropriate side

Allows brewing heavier throw weights

PRODUCT NUMBER 34559.0003

For use with older ITCB

TRANSLUCENT COFFEE FUNNEL

PRODUCT NUMBER 20583.0002

For use with VP and CWTF brewers

PRODUCT NUMBER 29351.0000

For use with O, R, CDBC Twin, CWT Twin and AXIOM® Twin brewers



TRANSLUCENT TEA FUNNEL

PRODUCT NUMBER 03021.0016

For use with Smart WAVE® brewer

TRANSLUCENT TEA FUNNEL

PRODUCT NUMBER 03021.0004

For use with TB3, TU3, and older ITCB brewers

PRODUCT NUMBER 03021.0005 (Quick Dispense)

For use with TB3Q, TU3Q, and older ITB brewers



TRANSLUCENT DUAL DILLUTION TEA FUNNEL

PRODUCT NUMBER 03021.0013

For use with TB6 brewer

PRODUCT NUMBER 03021.0014

For use with TB6Q brewer

TRANSLUCENT TEA FUNNEL

PRODUCT NUMBER 53463.0010

For use with new Infusion Series® ITCB Brewers



NOTE: All funnels shown on this page are designed with SplashGard® to help deflect hot liquids away from the hand.

Special Purpose Funnels



TRANSLUCENT POUCH PACK FUNNEL

PRODUCT NUMBER [35282.0001](#)

For use with TU3Q brewer

PRODUCT NUMBER [35282.0002](#)

For use with TU3 and TB3 brewers

Use with rectangular tea pouch pack



POUCH PACK FUNNEL FOR SATELLITE BREWERS

PRODUCT NUMBER [35282.0000](#)

For use with older Single and Dual SH brewers

POUCH PACK FUNNEL FOR SATELLITE BREWERS

PRODUCT NUMBER [29151.0000](#)
Black Handle

PRODUCT NUMBER [29151.0001](#)
Orange Handle

Interchangeable handle allows use will all BUNN decanter brewers



POUCH PACK FUNNEL FOR SMALL BREW CHAMBER BREWERS

PRODUCT NUMBER [02073.0010](#)

For use with O and R brewers

PRODUCT NUMBER [02774.0010](#) Brown

PRODUCT NUMBER [02774.0011](#) Black

For use with VP and CWTF brewers



POUCH PACK FUNNEL FOR LARGE BREW CHAMBER BREWERS

PRODUCT NUMBER [02074.0010](#)

For use with O and R brewers

PRODUCT NUMBER [04274.0010](#) Brown

PRODUCT NUMBER [04274.0012](#) Black

For use with VP and CWTF brewers



NOTE: Only funnels #35282.0001, #35282.0002, and #35282.0000 on this page are designed with SplashGard® to help deflect hot liquids away from the hand.

Drip Trays Coffee

INFUSION SERIES® SH BREWERS AND SH STAND

PRODUCT NUMBER [53452.0001](#)



RWS1 WARMER

PRODUCT NUMBER [20213.0103](#)



INFUSION SERIES® TWIN SH BREWERS AND 2 SH STAND

PRODUCT NUMBER [53452.0000](#)



DUAL® BREWERS

PRODUCT NUMBER [20213.0101](#)



LCR-3 HV

PRODUCT NUMBER [41656.0000](#)



AIRPOT RACK

PRODUCT NUMBER [25368.0000](#) Tray

PRODUCT NUMBER [25367.0000](#) Tray Liner

THERMOFRESH SERVER®

PRODUCT NUMBER [38931.0000](#) Tray

PRODUCT NUMBER [38932.0000](#)
Tray Cover



U3 COFFEE URN

PRODUCT NUMBER [07284.0000](#)



Drip Trays *Dispensed Water*



HW2, H5M, and H5X

PRODUCT NUMBER [02497.0000](#)



OHW

PRODUCT NUMBER [02497.0001](#)

Drip Trays *Tea*



TCD and TDO

PRODUCT NUMBER [38029.1000](#)



TDO-N

PRODUCT NUMBER [39626.0000](#) Tray

PRODUCT NUMBER [39627.0000](#)
Tray Cover

Drip Trays *Hot Dispensed*



FMD-1 and FMD-2

PRODUCT NUMBER [02571.0000](#) Tray



PRODUCT NUMBER [28966.0000](#)
Tray Cover



FMD-3

PRODUCT NUMBER [28699.0000](#) Tray



PRODUCT NUMBER [28267.0000](#)
Tray Cover



FMD-4 and FMD-5

PRODUCT NUMBER [34716.0000](#) Tray



PRODUCT NUMBER [34717.0000](#)
Tray Cover



iMIX-3

PRODUCT NUMBER [36984.0000](#) Tray



PRODUCT NUMBER [36985.0000](#)
Tray Cover



iMIX-4 and iMIX-5

PRODUCT NUMBER [36670.0000](#) Tray



PRODUCT NUMBER [36739.0000](#)
Tray Cover

Drip Trays *Cold Dispensed*



JDF-2S

PRODUCT NUMBER [38765.1000](#)



JDF-2S/ NITRON EXTENDED

PRODUCT NUMBER [44015.1000](#)

Increases cup clearance to 10.25"



JDF-4S and LCR-3

PRODUCT NUMBER [38764.1001](#)



JDF-4S EXTENDED

PRODUCT NUMBER [40789.1000](#)

Increases cup clearance to 10.25"

Drip Trays *Frozen Dispensed*



ULTRA-2 WHITE

PRODUCT NUMBER [28086.0000](#) Tray

PRODUCT NUMBER [32068.0000](#)
Tray Cover



ULTRA-2 BLACK

PRODUCT NUMBER [28086.0001](#) Tray

PRODUCT NUMBER [32068.0001](#)
Tray Cover

SALES | SERVICE | SUPPORT OFFICES

CORPORATE OFFICES

5020 Ash Grove Dr
Springfield, Illinois 62711 USA
(800) 637-8606 or
(+1) 217-529-6601

INTERNATIONAL OFFICE

5020 Ash Grove Dr
Springfield, Illinois 62711 USA
(+1) 217-529-6601
international@bunn.com

UNITED KINGDOM OFFICE

Unit 24
Monkspath Business Park
Highlands Road
Shirley, Solihull
West Midlands
B90 4NZ
United Kingdom
+44 (0) 121 745 8104

GERMANY Showroom

Niemetzstrasse 47-49
Berlin, Berlin 12055
Germany

SALES | SERVICE | SUPPORT CONTACTS

EUROPE, MIDDLE EAST, AFRICA & INDIA

Lina Chiodo

SVP International Sales

Office: (+1) 416-233-1200
UK office: +44 (0) 121 745 8104
Mobile: (+1) 647-998-4809
lina.chiodo@bunn.com

Louise Felton

Director of Sales

EMEA and India
UK office: +44 (0) 121 745 8104
Mobile: +44 7879 944537
louise.felton@bunn.com

Ed Gooding

Regional Sales Manager

Middle East, India, and Africa
UK office: +44 (0) 121 745 8104
Mobile: +44 (0) 778 751 0062
ed.gooding@bunn.com

Paul Whitehead

Regional Sales Manager

UK and Ireland
Office: +44 (0) 121 745 8104
Mobile: +44 (0) 753 408 8339
paul.whitehead@bunn.com

Keith Collins

Director Technical Services

Europe, Middle East, India
UK office: +44 (0) 121 745 8104
Mobile: +44 (0) 7792 052 386
keith.collins@bunn.com

Simon Green

Technical Manager

Europe, UK, Ireland
UK office: +44 (0) 121 745 8104
Mobile: +44 (0) 7988 135 147
simon.green@bunn.com

Ronnie Van Gelder

Technical Manager

Europe and Africa
Mobile: (+31) 624 965609
ronnie.vangelder@bunn.com

Best Result in the Cup™



CORPORATE HEADQUARTERS

5020 Ash Grove Drive, Springfield, IL USA 62711
(+1) 217-529-6601 • 800-637-8606



www.bunn.com